

RECORD OF LAND CORNER MONUMENTATION

SOUTH 1/4 CORNER SECTION 29, T. 8 S., R. 37 E., W.M.

ORIGINALLY ESTABLISHED BY: Lincoln E. Wilkes, U.S. Cadastral Engineer

GROUP NUMBER: 107

APPROVAL DATE: May 26, 1927

SUBSEQUENT SURVEYS: Corner maintenance activities performed September 4, 1985 by William L. Hanley, PLS #1639, as evidenced by the Certified Record of Land Corner Monumentation filed February 5, 1986, as Baker County Survey No. 8-37-79

19	20	20	21
30	29	29	28
30	29	29	28
31	32	32	33

ORIGINAL DESCRIPTION: Set an iron post, 3 ft. long, 1 in. dia., 27 ins. in the ground, for $\frac{1}{4}$ sec. cor., with brass cap marked (diagram shown) from which

- A white fir, 6 ins. dia., bears N. 56° E., 27 $\frac{1}{2}$ lks. dist., marked 1/4 S 29 BT.
- A white fir, 8 ins. dia., bears S. 62° E., 47 lks. dist., marked 1/4 S 32 BT.

HANLEY'S DESCRIPTION: A brass cap of record dimensions and markings as shown in the corner diagram.

- A white fir 15 ins dia bears N56°E, 27 $\frac{1}{2}$ lks dist with fully healed blaze.
- A white fir 15 ins dia bears S62 °E, 47 lks dist with fully healed blaze.
- Improved surrounding rock mound around recovered corner monument and set a 6 foot steel fence post alongside with a sign 54-9 attached.

EVIDENCE FOUND: Found 1" iron pipe projecting 9" above ground in a loose mound of stone. The brass cap had been sawn off and removed, presumably by souvenir hunters.

From which:

- ▶ A white fir snag, 18" dbh, bears N.56°E., 18.4 ft. The other BT was dead and down.

DESCRIPTION OF MONUMENTS AND ACCESSORIES SET AND METHODS USED:

I accept the position of the found pipe for the corner. I referenced the iron pipe, removed it, and in it's place set a standard USFS 2 $\frac{1}{2}$ " x 30" aluminum pipe with attached 3 $\frac{1}{4}$ " aluminum cap, 26" in the ground. Raised a 3 ft. diameter mound of stone around the monument to top of cap. Cap is marked as shown below.

From which, **I SCRIBE A NEW BEARING TREE:**

- ▶ A western larch, 17" dbh, bears S.23°E., 53.22 ft. marked 1/4 S32 in upper blaze, and BT in lower blaze.

Also from which, **I SET NEW REFERENCE POINTS:**

- ▶ A 5/8"x 24" iron pin, bears N.47°22'E., 11.80 ft., with attached 2" aluminum cap marked RP 1 2023 PLS 69454
- ▶ A 5/8"x 24" iron pin, bears S.47°36'W., 21.78 ft., with attached 2" aluminum cap marked RP 2 2023 PLS 69454
- ▶ A 5/8"x 24" iron pin, bears N.41°06'W., 24.03 ft., with attached 2" aluminum cap marked RP 3 2023 PLS 69454

CORNER MONUMENT MARKED:

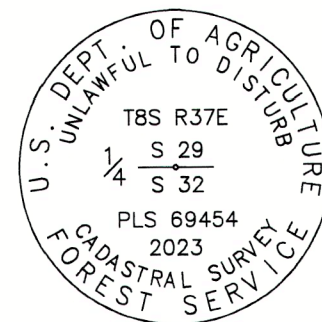

Placed a plastic-encased magnet beneath the base of the aluminum pipe. I discarded the old iron pipe. Painted a 6 inch red band around the bearing tree, painted the blazes red, and attached USFS 54-3 and 54-9 signs. Used RTK GPS to measure the reference points. Used a magnetic compass with 14° East declination to measure bearings to the bearing trees. Used an EDM device to measure the distance to new bearing tree, measuring to a 60d nail driven side-center-right at the root crown of the tree, with an attached 1 $\frac{1}{2}$ " aluminum washer stamped PLS 69454. Set an aluminum guard post North, with USFS 54-2 and 54-9 signs attached. See associated Map of Survey dated October 17, 2023 for more survey-related information. This corner is located on the east side of a dirt access road, on top of a cutbank.

RESTORATION BY, STAMP AND DATE:

Work performed July 6, 2023
Survey completed October 17, 2023

Jason L. Hatfield, PLS
Spencer B. Jones, Survey Tech

USDA FOREST SERVICE
NORTHEAST OREGON LAND ZONE
1550 Dewey Avenue, Suite A
Baker City, OR 97814
(541) 523-1283

FILED December 20, 2023
BAKER COUNTY SURVEYOR
SURVEY NO. 8-37-160

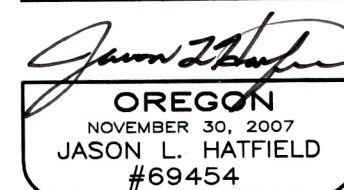

EXPIRES: 6/30/2025