

RECORD OF LAND CORNER MONUMENTATION

CENTER-WEST-EAST-SOUTHWEST 1/256 CORNER SECTION 29, T. 8 S., R. 37 E., W.M.

ORIGINALLY ESTABLISHED BY: CORNER NOT PREVIOUSLY ESTABLISHED

GROUP NUMBER: N/A

APPROVAL DATE: N/A

19	20			20	21
30	29			29	28
30	29			29	28
31	32			32	33

ORIGINAL DESCRIPTION: N/A

EVIDENCE FOUND: N/A

DESCRIPTION OF MONUMENTS AND ACCESSORIES SET AND METHODS USED:

At the corner point as determined by survey, I set a standard USFS 2 1/2" x 30" aluminum pipe with attached 3 1/4" aluminum cap, 26" in the ground. Raised a 2.5 ft. diameter mound of stone around the monument to top of cap. Cap is marked as shown below.

From which, I SCRIBE A NEW BEARING TREE:

- ▶ A lodgepole pine, 13" dbh, bears N.13°27'W., 34.81 ft. marked CWESW1/256 S29 in upper blaze, and BT in lower blaze.

Also from which, I SET A NEW REFERENCE POINT:

- ▶ A 5/8"x 24" iron pin, bears N.51°43'E., 9.64 ft., with attached 2" aluminum cap marked RP 1 2023 PLS 69454

CORNER MONUMENT MARKED:

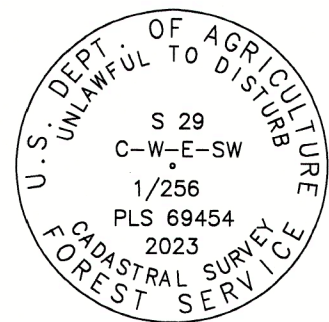

Placed a plastic-encased magnet beneath the base of the pipe. Painted a 6 inch red band around the bearing tree, painted the blazes red, and attached USFS 54-3 and 54-9 signs. Used a total station to measure bearings and distances to the accessories. Distance to the BT was measured to a 60d nail driven in the side-center-right at the root crown of the tree, with an attached 1 1/2" aluminum washer stamped PLS 69454. Set an aluminum guard post East, with USFS 54-2 and 54-9 signs attached, and another one South, with USFS 54-2 sign attached. See associated Map of Survey dated October 17, 2023 for survey-related information.

RESTORATION BY, STAMP AND DATE:

Work performed September 21, 2023
Survey completed October 17, 2023

Jason L. Hatfield, PLS
Daniel B. Lee, Survey Tech

USDA FOREST SERVICE
NORTHEAST OREGON LAND ZONE
1550 Dewey Avenue, Suite A
Baker City, OR 97814
(541) 523-1283



Jason L. Hatfield

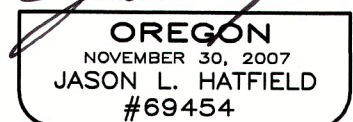

EXPIRES: 6/30/2025

FILED December 20, 2023

BAKER COUNTY SURVEYOR

SURVEY NO. 8-37-154