

# RECORD OF LAND CORNER MONUMENTATION

CENTER-WEST 1/16 CORNER SECTION 30, T. 8 S., R. 37 E., W.M.

**ORIGINALLY ESTABLISHED BY:** CORNER NOT PREVIOUSLY ESTABLISHED

**GROUP NUMBER:** N/A

**APPROVAL DATE:** N/A

19		19	20
30		30	29
	●		
30		30	29
31		31	32

**ORIGINAL DESCRIPTION:** N/A

**EVIDENCE FOUND:** N/A

**DESCRIPTION OF MONUMENTS AND ACCESSORIES SET AND METHODS USED:**

At the corner point as determined by survey, I set a standard USFS 2 1/2" x 30" aluminum pipe with attached 3 1/4" aluminum cap, 22" in the ground. Raised a 3 ft. diameter mound of stone around the monument to top of cap. Cap is marked as shown below.

From which, **I SCRIBE NEW BEARING TREES:**

- ▶ A white fir, 17" dbh, bears S.50°E., 18.27 ft. marked CW1/16 S30 in upper blaze, and BT in lower blaze.
- ▶ A lodgepole pine, 21" dbh, bears N. 24°W., 32.52 ft. marked CW1/16 S30 in upper blaze, and BT in lower blaze.

CORNER MONUMENT MARKED:

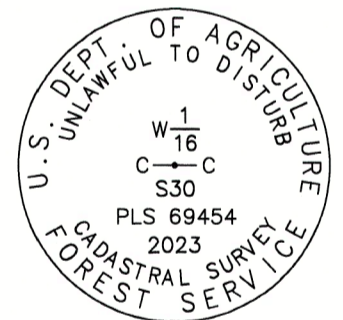

Placed a plastic-encased magnet beneath the base of the pipe. Painted a 6 inch red band around each bearing tree, and also painted the blazes red. Attached USFS 54-3 and 54-9 signs to BT's. Used a magnetic compass with 14° East declination to measure bearings to accessories. Used an EDM device to measure distances to new bearing trees, measuring to a 60d nail driven in the side-center-right at the root crown of each tree, with an attached 1 1/2" aluminum washer stamped PLS 69454. Set an aluminum guard post North, with USFS 54-2 and 54-9 signs attached, and another one South, with USFS 54-2 sign attached. See associated Map of Survey dated October 17, 2023 for survey-related information.

**RESTORATION BY, STAMP AND DATE:**

Work performed August 29, 2023  
Survey completed October 17, 2023

Jason L. Hatfield, PLS  
Daniel B. Lee, Survey Tech  
Toribio J. Quinones, LSIT

USDA FOREST SERVICE  
NORTHEAST OREGON LAND ZONE  
1550 Dewey Avenue, Suite A  
Baker City, OR 97814  
(541) 523-1283

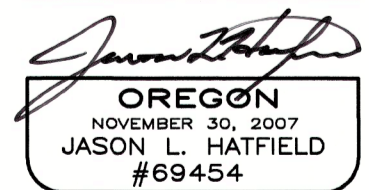

EXPIRES: 6/30/2025

FILED December 20, 2023  
BAKER COUNTY SURVEYOR  
SURVEY NO. 8-37-146