

# RECORD OF LAND CORNER MONUMENTATION

SOUTHWEST END CENTER OF COLUMBIA NO. 2, MS 593,  
SITUATED IN SECTION 32, T. 8 S., R. 37 E., W.M.

**ORIGINALLY ESTABLISHED BY:** Charles M. Foster, U.S. Deputy Mineral Surveyor

**MINERAL SURVEY NUMBER:** 593

**COMPLETION DATE:** September 6, 1904

**SUBSEQUENT SURVEYS:**

- ▶ Unrecorded remonumentation by John R. Mitchell, an unlicensed Survey Technician, as documented on U.S Forest Service corner card dated 6/10/1981

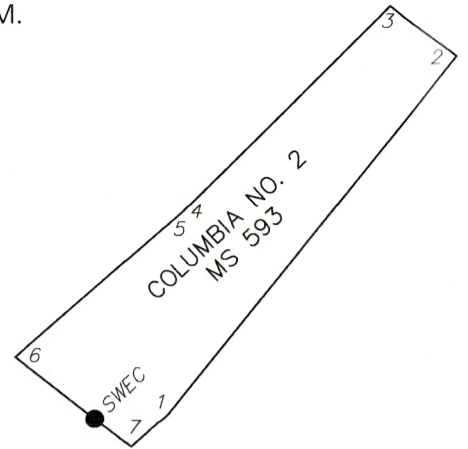

**ORIGINAL DESCRIPTION:** A tamarack post 4ft long 5 ins square, set 18 ins in the ground, surrounded with a mound of earth & scribed S.W. end cor MS 593 Col-No. 2.

**MITCHELL'S DESCRIPTION:** *DESCRIBE CORNER MONUMENT FOUND:* Rotted post in md of stone & earth.  
*MONUMENT: DESCRIBE NEW MONUMENT SET, OR WORK DONE TO PRESERVE EXISTING MONUMENT:* 2½" BC on 1"x32" gal. pipe set 23" deep in original hole & md of stone marked COL 2 WEC MS 593 JRM 1981  
*ACCESSORIES: DESCRIBE NEW BT's WITNESS OBJECTS ETC. ESTABLISHED, OR WORK DONE TO PRESERVE EXISTING EVIDENCE:* 10" WF brs. S58°W 15' marked WEC CO2 MS 593 BT.

**EVIDENCE FOUND:** Found Mitchell's unrecorded monument, which is a 1" galvanized iron pipe with a 2½" brass cap, marked as shown in diagram, projecting 8" above ground in a 2ft diam, collar of stone.

- ▶ A white fir, 17" dbh, bears S.56°W., 15.2 ft., with healed blaze in good condition.

**DESCRIPTION OF MONUMENTS AND ACCESSORIES SET AND METHODS USED:**

I accept the brass capped monument as the best available evidence of the original corner.

From which, **I SCRIBE A NEW BEARING TREE:**

- ▶ A white fir, 10" dbh, bears S.62°E., 10.6 ft., scribed X in upper blaze and BT in lower blaze.

**CORNER MONUMENT MARKED:**

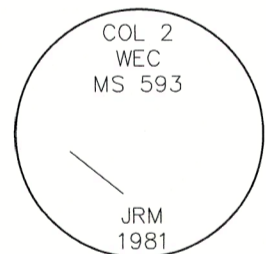

Painted a 6 inch red band around each bearing tree, and also painted blazes red and attached USFS 54-3 and 54-9 signs. Bearings were measured with a handheld compass with a 14° East declination. Distance to bearing trees was measured with a steel tape. The new BT was measured to a 60d nail driven in the right-side-center above the root crown with a 1½" aluminum washer stamped PLS 91693.

**RESTORATION BY, STAMP AND DATE:**

Work Performed October 2, 2023 by:

Vincent L. Kelly  
Spencer B. Jones

USDA FOREST SERVICE  
NORTHEAST OREGON LAND ZONE  
1550 Dewey Avenue, Suite A  
Baker City, OR 97814  
(541) 523-1281

FILED August 7, 2024  
BAKER COUNTY SURVEYOR  
SURVEY NO. 8-37-189

REGISTERED  
PROFESSIONAL  
LAND SURVEYOR

OREGON  
SEPTEMBER 11, 2018  
ROBERT C. MOYERS  
#91693

RENEWS: 12/31/2024