

CERTIFIED RECORD OF LAND CORNER MONUMENTATION

Description of corner evidence found:

A 2 1/2 inch aluminum pipe with a 2 1/2 inch aluminum cap, marked as shown. Firmly set, flush with ground.

From which:

An 18 inch pine snag (by Hagel) scribed "QCLC2 427 BT", dead and down, bears S78°E, 11.7 feet to stump hole.

A 42 inch spruce (by Hagel) with healed blaze, bears S34 1/2°E, 9.8 feet, alive and healthy.

A 17 western larch snag (by Wells) dead and down with visible scribing, bears S63 1/2°W, 45.0 feet to stump hole.

A 29 inch western larch (by Wells) with healed blaze, bears N58°W, 49.9 feet, alive and healthy.

A steel T-post bears N56°E, 10.0 feet; with sign: Property Boundary

A steel T-post bears S42°W, 5.0 feet; with two (2) signs: Property Boundary, Land Survey Monument.

Monument falls East 205 feet of the 075 Road.

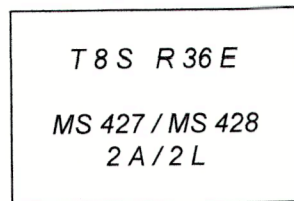

Luxemburg Cor. 2

Alta Cor. 2

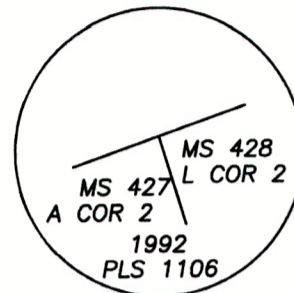

Description of monument and accessories I established to perpetuate original location of this corner:

New Bearing Tree:

A 7 inch white fir scribed "X BT" on single blaze, bears N53°E, 48.1 feet; measured to a 3/4 inch brass washer mkd: "LS 91201", at the right side of tree center.

Added Bearing Tree and Land Survey Monument signs as needed.

NAD 83 Geodetic Position

Lat. 44°49'16.6" N
Long. 118°15'29.3" W

Established by: Garmin ETREX 32x

I hereby certify that the corner is monumented and accessories taken as described using a steel tape and a Warren Knight staff compass, set with a declination of 14° East.

Witnesses: David Quittschreiber, Justin Seal, Shar Hutchison

August 9, 2023

REGISTERED
PROFESSIONAL
LAND SURVEYOR

Kristina Powell

OREGON
MAY 9, 2017
KRISTINA POWELL
91201

EXPIRES 12-31-24

FILED January 3, 2024
BAKER COUNTY SURVEYOR
SURVEY NO. 8-36-99