

# RECORD OF LAND CORNER MONUMENTATION

WEST 1/4 CORNER SECTION 30, T. 8 S., R. 37 E., W.M.

**ORIGINALLY ESTABLISHED BY:** Lincoln E. Wilkes, U.S. Cadastral Engineer

**GROUP NUMBER:** 107

**APPROVAL DATE:** May 26, 1927

**SUBSEQUENT SURVEYS:** Corner maintenance activities performed October 4, 1984 by William L. Hanley, PLS #1639, as evidenced by the Certified Record of Land Corner Monumentation filed June 11, 1985, as Baker County Survey No. 8-37-4

19		19	20
30		30	29
30		30	29
31		31	32

**ORIGINAL DESCRIPTION:** Set an iron post, 3 ft. long, 1 in. dia., 27 ins. in the ground, for 1/4 sec. cor. of sec. 30 only, with brass cap marked (diagram shown) from which  
 A balsam, 8 ins. dia., bears N. 37 1/2° E., 90 lks. dist., marked 1/4 S 30 BT.  
 A balsam, 6 ins. dia., bears S. 85° E., 50 lks. dist., marked 1/4 S 30 BT.

**HANLEY'S DESCRIPTION:** Brass cap found as per official record and marked as shown in diagram.  
 A fir 12 ins. diam., bears S 85° E., 50 lks. dist., with healed blaze.  
 No trace of other bearing tree.  
 Improved surrounding rock mound around corner monument and set a 6 foot steel fence post alongside with a sign 54-9 attached.  
 New bearing tree:  
 A pine 12 ins. diam. bears N 63° E 17.4 ft. marked 1/4 S30 BT, with a brass washer marked PLS 1639 nailed flush with BT blaze.

**EVIDENCE FOUND:** Found 1" iron pipe with 2 1/2" brass cap, marked as shown below, firmly set and projecting 1" above ground in a 2.5 ft. diameter mound of stone, with a steel fence post with attached USFS 54-9 sign set westerly, 4 ft. from the found monument.

From which:

- ▶ A lodgepole pine, 15" dbh, bears N.61°E., 17.4 ft., with visible scribing in a partially healed double blaze (Hanley BT). All other bearing trees are dead and down.

**DESCRIPTION OF MONUMENTS AND ACCESSORIES SET AND METHODS USED:**

I accept the position of the found monument for the corner.

From which, **I SCRIBE A NEW BEARING TREE:**

- ▶ An Engelmann spruce, 13" dbh, bears N.18 1/2°E., 32.95 ft. marked 1/4S30 in upper blaze, and BT in lower blaze.

Also from which, **I SET NEW REFERENCE POINTS:**

- ▶ A 5/8"x 24" iron pin, bears S.39°W., 9.56 ft., with attached 2" aluminum cap marked RP 1 2023 PLS 69454
- ▶ A 5/8"x 24" iron pin, bears N.25°W., 21.28 ft., with attached 2" aluminum cap marked RP 2 2023 PLS 69454

CORNER MONUMENT MARKED:

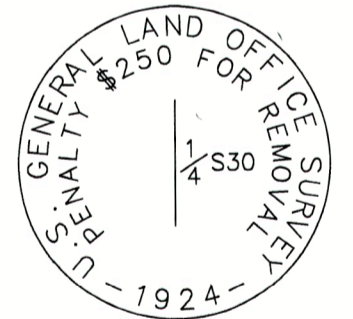

Painted a 6 inch red band around each bearing tree, and also painted the blazes red. Attached USFS 54-3 and 54-9 signs to BT's. Used a staff compass with 14° East declination to measure bearings to accessories. Used an EDM device to measure distances to accessories. Distances to BT's were measured to a 60d nail driven in the side-center at the root crown of the tree, with an attached 1 1/2" aluminum washer stamped PLS 69454. See associated Map of Survey dated October 17, 2023 for more information.

**RESTORATION BY, STAMP AND DATE:**

Work Performed June 13, 2023  
 Survey completed October 17, 2023

Jason L. Hatfield, PLS  
 Daniel B. Lee

USDA FOREST SERVICE  
 NORTHEAST OREGON LAND ZONE  
 1550 Dewey Avenue, Suite A  
 Baker City, OR 97814  
 (541) 523-1283

FILED December 20, 2023  
 BAKER COUNTY SURVEYOR  
 SURVEY NO. 8-36-95  
8-37-140

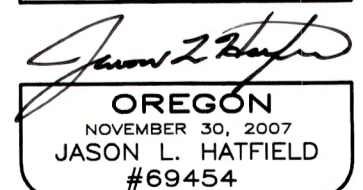

EXPIRES: 6/30/2025