

CERTIFIED RECORD OF LAND CORNER MONUMENTATION

History of original corner establishment:

Ira L. Hoffman, U.S. Deputy Mineral Surveyor, under Mineral Survey No. 800 surveyed the Richard Woods claim known as the Morning Star Lode from October 11, 1917 to September 19, 1918 and approved by the U.S. Surveyor General's Office 19 November, 1918. Otis O. Gould, U.S. Deputy Surveyor did a dependant resurvey under special instructions dated 27 Nov. 1935, and approved 17 August, 1939.

T 8 S R 36 E
MS 800
3 MS

Morning Star
Cor. 3

Surveyor General's record states:

Set an iron post, 3 ft. long, 1 in. diam., 27 in. in the ground, for Cor. No. 3, Morning Star lode, with brass cap marked:

from which

A tamarack 8 ins. diam. bears N39-30W, 7 lks. dist., marks grown over. (Old B.T.)

A tamarack 10 ins. diam., bears S72-30W, 13 lks. dist., marks grown over. (Old B.T.)

Corner was perpetuated by: Edwin A. Stryker per Corner Record 8-36-56, dated 11-16-1990.

MONUMENT FOUND:

I found a 2.5" dia. brass cap on a 1.0" dia. iron pipe 7.5" exposed in a loose mound of stone. The cap was marked.

ASSESSORIES FOUND:

8" dia. Western Larch bears N39-30W, 4.7 ft., with healed blaze. dead and down Western Larch with visible blaze and scribing.

CORNER WORK DONE ON 6/8/90

Restacked the stone mound and added stones to the top of monument.

NEW ACCESSORIES ESTABLISHED

A Western Larch, 8" dia., bears S34W, 4.8 ft., scribed COR3MS800 BT

A Douglas fir, 12" dia., bears N35E, 5.7 ft., scribed COR3MS800 BT

Painted the blaze red on each BT

Painted a 6" wide red band around each BT

Placed brass washer marked "PLS 2060" at base of each blaze

Placed metal sign with bearing and distance information on each BT (54-3)

Placed metal ATTENTION sign on each BT (54-4)

Placed 6 ft. steel fence post at corner with metal PROPERTY BOUNDARY sign and metal ATTENTION sign (54-2 and 54-4) attached

I measured to the centerline of each bearing tree using a tape and hand compass with declination set at 20 degrees east.

Continued on page 2 of 2

REGISTERED
PROFESSIONAL
LAND SURVEYOR

Kristina Powell

OREGON
MAY 9, 2017
KRISTINA POWELL
91201

EXPIRES 12-31-24

FILED January 3, 2024

BAKER COUNTY SURVEYOR

SURVEY NO. 8-36-103

CERTIFIED RECORD OF LAND CORNER MONUMENTATION

Description of corner evidence found:

A 1 inch galvanized iron pipe with 2 1/2 inch brass cap, marked as shown. Firmly set 4 inches above ground, with a rock collar.

BT's (by Gould) not found

A 14 inch Douglas fir (by Stryker) with healed blaze, bears N35°E, 5.7 feet.

An 8 inch western larch snag (by Stryker) with healed blaze, and 3/4 inch brass tag in face, bears N34°W, 4.8 feet.

A steel fence post bears N64W, 5.0 feet; with sign: Property Boundary

A steel fence post bears S24 1/2°W, 5.0 feet; with two (2) signs: Property Boundary, Land Survey Monument.

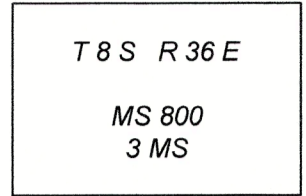

Morning Star
Cor. 3

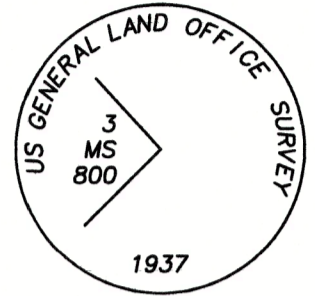

Description of monument and accessories I established to perpetuate original location of this corner:

New Bearing Tree:

An 8 inch Douglas fir scribed "X BT" on single blaze, bears N66°W, 33.3 feet; measured to a 3/4 inch brass washer mkd: "LS 91201", at the right-side of tree center.

Added Bearing Tree and Land Survey Monument signs as needed.

NAD 83 Geodetic Position

Lat. 44°49'11.4" N
Long. 118°14'54.8" W

Established by: Garmin ETREX 32x

I hereby certify that the corner is monumented and accessories taken as described using a steel tape and a Warren Knight staff compass, set with a declination of 14° East.

Witnesses: David Quittschreiber, Justin Seal, Shar Hutchison

August 10, 2023

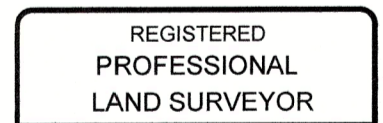

Kristina Powell

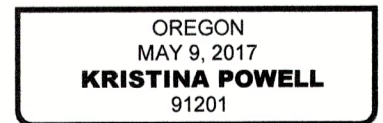

EXPIRES 12-31-24

FILED January 3, 2024

BAKER COUNTY SURVEYOR

SURVEY NO. 8-36-103