

RECORD OF LAND CORNER MONUMENTATION

CORNER: NE Cor. Sec. 35, T.7S., R.47E., W.M.

ORIGINAL SURVEY BY: Williard B. Blakeslee

CONTRACT NUMBER: 707

CONTRACT DATE: April 24, 1899

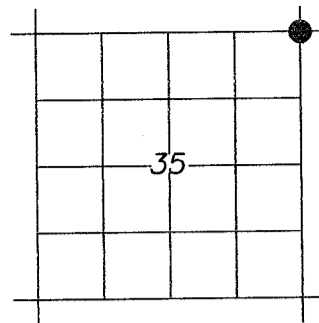

ORIGINAL G.L.O. DESCRIPTION:

Set Basalt stone 24x10x6 ins, 12 ins. in the ground for cor. to secs 25-26-35 & 36 marked with 1 notch on the S. and E. edges. raised mound of stone 3 ft. base 22 ins., high 10 lks., W. of the cor.

EVIDENCE FOUND:

Found mound of stone with remains of old fenceline running E-W 10' South of mound of stone. After a diligent search, we were unable to locate the original stone monument. I accept the center of the mound of stones as the best available evidence of the original GLO position for this corner.

DESCRIPTION OF MONUMENT AND ACCESSORIES SET:

Set 5/8" x 30" pin, 25" in the ground, with 2 1/2" aluminum cap marked as shown below. Built 3' mound of stone around corner.

FROM WHICH, I set the following reference points:

A 5/8" x 24" iron pin bears N.07°26'E., 10.96 ft., with attached yellow plastic cap marked BENCHMARK SURVEYING.

A 5/8" x 24" iron pin bears S.37°13'E., 6.81 ft., with attached yellow plastic cap marked BENCHMARK SURVEYING.

A 5/8" x 24" iron pin bears S.51°34'W., 10.70 ft., with attached yellow plastic cap marked BENCHMARK SURVEYING.

A 5/8" x 24" iron pin bears N.39°17'W., 9.39 ft., with attached yellow plastic cap marked BENCHMARK SURVEYING.

Used RTK GPS to measure RP's. Bearings to RP's are based on Geodetic North from a GPS observation taken at the W 1/4 Cor. Section 35.

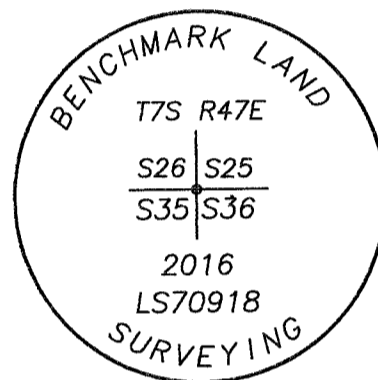

RESTORATION BY:

Michael C. Springer, PLS
Marcus Teague, Technician
Benchmark Land Surveying
217 N. Canyon Blvd.
John Day, OR, 97845

Surveyed August 24, 2016
September 8, 2016

FILED Oct. 15, 2016
BAKER COUNTY SURVEYOR
SURVEY NO. 7-47-65

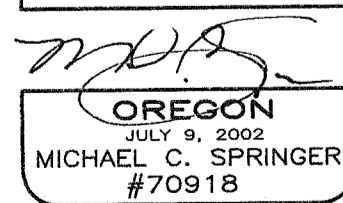
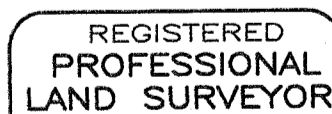

EXPIRES: 6/30/2018