

RECORD OF LAND CORNER MONUMENTATION

CORNER: N $\frac{1}{4}$ Cor. Sec. 35, T.7S., R.47E., W.M.

ORIGINAL SURVEY BY: Williard B. Blakeslee

CONTRACT NUMBER: 707

CONTRACT DATE: April 24, 1899

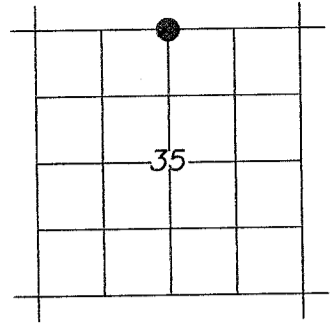

ORIGINAL G.L.O. DESCRIPTION: Set a basalt stone 18x10x8 ins 10 ins in the gro., for the $\frac{1}{4}$ sec. cor. marked $\frac{1}{4}$ S. on the N. face and raised a mound of stone 3 ft. base 24 ins., high 10 lks N. of the cor.

EVIDENCE FOUND: Found stone 17"x10"x7" marked $\frac{1}{4}$ with a backwards S. Area devoid mound of stone or accompanying stones.

DESCRIPTION OF MONUMENT AND ACCESSORIES SET:

Set 5/8" x 24" pin with 2" aluminum cap 24" in the ground, marked as shown below. Buried marked stone inverted North and alongside pin in a 3 ft. mound of stone.

FROM WHICH, I set the following reference points:

A 5/8" x 24" iron pin bears N.29°30'E., 9.33 ft., with attached yellow plastic cap marked BENCHMARK SURVEYING.

A 5/8" x 24" iron pin bears S.58°25'E., 10.18 ft., with attached yellow plastic cap marked BENCHMARK SURVEYING.

A 5/8" x 24" iron pin bears S.41°45'W., 6.91 ft., with attached yellow plastic cap marked BENCHMARK SURVEYING.

A 5/8" x 24" iron pin bears N.75°41'W., 9.10 ft., with attached yellow plastic cap marked BENCHMARK SURVEYING.

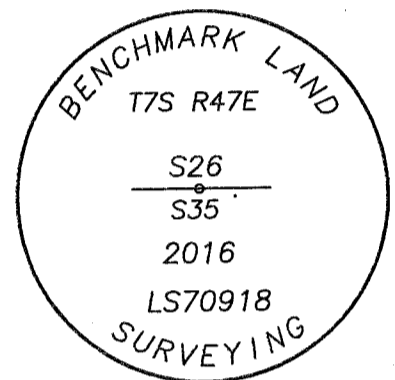

Used RTK GPS to measure RP's. Bearings to RP's are based on Geodetic North from a GPS observation taken at the W $\frac{1}{4}$ Cor. Section 35.

RESTORATION BY:

Michael C. Springer, PLS
Marcus Teague, Technician
Benchmark Land Surveying
217 N. Canyon Blvd.
John Day, OR, 97845

Surveyed August 16, 2016
August 25, 2016

REGISTERED
PROFESSIONAL
LAND SURVEYOR

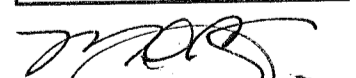
OREGON
JULY 9, 2002
MICHAEL C. SPRINGER
#70918

EXPIRES: 6/30/2018

FILED Oct. 15, 2016

BAKER COUNTY SURVEYOR

SURVEY NO. 7-47-64