

CERTIFIED RECORD OF LAND CORNER MONUMENTATION

Index File No. R-4

History of original corner establishment:

Not Set

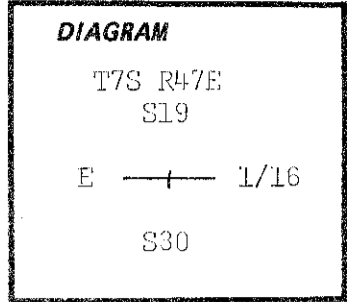

Description of corner evidence found:

None

Description of monument and accessories established to perpetuate the original location of this corner:

At the center of surveyed point, set 2 1/2" x 30" galvanized pipe and brass cap marked: Set pipe 18" in the ground and mound of stone around to cap.
 No trees. Built mound of stone 5' west of the corner.
 Placed 54-2 and 54-9 on a steel fence post 5' east and placed 54-2 on a steel fence post 5' north of the corner.

T7S R47E
S19

E ——— 1/16

S30
OR PLS 1051
1981

I hereby certify that the above corner monument was established as herein described.

Witnesses: Douglas Moser

April 22, 1981

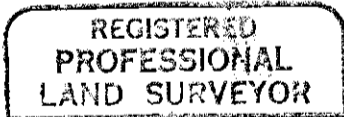

Barry B. Barbour

OREGON
OCT. 17, 1975
BARRY B. BARBOUR
1051

Office of.....County.....Surveyor..... County of.....Baker.....
 State of.....Oregon....., I hereby certify that the within instrument was filed in this office
 for record on the..... day of....., 1981
 by*Thomas J. Stanley*.....
 (COUNTY OFFICIAL) (DEPUTY)

FILED July 27, 1981
 BAKER COUNTY SURVEYOR
 SURVEY NO. 7-47-41