

CERTIFIED RECORD OF LAND CORNER MONUMENTATION

Index File No. P-13

History of original corner establishment:

Corner was originally established under G. L. O. contract Number 707, by Williard B. Blakeslee on June 11, 1901. Surveyor General's notes state: "Falls on solid rock in place 30x24x24 ins., above grnd. I cut a cross (+) at the exact point and marked 1/4S on the W. face for 1/4 sec. cor. from which a pine tree 32 ins. in diam., brs, N 8°E, 32 lks. dist. marked 1/4S22 BT. and a pine 21 ins. in diam. brs. N 40°W., 33 lks. dist. marked 1/4S21 BT. (Pits Imp.)"

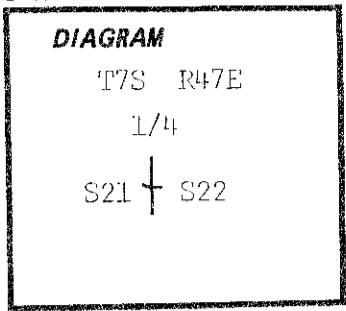

Description of corner evidence found:

Found solid rock, about 33ft. north of west bearing drain, dimly marked 1/4S on west face, from which a down and rotten pine bears N48°E, 23 ft. with possible parts of blazes. No scribing found. No trace of NE BT could be found. Removed 36" x 24" x 22" rock and marked center of stone.

Description of monument and accessories established to perpetuate the original location of this corner:

At the center of the above point, set 2 1/2" X 30" galvanized pipe and brass cap marked: Set Pipe 18" in the ground and mound of stone around to cap. Removed marked stone from area. From which by magnetic declination of N20°E:  
A 21" pine bears S89°E, 66.9 ft. scribed 1/4S22 BT. A 21" pine bears N50°W, 49.1 ft. scribed 1/4S21 BT.  
Painted blazes red and 6" red band around. Placed 54-39, 54-43, and brass washers stamped PLS 1051 on the BTs. Placed 54-2 and 54-4 on a steel fence post 5' north and placed 54-2 on a steel fence post 5' east of the corner.

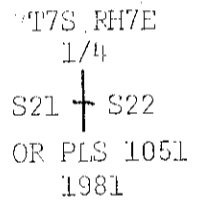

I hereby certify that the above corner monument was reestablished as herein described.

Witnesses: Daniel Rowland  
Douglas Moser

February 11, 1981

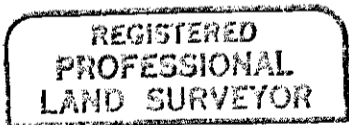

*Barry B. Barbour*

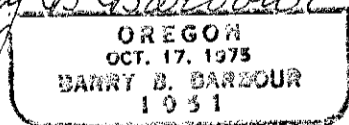

Office of.....County Surveyor..... County of.....Baker.....  
State of....., I hereby certify that the within instrument was filed in this office  
for record on the..... day of....., 1981  
..... by *Thomas J. Hamby*  
(COUNTY OFFICIAL) (DEPUTY)

FILED Jan 27, 1981  
BAKER COUNTY SURVEYOR  
SURVEY NO. 7-47-37