

CERTIFIED RECORD OF LAND CORNER MONUMENTATION

Index File No. P-5

History of original corner establishment:

Corner was originally established under GLO contract number 707, by Williard B. Blakeslee on August 3, 1901. Surveyor General's notes state: "Falls on solid basalt rock in place, 14 x 12 x 10 ins., above grnd. for 1/4 Sec. Cor. I cut a cross (+) at the exact cor. pt. and marked 1/4S on the W. face. From which a pine tree 36 ins. in diam. brs. N70°W., 50 lks. distant, marked 1/4 S19 BT. And a pine 20 ins. in diam. brs. S70°E, 75 lks. dist. marked 1/4 S20 BT."

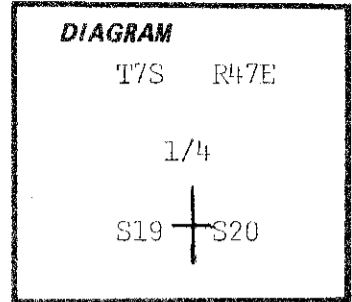

Description of corner evidence found:

Found no trace of record stone or northwest BT.
Found 48" pine, with partially opened blaze and visible scribing.
Measured N70°W. 49.5 ft. to flat area about 80 ft. north of Fish Creek.

Description of monument and accessories I established to perpetuate the original location of this corner:

At the center of the above point, set 2 1/2" x 30" galvanized pipe and brass cap marked as shown. Set pipe 2 1/2" in the ground and mound of stone around to cap.
From which by magnetic declination of N20°E:
An 11" pine bears S43°W., 28.8 ft., scribed 1/4 S19 BT. Painted blazes red and 6" red band around. Placed 54-3s, 54-4s, and brass washer stamped PLS 1051 on the BT. Placed 54-2 and 54-4 on a steel fence post 5' West and placed 54-2 on a steel fence post 5 ft. north of the corner.

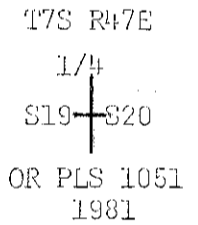

I hereby certify that the above corner monument was reestablished as herein described.

Witness: Douglas Moser

April 13, 1981

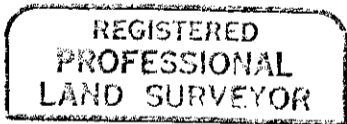

Barry B. Barbour

OREGON
OCT. 17, 1975
BARRY B. BARBOUR
1051

Office of..... County Surveyor..... County of..... Baker.....
State of..... Oregon....., I hereby certify that the within instrument was filed in this office
for record on the..... day of June....., 1981
..... by *Thomas J. [Signature]*.....
(COUNTY OFFICIAL) (DEPUTY)

FILED July 27, 1981
BAKER COUNTY SURVEYOR
SURVEY NO. 7-47-33