

CERTIFIED RECORD OF LAND CORNER MONUMENTATION

Index File No. G-9

History of original corner establishment:

Corner was originally established under G. L. O. contract number 707, by Williard B. Blakeslee on June 16, 1901. Surveyor General's notes state: "Set a granite stone 12 x 8 x 6 ins., 8 ins. in the grnd. for 1/4 sec. cor., marked 1/4S on the W. Face, raised a mound of stone 3 ft. base, 22 ins. high 10 lks. west of the corner."

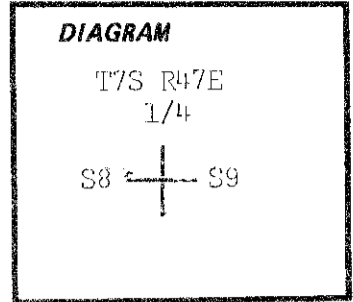

Description of corner evidence found:

Found set 12 x 10 x 8 inch stone, clearly marked 1/4S on west face. An old mound of stone 6 ft. west. Did not bother mound or rebuild it. Corner is 100' south of track road and 75' east of timber edge.

Description of monument and accessories I established to perpetuate the original location of this corner:

At the center of the above point, set 2 1/2" x 30" galvanized pipe and brass cap marked: Set pipe 24" in the ground and mound of stone around to cap. Buried marked stone alongside of the pipe. From which by magnetic declination of N20°E: A 18" Pine bears S31°E., 103.0 ft. scribed 1/4 S9 BT. A 20" Pine bears N75°W., 38.7 ft. scribed 1/4 S8 BT. Painted blazes red and 6" red band around. Placed 54-3s, 54-4s and brass washers stamped PLS 1051 on the BT's. Placed 54-4 on a steel fence post 5' south of the corner.

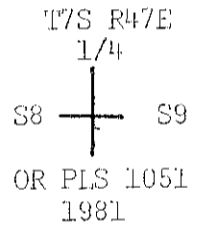

I hereby certify that the above corner monument was reestablished as herein described.

Witnesses: Daniel Rowland

April 23, 1981

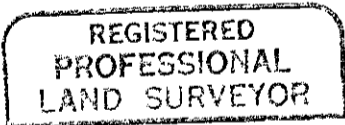

Barry B. Barbour
OREGON
OCT. 17, 1975
BARRY B. BARBOUR
1031

Office of.....County Surveyor..... County of.....Baker.....
State of.....Oregon....., I hereby certify that the within instrument was filed in this office
for record on the.....day of.....June....., 1981.
..... by*Thomas J. Stanley*.....
(COUNTY OFFICIAL) (DEPUTY)

FILED July 27, 1981
BAKER COUNTY SURVEYOR
SURVEY NO. 7-47-13