

CERTIFIED RECORD OF LAND CORNER MONUMENTATION

Index File No. A-21

History of original corner establishment:

Corner was originally established under G. L. O. contract number 707, by Williard B. Blakeslee on May 31, 1901. The corner was remonumented by James D. Hanley in 1964.

In 1981 I brought the corner to U. S. F. S. standards.

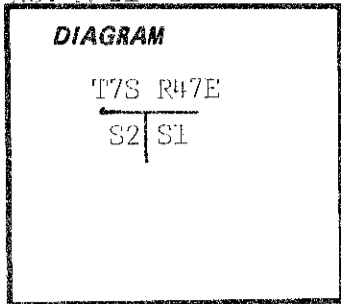

Description of corner evidence found:

Found aluminum pipe and cap marked: Found rock mound, 3 feet base, 2 feet high, 2.5 feet east of the corner. A 15" fir, bears S76°W, 2.5 ft. distance, marked S2 T7S R47E BT.

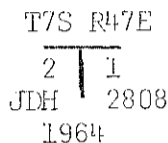

Description of monument and accessories established to perpetuate the original location of this corner:

From which by magnetic declination of N20°E: A 24" pine, bears S35°E, 23.5 ft. scribed T7S R47E S1 BT. Painted blazes red and 6" red band around. Placed 54-3s, 54-4s and brass washer stamped PLS 1051 on the new BT. Placed 54-4 on a steel fence post 5' east of the corner. Built mound of stone around to cap.

I hereby certify that the above corner monument was perpetuated as herein described.

Witnesses: David Cummins
Daniel Rowland
Douglas Moser

February 5, 1981

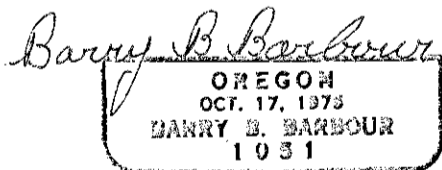
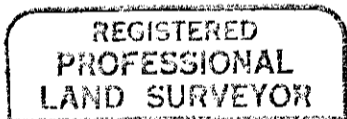

Office of.....County Surveyor..... County of.....Baker.....
 State of.....Oregon....., I hereby certify that the within instrument was filed in this office
 for record on the..... day of....., 1981
 by
 (COUNTY OFFICIAL) (DEPUTY)

FILED Jan 27, 1981
 BAKER COUNTY SURVEYOR
 SURVEY NO. 7-47-81