

RECORD OF LAND CORNER MONUMENTATION

EAST 1/4 CORNER OF SECTION 20, T. 7 S., R. 46 E., W.M.

ORIGINALLY ESTABLISHED BY: W. B. Barr, U.S. Deputy Surveyor

CONTRACT NUMBER: 443

CONTRACT DATE: May 29, 1882

SUBSEQUENT SURVEYS:

- ▶ Survey by Barry B. Barbour, PLS 1051, filed as Survey No. 7-46-95 and corner certificate filed as Survey No. 7-46-134, recorded January 25, 1982.

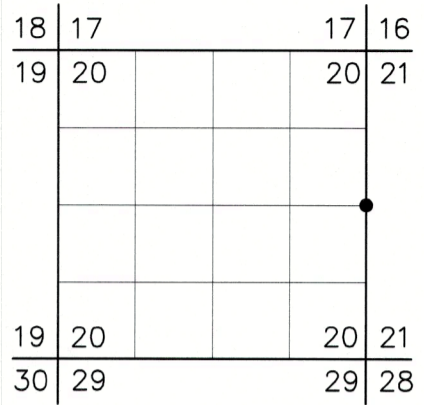

ORIGINAL DESCRIPTION:

Set basalt rock 14x10x5 ins, 10 inches in ground for 1/4 Sec corner marked 1/4 on the West side from which Tamarack 5in diam bears N81°W 40 lks dist marked 1/4 S.B.T.
Tamarack 6in diam bears East 16 lks dist marked 1/4 S.B.T.

BARBOUR'S DESCRIPTION:

Found no trace of record stone or BTs.
At surveyed point set 2 1/2" x 30" galvanized pipe and brass cap marked (diagram shown):
Set pipe 24" in the ground and mound of stone around to cap.
From which by magnetic declination of N20°E:
A 16" fir bears N57°E, 32.1 ft. scribed 1/4 S21 BT.
A 14" fir bears N71°W, 31.4 ft. scribed 1/4 S20 BT.
Painted blazes red and 6" red band around. Placed 54-3s, 54-4s, and brass washers stamped PLS 1051 on BTs. Placed 54-4 on a steel fence post 5' North of corner.

EVIDENCE FOUND:

Found a 2 1/2" galvanized iron pipe with a 2 1/2" brass cap marked as shown in amended monument diagram, projecting 5" above ground with a steel fence post northwest 3 ft with attached USFS 54-4 sign. Monument lies approximately 100 ft. south of Forest Service Road 6625270 and approximately 60 ft. north of an old logging road on a steep north facing slope.
From which bearing trees by Barbour:
A fir stump, bears N.57°E., 32.1 ft., rotten with visible scribing.
A fir, 24" dbh, bears N.71°W., 31.4 ft., with double healed blaze in good condition.

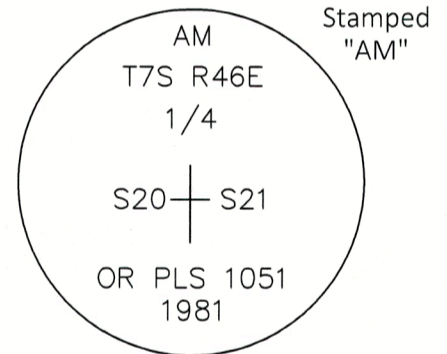

AMENDED MONUMENT DIAGRAM

Observations of the section corners to the north and south revealed that this monument was out of position, being 30.96 farther north. A searched was made for the original stone and bearing trees and no evidence was found. There are many stones of call size in the vicinity, but none were found with markings or planted in the ground. There were no tamarack trees found in the vicinity and the area is predominately covered by fir trees. The area appears to have been disturbed by logging activity.

DESCRIPTION OF MONUMENTS AND ACCESSORIES SET AND METHODS USED:

I accept the position of the found monument for line only.
At corner point as determined by survey, I set a standard USFS 2 1/2"x30" aluminum pipe with attached 3 1/4" aluminum cap, 22" in the ground in a 1 1/2 ft., diameter collar of stone. Cap is marked as shown in Corner Monument Diagram.

From which, **I SCRIBE NEW BEARING TREES:**

- ▶ A white fir, 21" dbh, bears S.74°E., 27.4 ft., scribed 1/4S21BT. Distance measured to 60d nail driven in the left-side-center at the root crown, with a 1 1/2" aluminum washer stamped PLS 91693.
- ▶ A white fir, 22" dbh, bears S.28°W., 22.3 ft., scribed 1/4S20BT. Distance measured to 60d nail driven in the right-side-center at the root crown, with a 1 1/2" aluminum washer stamped PLS 91693.

Also from which, **I SET NEW REFERENCE MONUMENTS:**

- ▶ A 5/8"x24" iron rod, bears N.51°E., 20.97 ft., with attached 2" aluminum cap marked RM 1 2023 PLS 91693.
- ▶ A 5/8"x24" iron rod, bears N.42°W., 12.93 ft., with attached 2" aluminum cap marked RM 2 2023 PLS 91693.

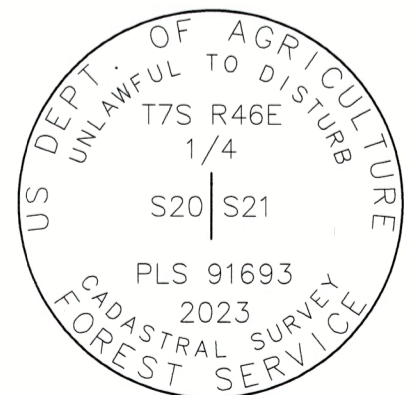

CORNER MONUMENT DIAGRAM

FILED January 24, 2024
BAKER COUNTY SURVEYOR
SURVEY NO. 7-46-168

RECORD OF LAND CORNER MONUMENTATION

EAST 1/4 CORNER OF SECTION 20, T. 7 S., R. 46 E., W.M.

Placed a plastic encased magnet beneath the base of the pipe. Painted a 6 inch red band around each bearing tree, and also painted blazes red and attached USFS 54-3 and 54-9 signs. A total station was used to measure new reference monuments. Distances to new bearing trees measured with handheld EDM. Used a handheld compass with 14° East declination to measure bearings to bearing trees. Added the letters AM to Barbour's monument as shown in the Amended Monument Diagram. See associated map of survey dated November 1, 2023.

RESTORATION BY, STAMP AND DATE:

Work Performed November 1, 2023 by:

Robert C. Moyers, PLS
T. DeJesus Quinones, LSIT
Vincent L. Kelly
Spencer B. Jones

USDA FOREST SERVICE
NORTHEAST OREGON LAND ZONE
1550 Dewey Avenue, Suite A
Baker City, OR 97814
(541) 523-1281

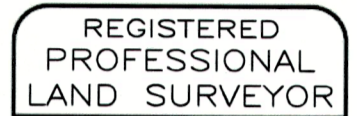

RCM

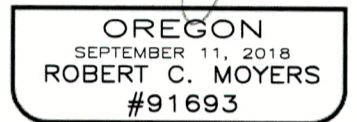

RENEWS: 12/31/2024

FILED January 24, 2024
BAKER COUNTY SURVEYOR
SURVEY NO. 7-46-168