

**CERTIFIED RECORD OF LAND CORNER MONUMENTATION**

Index File No. A-3

**History of original corner establishment:**

Corner was originally established under G.L.O. contract No. 443 by W. B. Barr, during July of 1882. Surveyors General's notes state: "Set basalt rock 14 x 9 x 5 ins. 9 inches in ground for 1/4 sec. corner. Marked 1/4 on the North side from which: a pine 38 in. diam. bears N37°W, 30 lks. dist. marked 1/4 S. BT. A pine 24 in. diam. bears S21°W, 40 lks. dist. marked 1/4 S. BT."

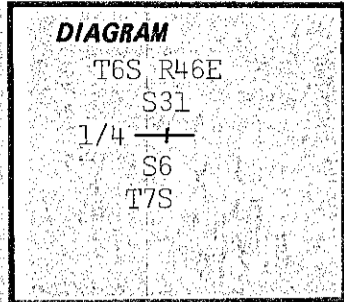

**Description of corner evidence found:**

Found no trace of record stone. Probably moved or covered by road construction. Found rotten pine stump 36" in diam. with visible scribing. Measured S37°E, 19.8 ft. From here stump hole bears S20°W, 26 ft. Tree was pushed down hill from here. No scribing left.

**Description of monument and accessories I established to perpetuate the original location of this corner:**

At measured point set 2 1/2" x 30" galvanized pipe and brass cap marked:  
 Set pipe 24" in the ground and mound of stone around to cap.  
 From which by magnetic declination of N20°E:  
 A 24" pine bears N80°E, 69.0 ft. scribed 1/4 S31 BT.  
 A 15" fir bears S33°W, 62.7 ft. scribed 1/4 S6 BT.  
 Painted blazes red and 6" red bands around. Placed 54-3s, 54-4s, and brass washers stamped PLS 1051 on BTs. Placed 54-4 on a steel fence post 5' West of the corner.

T6S R46E  
 S31  
 1/4 —+  
 S6  
 T7S  
 OR PLS 1051  
 1981

I hereby certify that the above corner monument was reestablished as herein described.

Witnesses: Daniel Rowland  
 Dave Poe

October 8, 1981

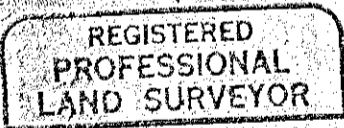

*Barry B. Barbour*  
 OREGON  
 OCT. 17, 1975  
 BARRY B. BARBOUR  
 1051

Office of.....County Surveyor..... County of.....Baker.....  
 State of...Oregon....., I hereby certify that the within instrument was filed in this office  
 for record on the...7<sup>th</sup> day of...January....., 19.82  
 .....County Surveyor..... by .....Tom Henley.....  
 (COUNTY OFFICIAL) (DEPUTY)

FILED Jan. 25, 1982  
 BAKER COUNTY SURVEYOR  
 SURVEY NO. 7-46-97