

CERTIFIED RECORD OF LAND CORNER MONUMENTATION

History of original corner establishment:

Corner established by W.B. Barr under GLO Contract No. 443 dated May 29, 1882.

Surveyor General's records state:

Set basalt rock 14 X 10 X 9 ins 10 ins in ground for corner to Sec 14, 15, 22, 23 marked with 2 notches on the East and 3 notches on the South edges, from which:

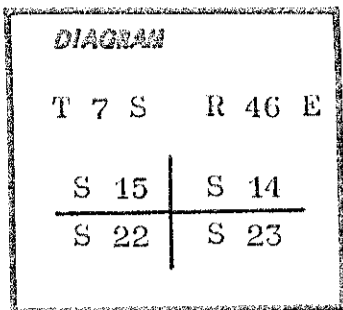

- A pine 06 ins diam bears N 63° E 96 lks dist mkd T 7 S R 46 E S 14 BT
- A pine 15 ins diam bears N 39° W 90 lks dist mkd T 7 S R 46 E S 15 BT
- A pine 30 ins diam bears S 68° W 77 lks dist mkd T 7 S R 46 E S 22 BT
- A pine 40 ins diam bears S 15° E 62 lks dist mkd T 7 S R 46 E S 23 BT

Description of corner evidence found:

- A sawed pine stump for Sec 23 BT - no visible scribes
- A sawed pine stump for Sec 22 BT - no visible scribes
- A sawed pine stump for Sec 15 BT - BT scribes visible

Found a 2½ inch aluminum cap on a 1 inch iron pipe marked

T 7 S	R 46 E
S 15	S 14
S 22	S 23

CS 1974

- A pine 08 ins diam bears N 51° W, 22.3 ft dist mkd SC S 14 BT
- A pine 12 ins diam bears N 71° E, 15.6 ft dist mkd SC S 15 BT
- A pine 10 ins diam bears S 47° E, 24.0 ft dist mkd SC S 23 BT
- A pine 08 ins diam bears S 42° W, 37.6 ft dist mkd SC S 22 BT

Description of monument and accessories established to perpetuate the original location of this corner:

Set a 6 ft steel fence post 5 ft North with a sign 54-4 attached and improved rock mound surrounding corner monument.

Attached a sign 54-3 to original BT stumps and attached a sign 54-3 below a band of red paint to each previously scribed bearing tree.

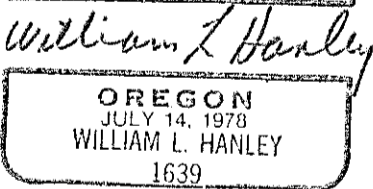
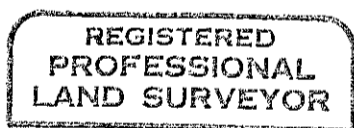

I hereby certify that the above monument was re-established as herein described on August 3, 1979 witnessed by Tracy Labaree and Jim DeMastus.

Office of..... County of.....  
 State of....., I hereby certify that the within instrument was filed in this office  
 for record on the..... day of....., 19.....  
 ..... by .....  
 (COUNTY OFFICIAL) (DEPUTY)