

RECORD OF LAND CORNER MONUMENTATION

WEST-EAST 1/64 CORNER BETWEEN SECTIONS 3 AND 10, T. 7 S., R. 45 E., W.M.

ORIGINALLY ESTABLISHED BY: James H. Hambleton, PLS 645 in 1976. See Map of Survey filed March 22, 1977 in the Baker County Surveyor's office as Survey No. 7-45-5, and corner monumentation record filed March 23, 1981 as Survey No. 7-45-72

SUBSEQUENT SURVEYS:

► Survey by Barry B. Barbour, PLS 1051 in 1982. See Map of Survey and corner monumentation record filed November 7, 1985 in the Baker County Surveyor's records as Survey No. 7-45-121 and 7-45-123, respectively

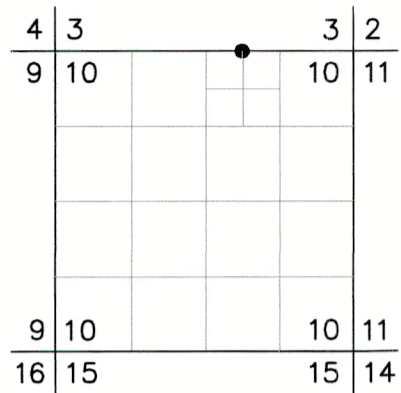

HAMBLETON'S DESCRIPTION: I set a brass cap on a 2" pipe 30" long and flared on the bottom. I stamped the cap as shown in the above diagram and buried the monument in a mound of stone. From which I set two bearing trees:
 A larch 22" in dia. which bears N 03 00 W, 9.60 feet and scribed 1/64 S 3 BT.
 A red fir 18" in dia. which bears S 32 00 E, 4.40 feet and scribed 1/64 S 10 BT.

BARBOUR'S DESCRIPTION: Corner was set in 1976 by James H. Hambleton. His measurement between the brass cap BLM corners was 2542.16. My measurement was 2603.48 feet. From the found monument, I measured N86°41'58"E, 16.33 ft. and set monument as described below.
 In 1982 a brass cap monument and two bearing trees were found. I was told in 1985, that these no longer exist. At surveyed point set 2 1/2" X 30" galvanized pipe and brass cap marked: (diagram shown)
 Set pipe 20" in the ground and mound of stone around to cap.
 From which by magnetic declination of N20°E:
 A 15" Fir bears N41°E, 52.7 ft. scribed WE 1/64 S3 BT.
 A 14" Fir bears S61°E, 21.1 ft. scribed WE 1/64 S10 BT.

EVIDENCE FOUND: Found Barbour's 2 1/2" galvanized iron pipe with 2 1/2" brass cap attached (marked as shown below), projecting 9" above ground in a 2 ft. mound of stone. I accept the found monument for the position of the corner.

From which, **THE BEARING TREES BY BARBOUR:**

- A white fir, 20" dbh, bears N.41°E., 52.7 ft., with healed double blaze
- A white fir, 19" dbh, bears S.61°E., 21.1 ft., with healed double blaze

Also from which, **HAMBLETON'S MONUMENT:**

- A 2 1/2" galvanized iron pipe with 2 1/2" brass cap attached, projecting 10" above ground in a 3 ft. mound of stone, bears S.87°W., 16.4 ft. from Barbour's monument.

I also found Hambleton's bearing trees. The northwest BT is a western larch stump (sawn) 18" high, and the southeast bearing tree is a Douglas-fir, 26" dbh with healed blaze.

CORNER MONUMENT MARKED:

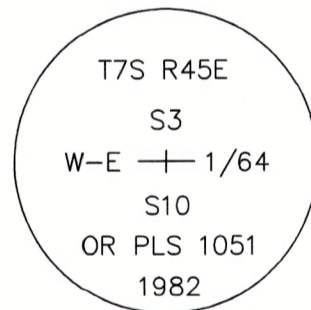

Painted a 6 inch red band around Barbour's bearing trees, and also painted blazes red. Used a magnetic compass with 14° East declination to measure bearings to BT's. Distances measured with a steel tape.

RESTORATION BY, STAMP AND DATE:

Work Performed October 11, 2022 by:

Jason L. Hatfield, PLS
 Doug H. Crawford

USDA FOREST SERVICE
 NORTHEAST OREGON LAND ZONE
 1550 Dewey Avenue, Suite A
 Baker City, OR 97814
 (541) 523-1283

FILED December 14, 2022
 BAKER COUNTY SURVEYOR
 SURVEY NO. 7-45-200

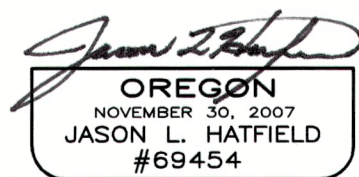
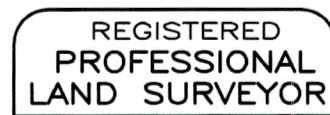

EXPIRES: 6/30/2023