

# CORNER RESTORATION

**CORNER:** C-W1/16 SEC. 25, TWP. 7 S., RANGE 45 E., W.M.

**ORIGINAL SURVEY BY:** CORNER NOT

**CONTRACT NUMBER:** PREVIOUSLY

**CONTRACT DATE:** ESTABLISHED

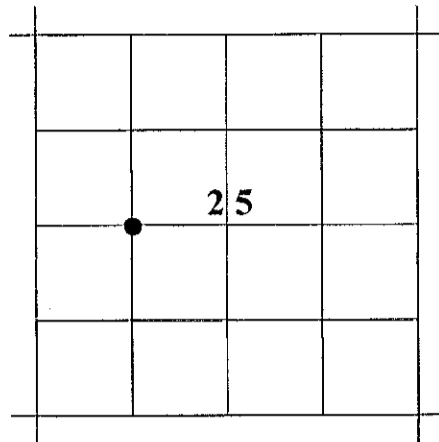

**ORIGINAL DESCRIPTION:** NONE

**RESTORATION BY, STAMP AND DATE:**

Jason L. Hatfield, PLS  
Michael C. Springer, PLS

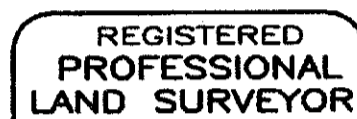

*Jason L. Hatfield*

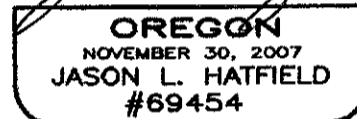

December 6, 2010

EXPIRES: 6/30/2011

See Record Map of Survey No. 7-45-161

**DESCRIPTION OF MONUMENTS AND ACCESSORIES SET AND METHODS USED:**

At the corner point as located by survey, set a 5/8"x30" iron pin, 32" in gravel road surface, with attached 2" diameter aluminum cap marked as shown.

**From which, I SET THE FOLLOWING REFERENCE POINTS:**

- ▶ A 5/8"x30" iron pin bears S89°57'04"E, 53.73 ft., with attached yellow plastic cap marked "BENCHMARK SURVEYING" set in the north shoulder of a gravel road.
- ▶ A 5/8"x30" iron pin bears N27°12'19"W, 85.40 ft., with attached yellow plastic cap marked "BENCHMARK SURVEYING" set in a north-south fence.

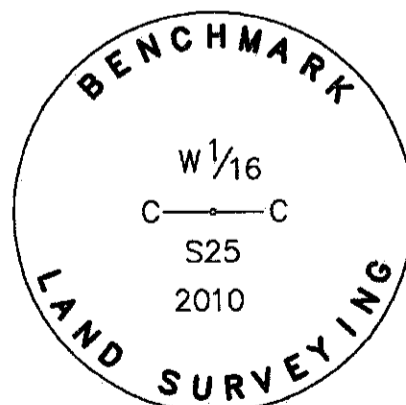

Used RTK GPS to measure the RP's. Bearings are based on Record Map of Survey No. 7-45-161.

FILED May 5, 2011

T-22

BAKER COUNTY SURVEYOR

SURVEY NO. 7-45-165