

CORNER RESTORATION

CORNER: NW1/16 SEC. 25, TWP. 7 S., RANGE 45 E., W.M.

ORIGINAL SURVEY BY: CORNER NOT

CONTRACT NUMBER: PREVIOUSLY

CONTRACT DATE: ESTABLISHED

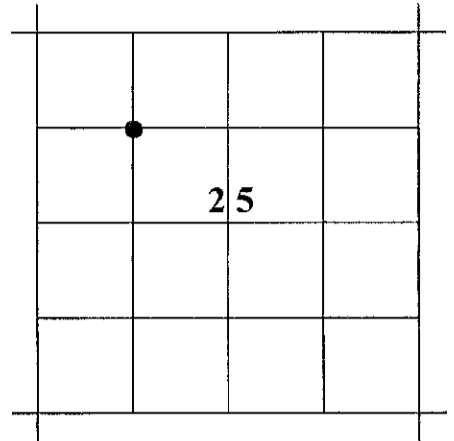

ORIGINAL DESCRIPTION: NONE

RESTORATION BY, STAMP AND DATE:

Jason L. Hatfield, PLS
Michael C. Springer, PLS

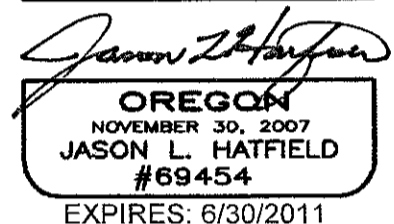
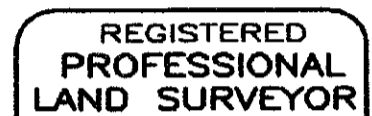

December 6, 2010

See Record Map of Survey No. 7-45-161

DESCRIPTION OF MONUMENTS AND ACCESSORIES SET AND METHODS USED:

At the corner point as located by survey, set a 5/8"x30" iron pin, 31" in gravel road surface, with attached 2" diameter aluminum cap marked as shown.

From which, I SET THE FOLLOWING REFERENCE POINTS:

- ▶ A 5/8"x30" iron pin bears S89°52'48"E, 29.91 ft., with attached yellow plastic cap marked "BENCHMARK SURVEYING" set in a north-south fence.
- ▶ A 5/8"x30" iron pin bears N89°52'48"W, 10.84 ft., with attached yellow plastic cap marked "BENCHMARK SURVEYING" set in a north-south fence.

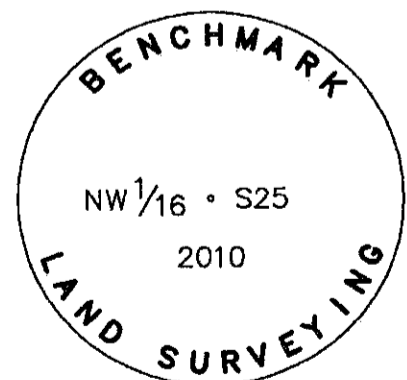

Used RTK GPS to measure the RP's. Bearings are based on Record Map of Survey No. 7-45-161.

FILED May 5, 2011
BAKER COUNTY SURVEYOR
SURVEY NO. 7-45-163