



**BASIS OF BEARINGS**

RECORD MAP OF SURVEY NO. 7-45-146  
AS SHOWN

**NARRATIVE**

THIS SURVEY WAS PERFORMED AT THE REQUEST OF LINDA WORKMAN. THE PURPOSE OF THIS SURVEY WAS TO LOCATE AND MONUMENT THE NE1/4NW1/4, SE1/4NW1/4 AND THE SW1/4NE1/4 SECTION 25, T.7S., R.45E., AS SHOWN. HEREON.

A SEARCH WAS MADE OF THE AVAILABLE RECORDS PERTAINING TO THIS SURVEY. FIELD MEASUREMENTS WERE MADE TO LOCATE APPURTENANT MONUMENTS SHOWN ON SURVEY NO.'S 7-45-75, 7-45-79A AND 7-45-155MP.

I ACCEPT THE POSITIONS OF THE FOUND CONTROLLING MONUMENTS FROM SAID SURVEYS WITH THE EXCEPTION OF ONE. AT THE CENTER QUARTER CORNER, WE FOUND THE IRON PIN SET DURING MAP OF SURVEY 7-45-155MP TO BE OUT OF POSITION. IT APPEARS TO HAVE BEEN DISPLACED BY A 6" DIAMETER WOODEN FENCE POST SET ALONGSIDE.

I SEARCHED FOR, BUT FOUND NO TRACE OF THE MONUMENT SET DURING RECORD MAP OF SURVEY NO. 7-45-155MP AT THE INTERSECTION OF THE NORTHEASTERLY RIGHT OF WAY LINE OF HOLBROOK CREEK COUNTY ROAD AND THE SOUTH LINE OF THE SE1/4NW1/4. I RESET SAID PIN IN ITS RECORD LOCATION, AS SHOWN.

THE SECTION WAS SUBDIVIDED USING THE METHODS OUTLINED IN THE 2009 BLM MANUAL OF INSTRUCTIONS. I SET MONUMENTS AT POSITIONS ACCORDING TO THE EVIDENCE FOUND, AND THE RECORD SURVEY DATA, AS SHOWN HEREON.

ALSO SEE CORNER RESTORATION SHEETS FILED SEPERATELY FOR THE 1/16TH CORNERS, WHICH DETAIL THE NEW MONUMENTS SET AND ACCESSORIES ESTABLISHED.

**LEGEND**

- FOUND 1" GALV. IRON PIPE WITH ATTACHED 2 1/2" COUNTY SURVEYOR BRASS CAP
- FOUND 2 1/2" GALV. IRON PIPE WITH ATTACHED BRASS CAP FROM SURVEY NO. 7-45-75
- FOUND 5/8" IRON PIN BELOW ROAD SURFACE WITH NO CAP SHOWN ON SURVEY NO. 7-46-79A
- FOUND 5/8" IRON PIN WITH ATTACHED YELLOW PLASTIC CAP MARKED "HANLEY ENGR. PLS 1817" FROM SURVEY NO. 7-45-155MP
- SET 5/8"x30" IRON PIN WITH ATTACHED 2" ALUMINUM CAP MARKED "BENCHMARK LAND SURVEYING", AND WITH APPROPRIATE 1/16 CORNER DESIGNATIONS - SEE CORNER RESTORATION SHEETS FILED SEPERATELY FOR DETAILS
- SET 5/8"x30" IRON PIN WITH ATTACHED YELLOW PLASTIC CAP MARKED "BENCHMARK SURVEYING"
- ( ) G.L.O. RECORD BEARING AND DISTANCE
- [ ] RECORD BEARING AND DISTANCE FROM SURVEY NO. 7-45-75
- [1] RECORD BEARING AND DISTANCE FROM SURVEY NO.'S 7-45-146 & 7-45-146MP
- [2] RECORD BEARING AND DISTANCE FROM SURVEY NO. 7-45-155MP
- X—X FENCE LINE

**REFERENCES**

RECORD MAP OF SURVEY NO.'S 7-45-75, 7-45-79A, 7-45-146MP, 7-45-155MP  
DEED RECORD INSTRUMENT NO.'S 86470459, 9134030, 9447102, 02410106, 06470459 & 08110256

REGISTERED PROFESSIONAL LAND SURVEYOR  
*Jason L. Hatfield*  
OREGON  
NOVEMBER 30, 2007  
JASON L. HATFIELD  
#69454  
EXPIRES: 6/30/2011

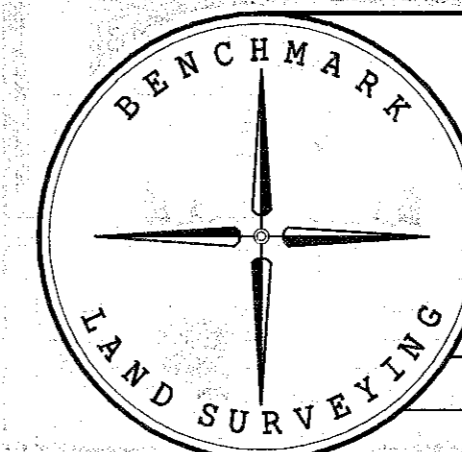

|   |               |                                |
|---|---------------|--------------------------------|
| BENCHMARK LAND SURVEYING<br>217 N. CANYON BLVD. JOHN DAY, OREGON<br>2101 MAIN STREET, STE 223 BAKER CITY, OREGON<br>541-575-1251 ~ 800-699-0516 |               |                                |
| MAP OF SURVEY<br>SUBDIVISION OF THE NE1/4 AND THE NW1/4<br>SECTION 25, T.7S., R.45E., W.M.,<br>BAKER COUNTY, OREGON                             |               |                                |
| SURVEYED FOR  | LINDA WORKMAN |                                |
| SURVEYED BY   | JLH & MCS     | DECEMBER 2010 TO<br>APRIL 2011 |
| Scale: 1"=400'  | Drawn by: JLH |                                |

FILED May 5, 2011  
BAKER COUNTY SURVEYOR  
SURVEY NO. 7-45-161

