

CERTIFIED RECORD OF LAND CORNER MONUMENTATION

History of original corner establishment:

Original corner was established by C.M. FOSTER IN December 1882 under instructions dated October, 23, 1882.

Set 4"x4" squared post marked E.M.W. No. 3-126

1982 Survey by Carl E. Sundet: (see Record Survey no. 7-44-37 and LCR no. 7-44-30)

Found remains of 4"x4" scribed post in mound of stone, Set 2-1/2" alum. pipe with 3-1/4" alum. cap in mound of stone:

From Which:

A Ponderosa Pine, 12" diam. bears S 64°E, 66.4 feet dist. mkd. EMW3 MS 126 BT
A Ponderoas Pine, 8" diam. bears N33°W, 21.3 feet dist. mkd. EMW3 MS 126 BT

index no. n/a

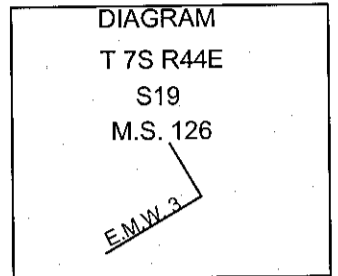

Description of corner evidence found:

Found 3-1/4" diameter alum. cap on 2-1/2" alum. pipe projecting 3" above ground in collar of stone. Alum. cap stamped as shown:

From Which:

A Ponderosa Pine, 16" diam. bears S 64°E, 66.4 feet dist. with partially open blaze
A Ponderoas Pine, 10" diam (dead & down) . with visible scribing

Corner is witnessed with 6' steel fence post 5' northerly and 5' easterly. Post have USFS boundary signs and survey monument signs attached.

Placed new bearing tree tag and brass washer stamped "G WAGNER" LS 02817 on face of BT blaze. Painted blazes red and 6" red band around tree above BT Tag on all bearing trees.

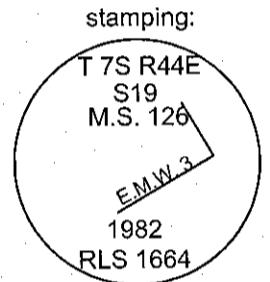

Description of monument and accessories I established to perpetuate the original location of this corner:

From Which: (by magnetic declination of 20°East)

New Bearing Tree:

A Ponderosa Pine, 14" diam. bears N 26°E, 12.0 feet dist. mkd. EMW3 MS126 BT

Placed new bearing tree tag and brass washer stamped "G WAGNER" LS 02817 on face of BT blaze. Painted blazes red and 6" red band around tree above BT Tag on all bearing trees.

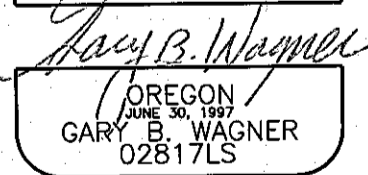
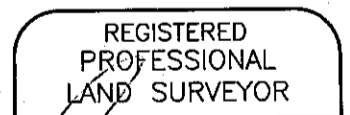

RENEWS 6/30/12

Office of County Surveyor, County of Baker

State of Oregon, I hereby certify that the within instrument was filed in this office for record on the _____ day of _____ 2010

FILED Oct. 4, 2010
BAKER COUNTY SURVEYOR
SURVEY NO. 7-44-262