

J-4

CERTIFIED RECORD OF LAND CORNER MONUMENTATION

History of original corner establishment:

Corner was originally established in 1982 by Barry B. Barbour, LS 1051, under contract for the Wallowa-Whitman National Forest as shown on Record Survey No. 7-44-73. Also see certified record of land corner no. (LCR) 7-44-94

index no. F-4

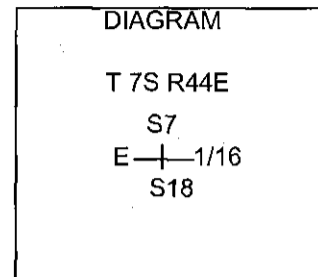

Description of corner evidence found:

Found 2-1/2" diameter brass cap on 2" iron post projecting 4" from ground. Corner falls in the center of a heavily used game trail. Corner is stamped as shown:

From Which:

A Douglas Fir, 15" diam. bears N 79°W, 34.2 feet dist. with healed over blaze.

A Douglas Fir, 16" diam. bears S 31°E, 11.3 feet dist. with healed over blaze. (see note below)

Note: Record bearing and dist. for southeast BT is S 39°E, 10.6 feet.

Corner is witnessed with 6' steel fence post 5' North and 5' East. Post have USFS boundary signs and survey monument signs attached.

Placed new bearing tree tag and brass washer stamped "G WAGNER" LS 02817 on face of BT blaze. Painted blazes red and 6" red band around tree above BT Tag on all bearing trees.

stamping:

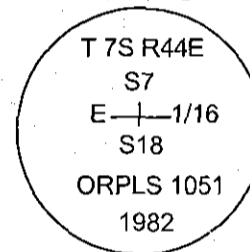

Description of monument and accessories I established to perpetuate the original location of this corner:

Placed new bearing tree tag and brass washer stamped "G WAGNER" LS 02817 on face of BT blaze. Painted blazes red and 6" red band around tree above BT Tag on all bearing trees.

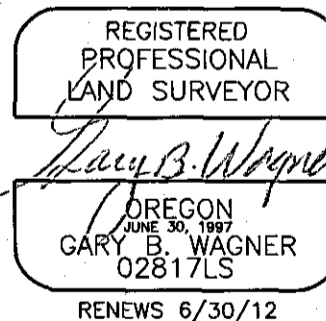

Office of County Surveyor, County of Baker
State of Oregon, I hereby certify that the within instrument was filed in this office
for record on the _____ day of _____ 2010

FILED Oct. 4, 2010
BAKER COUNTY SURVEYOR
SURVEY NO. 7-44-260