

SURVEY HISTORY

TYPED DOCUMENT FILED WITH PLATS.

NARRATIVE

TYPED 2 PAGE DOCUMENT FILED WITH PLATS.

SECTIONS 14, 23 & 24

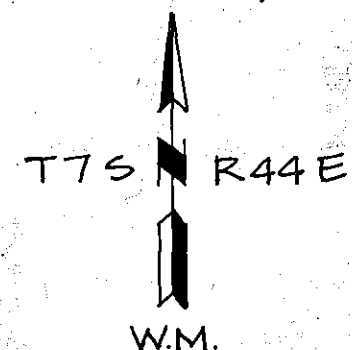

LEGEND

- FOUND CORNER BRASS CAP OF RECORD
- CORNER SET FROM ORIGINAL G.L.O. EVIDENCE
- BRASS OR ALUMINUM CAP CORNERS SET BY SURVEY.
- POSTED U.S.F.S. BOUNDARY
- () RECORD G.L.O. BEARING & DISTANCE
- [] METERS

BASIS OF BEARING
SOLAR OBSERVATION

MEAN MAGNETIC DECLINATION
N 20° 00' E

REFERENCE MATERIAL

ORIGINAL G.L.O. NOTES AND PLAT.
FIELD BOOKS 1-24.

NOTES

FORM R6-7100-57 FILED WITH THIS PLAT FOR STANDARD INDEX FILE NUMBERS, J-19, J-21, N-19, N-23, O-19, O-20, P-18, P-19, P-20, P-23, P-25, Q-18, Q-19, Q-21, Q-22, R-20, R-21 AND R-22.

NOTE: IF SEC. 14 WAS SUBDIVIDED, COR. #4 WOULD BE ABOUT 8.00' NORTH OF SUBDIVISION LINE.

NOTE: IF SEC. 14 WAS SUBDIVIDED, COR. #4 WOULD BE APPROXIMATELY 3.90' SOUTH AND 36.20' WEST OF SE 1/4 COR.

NOTE: FORM R6-7100-57 FILED WITH THIS PLAT, DESCRIBING EVIDENCE FOUND AND MONUMENTS SET FOR THE 7 CORNERS SHOWN. NO PRIOR SURVEY OF RECORD COULD BE FOUND.

FROM P.O.B. TO #2 & #5
S83° 32' 46" E, 46.44' [14.155]
(S83° 25' E, 46.92')

SNOW FORK TRACT IS WITHIN THE WEST 1/2 OF THE EAST 1/2 OF SECTION 14, T7S, R44E, W.M.

DETAIL 'A'
SNOW FORK TRACT
SCALE: 1" = 10'

NOTE: IF SEC. 14 WAS SUBDIVIDED, COR. #3 WOULD BE ABOUT 32.60' WEST OF SUBDIVISION LINE.

I, BARRY B. BARBOUR, a registered land surveyor in the state of Oregon, hereby certify that this plat and notes hereon, or attached are a correct representation of a survey I performed during 1982 to 1985, for the U.S. Forest Service in accordance with the articles of the contract and with the statutes of the state of Oregon. Contract number 53-04M3-2-2781

Barry B. Barbour
Barry B. Barbour
Registered Land Surveyor
Oregon License 1051

FILED 11-7-85
BAKER COUNTY SURVEYOR
SURVEY NO. 7-4-76

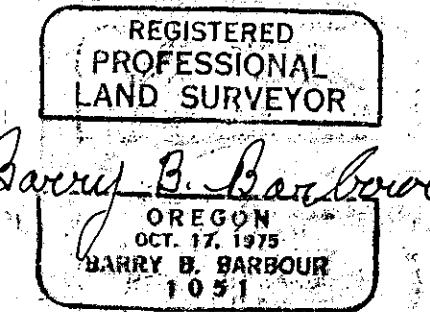

SECTIONS 14, 23 and 24
T7S, R44E, W.M.
BAKER COUNTY, OREGON
U.S.F.S. WALLOWA-WHITMAN NATIONAL FOREST

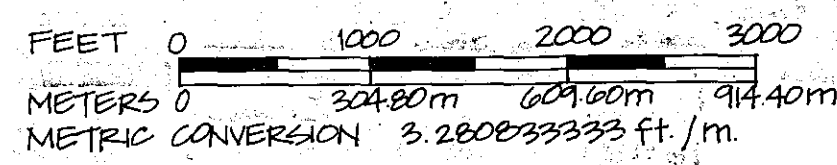

Scale: 1" = 1000' / 1" = 304.80m
Date: APRIL 1985
BARRY B. BARBOUR
Professional Land Surveyor
P.O. Box 4811
BOISE, IDAHO

Sheet No. 4