

CERTIFIED RECORD OF LAND CORNER MONUMENTATION

History of original corner establishment:

Corner not previously established.

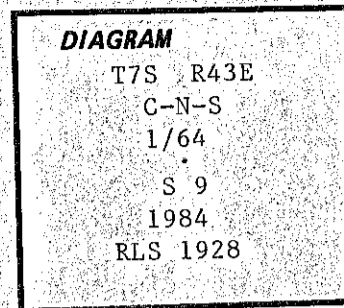

Description of corner evidence found:

Corner not previously established.

Description of monument and accessories | established to perpetuate the original location of this corner:

Set 30" long aluminum pipe with 3 1/2" aluminum cap 8" above ground, marked as shown above.

Set steel post with signs 54-9 and 54-2 attached.

Scribed:

9" Fir "C N S 1/64 S9 BT" S72W 15.5'
 10" Fir "C N S 1/64 S9 BT" S83E 47.8'

Nailed aluminum washers stamped "RLS 1928" above "BT" scribe on trees.

Painted blazes red and a 6" red band around trees.

Attached signs 54-3 & 54-9 to trees.

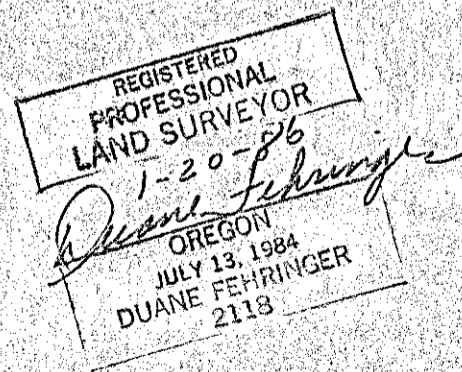

Office of..... County of.....
 State of....., I hereby certify that the within instrument was filed in this office
 for record on the..... day of....., 19.....
 by
 (COUNTY OFFICIAL) (DEPUTY)