

CERTIFIED RECORD OF LAND CORNER MONUMENTATION

History of original corner establishment:

Original survey executed by W. B. Barr in 1881 under Contract No. 388, dated May 7, 1881.

Set basalt rock 18" x 18" x 4" from which:

- 6" Fir bears N72E 24 lks.
- 6" Fir bears N32W 32 lks.

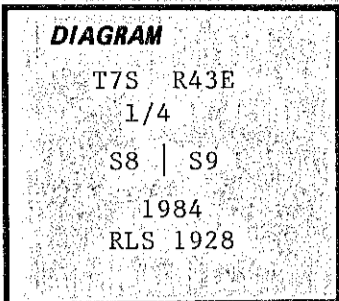

Description of corner evidence found:

NONE

Description of monument and accessories established to perpetuate the original location of this corner:

Set 30" long aluminum pipe with 3 1/4" aluminum cap 9" above ground, marked as shown above.

Set steel post with signs 54-4 attached.

Scribed:

- 7" Pine "1/4 S9 BT" N37E 19.1 ft.
- 10" Fir "1/4 S8 BT" S55W 23.2 ft.

Nailed aluminum washers stamped "RLS 1928" above "BT" scribe on trees.

Painted blazes red and a 6" red band around trees.

Attached bearing tree signs above blazes and land survey monument signs to back of trees.

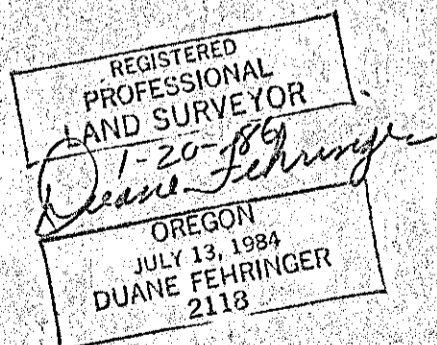

Office of..... County of.....
 State of....., I hereby certify that the within instrument was filed in this office
 for record on the..... day of....., 19.....
 by
 (COUNTY OFFICIAL) (DEPUTY)

FILED 5-9-86
 BAKER COUNTY SURVEYOR
 SURVEY NO. 7-43-118