

CERTIFIED RECORD OF LAND CORNER MONUMENTATION

History of original corner establishment:

Original survey executed by W. B. Barr in 1881 under Contract No. 388, dated May 7, 1881.
Set basalt rock 12"x8"x6" from which:
28" pine bears S.9°E. 72 lks
6" pine bears S.49°W 49 lks

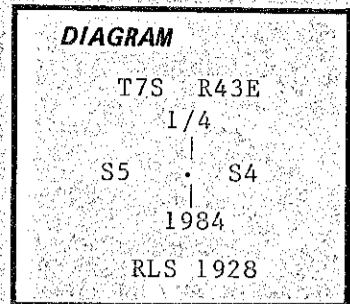

Description of corner evidence found:

NONE

Description of monument and accessories I established to perpetuate the original location of this corner:

Set 30" aluminum pipe with 3 1/4" aluminum cap, marked as shown above, 30" above ground mounded with rock. Steel post with 54-9 sign set next to cap.

Scribed:

8" pine N.64°E. 134.6' "1/4 S4 BT"
6" pine S.22°W. 38.2' "1/4 S5 BT"

Attached signs 54-3 & 54-9 and nailed aluminum washers stamped "RLS 1928" by "BT" scribe on each tree. Painted blazes red and a 6" red band around both trees.

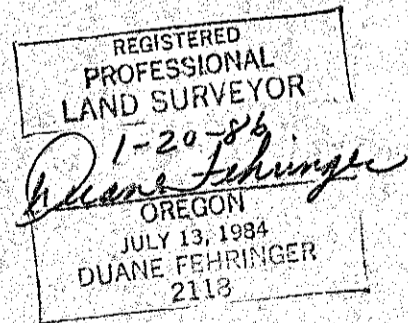

Office of..... County of.....
State of....., I hereby certify that the within instrument was filed in this office
for record on the..... day of....., 19.....
..... by

(COUNTY OFFICIAL)

(DEPUTY)

FILED 5-9-86
BAKER COUNTY SURVEYOR
SURVEY NO. 7-43-101