

CERTIFIED RECORD OF LAND CORNER MONUMENTATION

History of original corner establishment:

Corner not previously established.

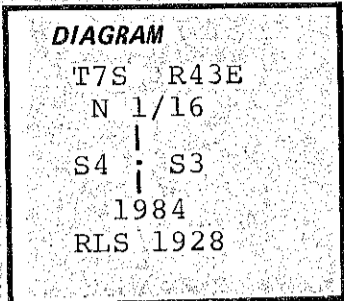

Description of corner evidence found:

Corner not previously established.

Description of monument and accessories established to perpetuate the original location of this corner:

Set 30" aluminum pipe with 3/4" aluminum cap 8" above ground marked as shown above.

Steel post 3' south with signs 54-9 and 54-2.

Scribed:

8" Fir "N 1/16 S4 BT" N30W 38.6 ft.
 10" Fir "N 1/16 S3 BT" N28E 26.6 ft.

Nailed aluminum washers stamped "RLS 1928" above "BT" scribe on each tree.

Nailed bearing tree signs above blazes and land survey monument signs on back of both trees.

Painted blazes red and a 6" red band above blaze on each tree.

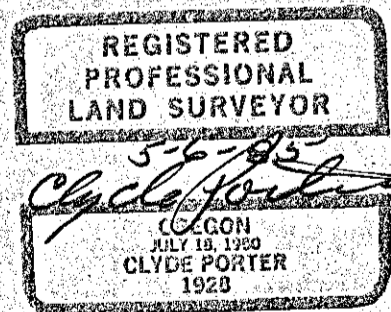

Office of..... County of.....
 State of....., I hereby certify that the within instrument was filed in this office
 for record on the..... day of....., 19.....
 by
 (COUNTY OFFICIAL) (DEPUTY)

FILED 5-9-86
 BAKER COUNTY SURVEYOR
 SURVEY NO. 7-4349