

CERTIFIED RECORD OF LAND CORNER MONUMENTATION

History of original corner establishment:

Original survey executed by W. B. Barr in 1881 under Contract No. 388, dated May 7, 1881.

Set wood post marked "T6S R43E S31" on NE side, "T6S R42E S36" on NW side, "T7S R42E S1" on SW side, and "T7S R43E S6" on SE side, from which:

- 30" Pine bears N20E 109 lks
- 30" Pine bears N65W 50 lks
- 40" Pine bears S66W 50 lks
- 36" Pine bears S55E 89 lks

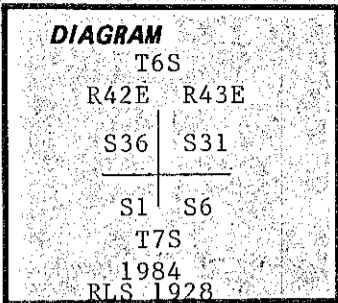

Description of corner evidence found:

Found 44" rotten stump S66½W 33 ft. with scribes visible in lower blaze and with 54-4 & 54-3 tags attached.

Description of monument and accessories established to perpetuate the original location of this corner:

Set 30" long aluminum pipe with 3¼" aluminum cap 9" above ground, marked as shown above.

Set steel post with signs 54-4 attached, 3' east.

Scribed:

- 8" Spruce "T6S R42E S36 BT" N46W 49.4'
- 10" Spruce "T7S R42E S1 BT" S20W 19.7'
- 10" Spruce "T7S R43E S6 BT" S56E 53.3'
- 10" Spruce "T6S R43E S31 BT" N77E 29.2'

Attached signs 54-4 & 54-3 and nailed aluminum washers stamped "RLS 1928" by "BT" scribe on each tree. Painted blazes red and a 6" red band around trees.

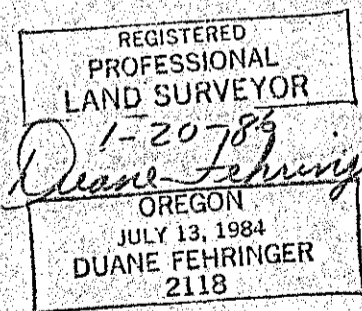

Office of..... County of.....
 State of....., I hereby certify that the within instrument was filed in this office
 for record on the..... day of....., 19....
 by
 (COUNTY OFFICIAL) (DEPUTY)

FILED 5-9-86
 BAKER COUNTY SURVEYOR
 SURVEY NO. 7-43-98