

CERTIFIED RECORD OF LAND CORNER MONUMENTATION

**HISTORY OF ORIGINAL CORNER ESTABLISHED:**

Corner not previously established

T 7 S R 39 E K-19

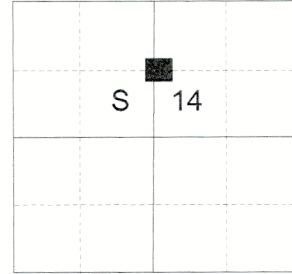

**DESCRIPTION OF CORNER EVIDENCE FOUND:**

None

**DESCRIPTION OF MONUMENT AND ACCESSORIES I ESTABLISHED TO MONUMENT THE ORIGINAL LOCATION OF THIS CORNER:**

At position by Survey, I set a 5/8" x 30" iron pin, 29" in the ground, with 2 1/2" aluminum cap marked as shown below, from which:

**NEW BEARING OBJECTS:**

A 5/8" x 15" iron pin bears South 82°12' West, a distance of 16.32 feet with 1 1/2" aluminum cap marked S RP BGB SURVEY MARKER.

A 5/8" x 15" iron pin bears North 6°22' West, a distance of 14.22 feet with 1 1/2" aluminum cap marked N RP BGB SURVEY MARKER.

Set steel fence post approx. 0.5 feet West.

Falls approx. 10 feet South of East/West bearing fence line.

I hereby certify that the corner was monumented on June 13, 2023.

Witness: Kyle Tucker

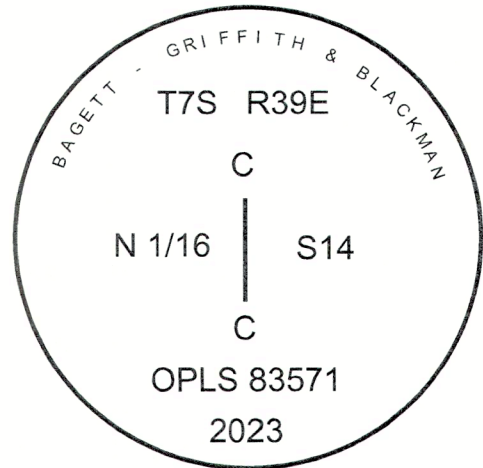

Renewal Date: June 30, 2025

I used a Leica GS18 with RTK in the establishment of the new accessories. Bearings and distances are measured to the center of the aluminum caps. Basis of bearing is as per Survey filed concurrently.

K-19

FILED July 19, 2023  
BAKER COUNTY SURVEYOR  
SURVEY NO. 7-39-118