

RECORD OF LAND CORNER MONUMENTATION

CORNER: NORTH 1/4 COR. SECTION 6, TWP. 7 S., RANGE 39 E., W.M.

ORIGINAL SURVEY BY: Timothy W. Davenport, U.S. Deputy Surveyor

CONTRACT NUMBER: 102

CONTRACT DATE: July 20, 1863

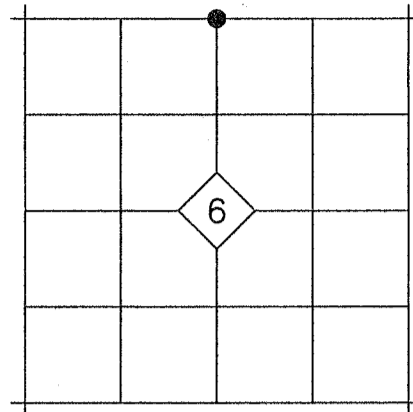

ORIGINAL DESCRIPTION: *Set qr Sec post. Made mound of earth and drove charred stake as per inst.*

EVIDENCE FOUND: After a diligent search, we found no remaining evidence of the original corner. Due to land ownership patterns in the area, there are no fences or other lines of occupation to provide evidence of the original corner location. I declare this corner lost, and reestablished its position by proportionate measure between monuments at the northwest and northeast corners of Section 6.

DESCRIPTION OF MONUMENTS AND ACCESSORIES SET AND METHODS USED:

At the corner point, I set a 5/8"x30" iron pin with attached 2 1/2 " aluminum cap 32" in the ground. Cap is marked as shown below.

From which, I SET THE FOLLOWING REFERENCE POINTS:

- ▶ A 5/8"x30" iron pin bears N.49°14'E., 35.03 ft. with attached yellow plastic cap marked BENCHMARK SURVEYING
- ▶ A 5/8"x30" iron pin bears S.38°24'E., 34.89 ft. with attached yellow plastic cap marked BENCHMARK SURVEYING
- ▶ A 5/8"x30" iron pin bears S.49°09'W., 32.64 ft. with attached yellow plastic cap marked BENCHMARK SURVEYING
- ▶ A 5/8"x30" iron pin bears N.39°29'W., 32.53 ft. with attached yellow plastic cap marked BENCHMARK SURVEYING

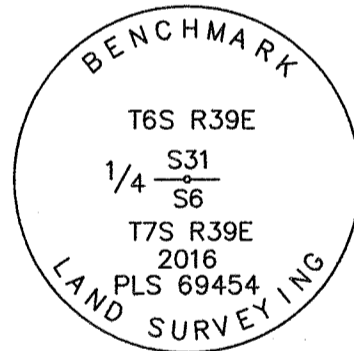

Used RTK GPS to measure the reference points. See associated survey dated July 22, 2016, filed separately.

RESTORATION BY, STAMP AND DATE:

Work Performed July 7, 2016 by:

Jason L. Hatfield, PLS
Michael C. Springer, PLS

BENCHMARK LAND SURVEYING, INC.
2101 Main Street
Baker City, OR 97814
(800) 699-0516
www.benchmarkls.com

FILED Aug. 5, 2016
BAKER COUNTY SURVEYOR
SURVEY NO. 6-39-8
7-39-81

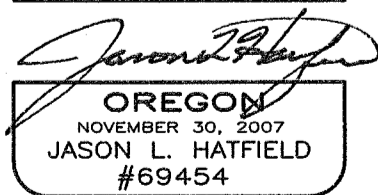
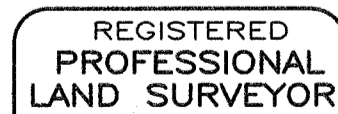

EXPIRES: 6/30/2017