

RECORD OF LAND CORNER MONUMENTATION

CORNER: SOUTHEAST COR. SECTION 6, TWP. 7 S., RANGE 39 E., W.M.

ORIGINAL SURVEY BY: David P. Thompson & David Chaplin,
U.S. Deputy Surveyors

CONTRACT NUMBER: 104

CONTRACT DATE: April 16, 1864

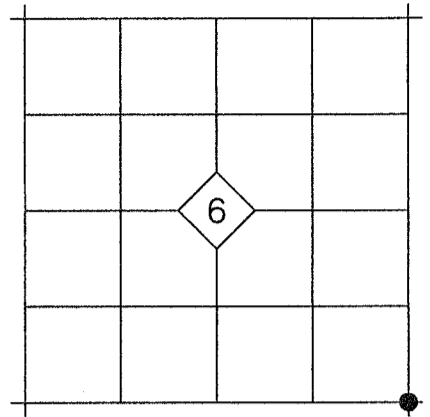

ORIGINAL DESCRIPTION: Set post for corner to secs 5, 6, 7 & 8 in mound of Earth with charred stake pits trench as per instructions.

EVIDENCE FOUND: No remaining evidence of the original post was found. The corner is reestablished at the intersection of a long-established north-south running fence line projected North and a long-established east-west fence line projected East. Said fences being the best available evidence of the Section lines. This position is harmoniously related to other known corners to the North, South and West. See Map of Survey dated July 22, 2016 filed in the office of the Baker County Surveyor for its relationship to other corners.

DESCRIPTION OF MONUMENTS AND ACCESSORIES SET AND METHODS USED:

At the corner point, I set a 5/8"x30" iron pin with attached 2 1/2 " aluminum cap 30" in the ground. Cap is marked as shown below.

From which, I SET THE FOLLOWING REFERENCE POINTS:

- ▶ A 5/8"x30" iron pin bears N.55°43'E., 23.39 ft. with attached yellow plastic cap marked BENCHMARK SURVEYING
- ▶ A 5/8"x30" iron pin bears S.47°16'E., 28.88 ft. with attached yellow plastic cap marked BENCHMARK SURVEYING
- ▶ A 5/8"x30" iron pin bears S.47°45'W., 31.02 ft. with attached yellow plastic cap marked BENCHMARK SURVEYING
- ▶ A 5/8"x30" iron pin bears N.64°49'W., 26.01 ft. with attached yellow plastic cap marked BENCHMARK SURVEYING

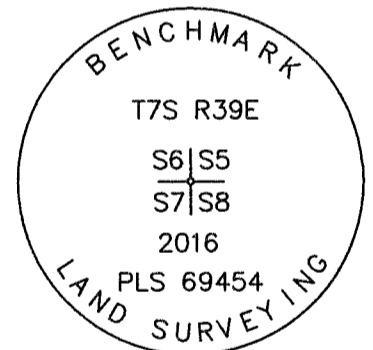

Used RTK GPS to measure the reference points. See associated survey dated July 22, 2016, filed separately.

RESTORATION BY, STAMP AND DATE:

Work Performed July 7, 2016 by:

Jason L. Hatfield, PLS
Michael C. Springer, PLS

BENCHMARK LAND SURVEYING, INC.
2101 Main Street
Baker City, OR 97814
(800) 699-0516
www.benchmarkls.com

FILED Aug. 5, 2016
BAKER COUNTY SURVEYOR
SURVEY NO. 7-39-80

