

RECORD OF LAND CORNER MONUMENTATION

CORNER: SOUTH 1/4 COR. SECTION 6, TWP. 7 S., RANGE 39 E., W.M.

ORIGINAL SURVEY BY: David P. Thompson & David Chaplin,
U.S. Deputy Surveyors

CONTRACT NUMBER: 104

CONTRACT DATE: April 16, 1864

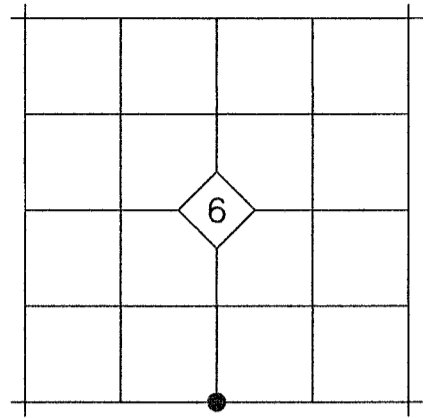

ORIGINAL DESCRIPTION: Set post for 1/4 Sec corner in mound of Earth with charred stake pits trench as per instructions.

EVIDENCE FOUND: There is no remaining evidence of the original post. The corner is determined to be at the corner of long-established fences running North, East and South, which is the best available evidence of the original corner position.

DESCRIPTION OF MONUMENTS AND ACCESSORIES SET AND METHODS USED:

At the corner point, I set a 5/8"x30" iron pin with attached 2 1/2 " aluminum cap 30" in the ground. Cap is marked as shown below.

From which, I SET THE FOLLOWING REFERENCE POINTS:

- ▶ A 5/8"x30" iron pin bears N.89°07'E., 39.52 ft. with attached yellow plastic cap marked BENCHMARK SURVEYING, set in an East-West fence
- ▶ A 5/8"x30" iron pin bears S.00°28'E., 25.59 ft. with attached yellow plastic cap marked BENCHMARK SURVEYING, set in a North-South fence
- ▶ A 5/8"x30" iron pin bears N.57°00'W., 32.33 ft. with attached yellow plastic cap marked BENCHMARK SURVEYING
- ▶ A 5/8"x30" iron pin bears N.00°39'E., 32.34 ft. with attached yellow plastic cap marked BENCHMARK SURVEYING, set in a North-South fence

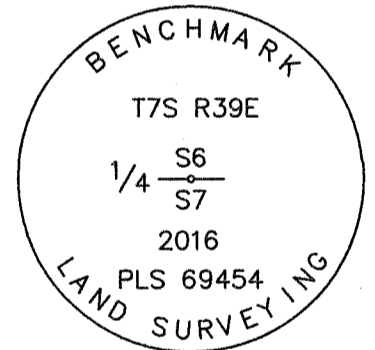

Used RTK GPS to measure the reference points. See associated survey dated July 22, 2016, filed separately.

RESTORATION BY, STAMP AND DATE:

Work Performed July 7, 2016 by:

Jason L. Hatfield, PLS
Michael C. Springer, PLS

BENCHMARK LAND SURVEYING, INC.
2101 Main Street
Baker City, OR 97814
(800) 699-0516
www.benchmarkls.com

FILED Aug. 5, 2016
BAKER COUNTY SURVEYOR
SURVEY NO. 7-39-19

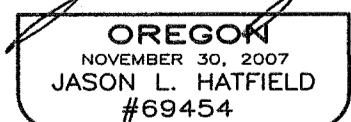
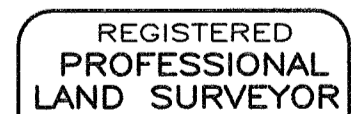

EXPIRES: 6/30/2017