

RECORD OF LAND CORNER MONUMENTATION

CORNER: C-W1/16 COR. SECTION 6, TWP. 7 S., RANGE 39 E., W.M.

(CORNER NOT PREVIOUSLY ESTABLISHED)

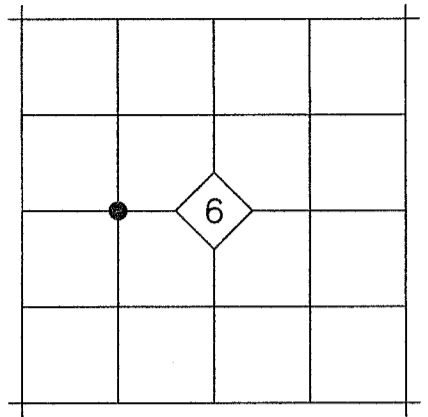

ORIGINAL DESCRIPTION: N/A

EVIDENCE FOUND: N/A

DESCRIPTION OF MONUMENTS AND ACCESSORIES SET AND METHODS USED:

At the corner point, as located by survey, I set a 5/8"x30" iron pin with attached 2" aluminum cap 28" in the ground. Cap is marked as shown below.

From which, I SET THE FOLLOWING REFERENCE POINTS:

- ▶ A 5/8"x30" iron pin bears S.52°27'W., 14.61 ft. with attached yellow plastic cap marked BENCHMARK SURVEYING, set in a North-South fence
- ▶ A 5/8"x30" iron pin bears N.35°33'W., 13.91 ft. with attached yellow plastic cap marked BENCHMARK SURVEYING, set in a North-South fence

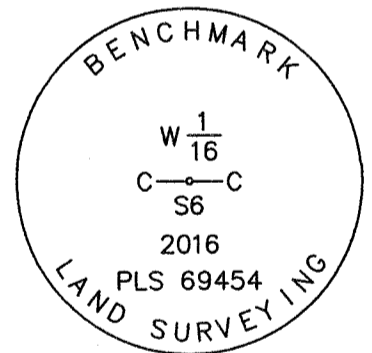

Used a Total Station to measure the reference points. See associated survey dated July 22, 2016, filed separately.

RESTORATION BY, STAMP AND DATE:

Work Performed July 7, 2016 by:

Jason L. Hatfield, PLS
Michael C. Springer, PLS

BENCHMARK LAND SURVEYING, INC.
2101 Main Street
Baker City, OR 97814
(800) 699-0516
www.benchmarkls.com

FILED Aug. 5, 2016
BAKER COUNTY SURVEYOR
SURVEY NO. 7-39-76

REGISTERED
PROFESSIONAL
LAND SURVEYOR

OREGON
NOVEMBER 30, 2007
JASON L. HATFIELD
#69454

EXPIRES: 6/30/2017