

BASIS OF BEARINGS

RECORD SURVEY NO. 7-38-12
 THE WEST LINE OF THE SW1/4SE1/4 SECTION 21,
 T.7S., R.38E., W.M., AS SHOWN

NARRATIVE

THIS SURVEY WAS PERFORMED AT THE REQUEST OF BOB MIDDLETON ON BEHALF OF THE ROBERT A. MIDDLETON AND HELEN S. MARSH FAMILY TRUST. SAID TRUST IS THE OWNER OF PARCEL 1 OF PARTITION PLAT NO. P1999-014, AS EVIDENCED BY BAKER COUNTY DEED NO. B13-32-0011. THE PURPOSE OF THIS SURVEY WAS TO ENSURE ALL CORNERS OF THE PROPERTY ARE PROPERLY MONUMENTED, AND TO POST PORTIONS OF THE EAST AND WEST LINES.

A SEARCH WAS MADE OF THE AVAILABLE RECORDS PERTAINING TO THIS SURVEY. THE MAJORITY OF THE CORNERS OF THE SUBJECT PROPERTY WERE MONUMENTED DURING THE COURSE OF FIVE SURVEYS. SURVEY NO. 7-38-10 WAS PERFORMED BY JIM HANLEY, PLS, IN 1978 DOCUMENTING THE REMONUMENTATION OF THE 1/4 CORNER COMMON TO SECTIONS 21 AND 28. SURVEY NO. 7-38-12 WAS PERFORMED BY WILLIAM HANLEY, PLS, IN NOVEMBER OF 1978. MR. HANLEY SUBDIVIDED SECTION 21, AND IN PART MONUMENTED THE CORNERS OF THE SW1/4SE1/4. JIM HANLEY PERFORMED SURVEY NO.'S 7-38-28, 7-38-63 AND 7-38-64, WHICH WERE DONE IN 1980, 1987 AND 1989, RESPECTIVELY. DURING THESE SURVEYS, HE SUBDIVIDED SECTION 28 AND MONUMENTED THE MAJORITY OF THE CORNERS OF THE SUBJECT PROPERTY. THE ONLY CORNER WHICH WAS NOT MONUMENTED BY ANY SURVEY OF RECORD IS THE CORNER 165 FEET EAST OF THE NORTH QUARTER CORNER OF SECTION 28.

FIELD MEASUREMENTS WERE MADE TO LOCATE MONUMENTATION FROM THE AFOREMENTIONED SURVEYS, WHICH WERE ALL FOUND AND ACCEPTED. AT THE CORNER WHICH IS 165 FEET EAST OF THE NORTH 1/4 CORNER OF SECTION 28, WE FOUND AN UNRECORDED 1/2" IRON PIPE BEARING N.40°57'51"W, 4.80 FEET FROM THE DEED RECORD POSITION. I DO NOT ACCEPT THIS PIPE FOR THE POSITION OF THE CORNER. TO ESTABLISH THIS CORNER, I HELD THE DEED RECORD DISTANCE OF 10 RODS (165 FEET) FROM THE FOUND NORTH 1/4 CORNER SECTION 28, AND PLACED IT ON LINE BETWEEN FOUND ACCEPTED MONUMENTS ALONG THE NORTH LINE OF SECTION 28, AS SHOWN.

WE POSTED PORTIONS OF THE EAST AND WEST PROPERTY LINES WITH STEEL U POSTS WHERE EXISTING FENCES DEVIATED FROM THE PROPERTY LINES. A PORTION OF THE SOUTH LINE IS FENCED, AND THE REMAINDER OF THE LINE WAS PREVIOUSLY POSTED WITH STEEL T POSTS BY JIM HANLEY IN 1989. WE RETRACED THIS LINE AND FOUND HIS POSTS IN GOOD CONDITION.

LEGEND

- ⊙ FOUND 1" GALV. IRON PIPE WITH ATTACHED 2 1/2" BAKER COUNTY SURVEYOR BRASS CAP FROM SURVEY NO. 7-38-10
- FOUND 1" GALV. IRON PIPE WITH ATTACHED 2 1/2" BRASS CAP FROM SURVEY NO. 7-38-63
- FOUND 5/8" IRON PIN WITH NO CAP FROM SURVEY NO. 7-38-64 UNLESS OTHERWISE STATED
- FOUND 5/8" IRON PIN WITH ATTACHED YELLOW PLASTIC CAP MARKED "HANLEY ENGRG PLS 1206" FROM SURVEY NO. 7-38-64 UNLESS OTHERWISE STATED
- SET 5/8"x30" IRON PIN WITH ATTACHED YELLOW PLASTIC CAP MARKED BENCHMARK SURVEYING
- () DEED RECORD BEARING AND DISTANCE
- [] RECORD BEARING AND DISTANCE FROM SURVEY NO. 7-38-12
- 1[] RECORD BEARING AND DISTANCE FROM SURVEY NO.'S 7-38-28, 7-38-63 AND 7-38-64
- X-X FENCE LINE
- 7-38-XX RECORD SURVEY NO. FROM WHICH FOUND MONUMENT ORIGINATED

LINE TABLE

LINE	BEARING	DIST.
(L1)	N57°52'50"W	184.61
(L2)	N74°32'10"W	78.15
(L3)	N85°32'05"W	212.98

REFERENCES

RECORD MAP OF SURVEY NO.'S 7-38-10, 7-38-12, 7-38-28, 7-38-63 AND 7-38-64
 DEED RECORD INSTRUMENT NO.'S 83-32-109, B13-32-0011 & B14-04-0048
 PARTITION PLAT NO. P1999-014

REGISTERED PROFESSIONAL LAND SURVEYOR

Jason L. Hatfield
 OREGON
 NOVEMBER 30, 2007
 JASON L. HATFIELD
 #69454
 EXPIRES: 6/30/2017

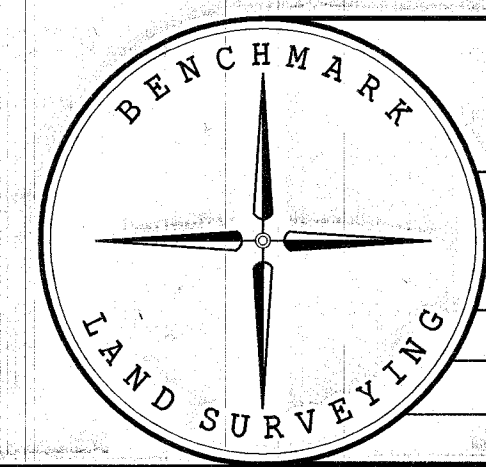

BENCHMARK LAND SURVEYING
 217 N. CANYON BLVD. JOHN DAY, OREGON
 2101 MAIN STREET, STE 223 BAKER CITY, OREGON
 541-575-1251 ~ 800-699-0516

MAP OF SURVEY
 PARCEL 1 OF LAND PARTITION PLAT NO. P1999-014
 SITUATED IN THE SE1/4 SECTION 21 AND THE NE1/4 SECTION 28,
 T.7S., R.38E., W.M., BAKER COUNTY, OREGON

SURVEYED FOR	BOB MIDDLETON AND HELEN MARSH	
SURVEYED BY	JLH & MRT	10/20/2016
SCALE: 1"=300'	DRAWN BY: JLH	

FILED Nov. 8, 2016
 BAKER COUNTY SURVEYOR
 SURVEY NO. 7-38-12/1