

OREGON CORNER RESTORATION FORM

Section 34 Township 7S Range 38E
 County Baker Date: October 6th, 2022

Corner Designation: 7S38EX13

Condition report only
 Not Found
 Remonumented
 Unrecorded
 Surveyed In
 Referenced Out

Quarter Corner common to Sections 33 and 34, T7S, R38E,
 W.M., Baker County, Oregon.

Previous Renewals, Surveys, etc...

This corner was originally set by David P. Thompson and Daniel Chapliin under contract No. 104 dated April 16th, 1864. Their record Reads: Set post for quarter section corner in mound of earth with charred stake, pits, trench and C as per instructions. In 1983 under survey 7-38-22, Thomas Hanley reports "not found, proportioned". At the proportioned point he set a 2 1/2" brass cap on a 1"x30" iron pipe. For references he marked a 9" diameter apple tree, S68°W - 27.2ft. He also called the SW corner of a wood frame house at S48°E, 87.2 ft. dist.

Monument and accessories found: (condition and source)

Found the brass cap, apple tree and wood frame house called for in survey 7-38-22. Also found the intersection of fence lines running north and south and the projection of a fence to the east. Also, a power line running east and south as per easement deed Book 71, Page 45.

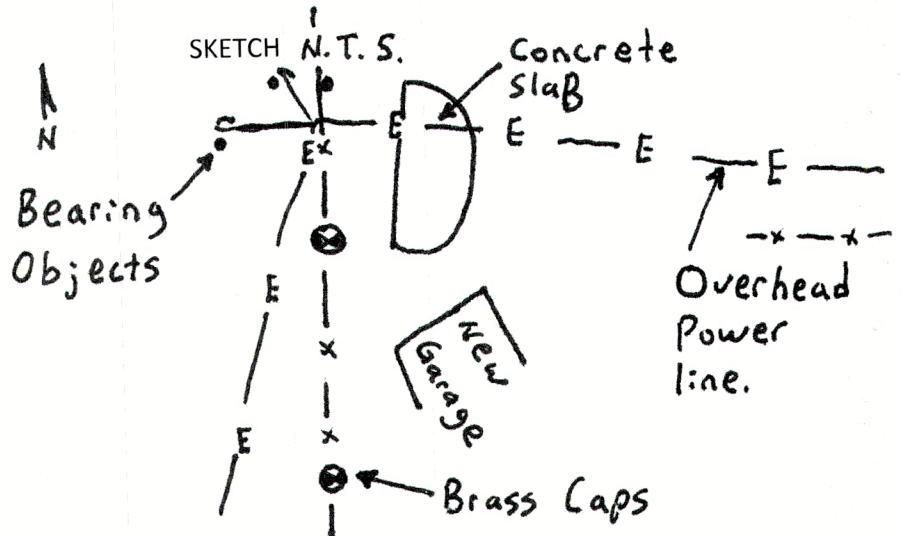
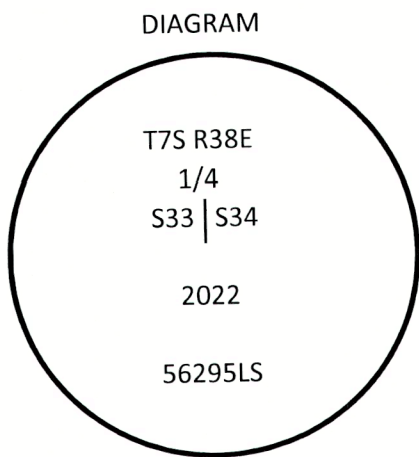

MONUMENT(S) AND ACCESSORIES SET (Procedures and Description)

At the position of the original corner as determined by the long term possessory fences and confirmed by ties to the existing power line and the GLO call to Rock Creek, I set a 2 1/4" brass cap on a 1 1/2"x30" galvanized iron pipe 1" below the surface of the ground.

For references I set three 5/8" by 24" iron rebars with 1.25" orange plastic caps stamped WTS and 56295LS as described below:

- An iron rebar bears N56°22'24"W 40.21' beside a power line guy anchor;
- An iron rebar bears N09°14'13"W 50.69' beside a power line guy anchor;
- An iron rebar bears N01°18'07"W 51.14' on the south side of a railroad tie fence post;
- The brass cap from survey 7-38-22 bears S01°14'55"E 49.22' under the existing fence;
- The most westerly corner of a recently constructed garage bears S21°51'40"E 29.66';

The monument was referenced and reset using a Trimble R8S RTK GPS system.

Location and comments:

V-13

Compass Declination

Surveyor's Seal

RECEIVED BY:

Baker County Surveyor

Date: December 13, 2022

Rec'd By:

No. 7-38-146

Firm / Agency
 WITNESS TREE SURVEYING
 Address
 P.O. Box G
 Pilot Rock, OR 97868
 Party Chief
 Stephen K. Haddock

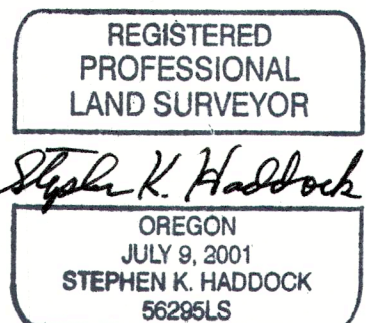

RENEWS: 6-30-23