

RECORD OF LAND CORNER MONUMENTATION

CORNER: CENTER-SOUTH 1/16 COR. SECTION 35, T. 7S., R. 38 E., W.M.

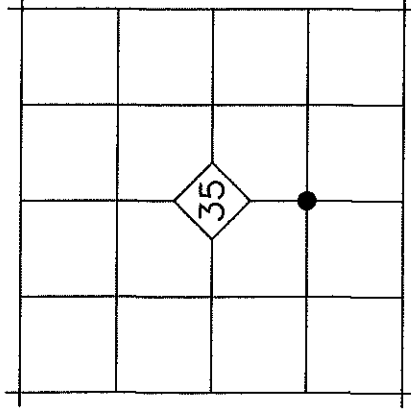

PREVIOUSLY ESTABLISHED BY:

- 1) Baker County Survey No. 7-38-1 by Thomas Lagier, PE, dated October 20, 1971, filed January 19, 1972

LAGIER'S 1971 DESCRIPTION: Notation at corner: *ANCIENT FENCE CORNER SW CORNER OF NW1/4 OF SE1/4*

EVIDENCE FOUND: The corner of long-established fences running North, East and West as accepted by Lagier. I accept the position of the fence corner as the best available evidence of the 1/16 corner.

DESCRIPTION OF MONUMENTS AND ACCESSORIES SET AND METHODS USED:

At the corner point, I set a 5/8"x30" iron pin with attached 2-1/2" aluminum cap 30" in the ground. Cap is marked as shown below.

From which, I SET THE FOLLOWING REFERENCE POINTS:

- ▶ A 5/8"x30" iron pin bears S.89°15'W., 20.38 ft. with attached yellow plastic cap marked BENCHMARK SURVEYING.
- ▶ A 5/8"x30" iron pin bears N.89°54'19"W., 440.00 ft. with attached yellow plastic cap marked BENCHMARK SURVEYING.

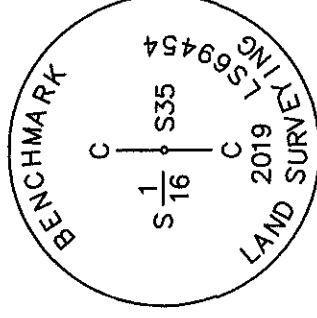

Used RTK GPS to measure the reference points. Bearings are based on Land Partition Plat No. P2020-01.

Work Performed November 26, 2019 by:

Jason L. Hatfield, PLS

BENCHMARK LAND SURVEYING, INC.

1207 Dewey Avenue

Baker City, OR 97814

(541) 523-5852

www.benchmarkls.com

FILED January 21, 2020

BAKER COUNTY SURVEYOR

SURVEY NO. 7-38-136

REGISTERED
PROFESSIONAL
LAND SURVEYOR

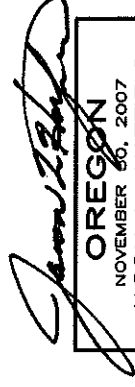

OREGON
NOVEMBER 30, 2007
JASON L. HATFIELD
#69454

EXPIRES: 6/30/2021