

RECORD OF LAND CORNER MONUMENTATION

CORNER: S1/16 COR. SECTION 21, TWP. 7 S., RANGE 38 E., W.M.

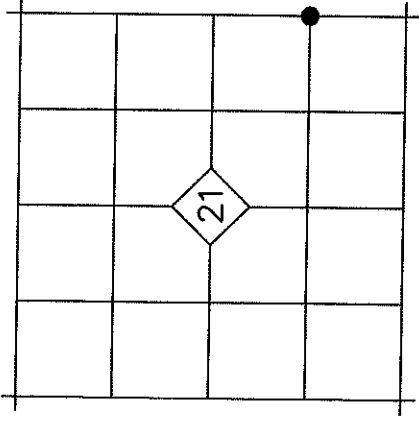

ORIGINAL DESCRIPTION: N/A

EVIDENCE FOUND: N/A

DESCRIPTION OF MONUMENTS AND ACCESSORIES SET AND METHODS USED:

At the corner point, as determined by survey, I set a 5/8"x30" iron pin with attached 2" aluminum cap 28" in the ground. Cap is marked as shown below. Surrounded the monument with a small mound of stones and set a steel U post alongside.

From which, I SET THE FOLLOWING REFERENCE POINT:

- ▶ A 5/8"x30" iron pin bears N.37°29'W., 22.72 ft. with attached yellow plastic cap marked BENCHMARK SURVEYING

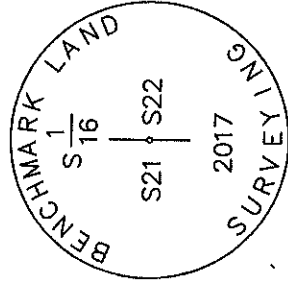

I ALSO SCRIBED THE FOLLOWING BEARING TREE:

- ▶ A 9" DBH ponderosa pine, blazed and scribed 1/16 BT, bears S.51°20'W., 17.35 feet from the corner

Used a total station to measure the accessories. Distance to bearing tree was measured to a 50d galv. nail driven in the side center at the root crown of the tree. Bearings are based on Baker County Survey No. 7-38-12. Attached a BT tag to the tree.

RESTORATION BY, STAMP AND DATE:

Work Performed September 21, 2017 by:

Jason L. Hatfield, PLS

BENCHMARK LAND SURVEYING, INC.

1207 Dewey Avenue

Baker City, OR 97814

(541) 523-5852

www.benchmarkis.com



Jason L. Hatfield
OREGON
NOVEMBER 30, 2007
JASON L. HATFIELD
#69454

EXPIRES: 6/30/2019

FILED October 3, 2017

BAKER COUNTY SURVEYOR

SURVEY NO. 7-38-123