

# RECORD OF LAND CORNER MONUMENTATION

**CORNER:** NORTHEAST COR. SECTION 21, TWP. 7 S., RANGE 38 E., W.M.

**ORIGINAL SURVEY BY:** David Thompson and Daniel Chaplin,  
U.S. Deputy Surveyors

**CONTRACT NUMBER:** 104

**CONTRACT DATE:** April 16, 1864

**SUBSEQUENT SURVEY:** Baker County Survey No. 7-38-12 by  
William Hanley, PLS, filed December 4, 1978

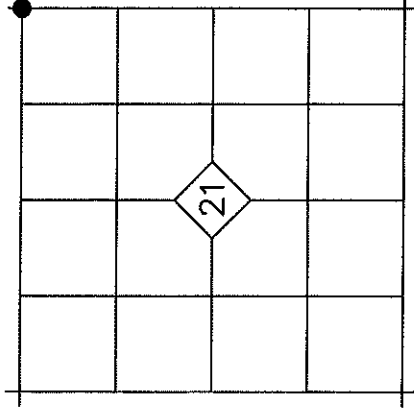

**ORIGINAL DESCRIPTION:** *Set post for corner to secs 15, 16, 21 & 22 in mound of Earth with charred stake pits trench as per instructions.*

**SURVEY NO. 7-38-12:** Notation at corner states: *Accepted fence inter. for section corner.*

**EVIDENCE FOUND:** I found that the North-South fence has been rebuilt in recent years. A cross fence comes in from the East, but doesn't actually intersect the North-South fence. Evidence of an old fence corner was present in the form of aged down wood posts, but a definite intersection point could not be determined by the fences alone.

## DESCRIPTION OF MONUMENTS AND ACCESSORIES SET AND METHODS USED:

I declare this corner obliterated, and determined the position by measuring record bearing and distance from the found monument at the southeast corner of Section 21, utilizing record data from Survey No. 7-38-12. At the corner point, I set a 5/8"x30" iron pin with attached 2 1/2" aluminum cap 28" in the ground. Cap is marked as shown below.

From which, I SET THE FOLLOWING REFERENCE POINTS:

- ▶ A 5/8"x30" iron pin bears N.77°54'E., 42.67 ft. with attached yellow plastic cap marked BENCHMARK SURVEYING
- ▶ A 5/8"x30" iron pin bears S.03°49'W., 28.43 ft. with attached yellow plastic cap marked BENCHMARK SURVEYING
- ▶ A 5/8"x30" iron pin bears N.89°57'W., 17.00 ft. with attached yellow plastic cap marked BENCHMARK SURVEYING
- ▶ A 5/8"x30" iron pin bears N.00°17'W., 61.06 ft. with attached yellow plastic cap marked BENCHMARK SURVEYING

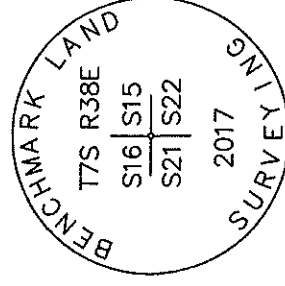

Used RTK GPS to measure the accessories. Bearings are based on Baker County Survey No. 7-38-12.

## RESTORATION BY, STAMP AND DATE:

Work Performed September 21, 2017 by:

Jason L. Hatfield, PLS

BENCHMARK LAND SURVEYING, INC.  
1207 Dewey Avenue  
Baker City, OR 97814  
(541) 523-5852  
www.benchmarkpls.com

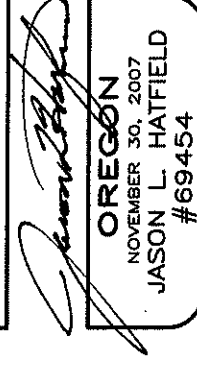

FILED October 3, 2017  
BAKER COUNTY SURVEYOR  
SURVEY NO. 7-38-13a