

BASIS OF BEARINGS

RECORD SURVEY NO. 7-38-121
THE WEST LINE OF THE SE1/4SE1/4 SECTION 21,
T.7S., R.38E., W.M. BEARS N.00°56'52"W.,
AS SHOWN

LEGEND

- ⊙ FOUND 1" GALV. IRON PIPE WITH ATTACHED 2 1/2" BAKER COUNTY SURVEYOR BRASS CAP DATED 1979, WHICH WAS FOUND AND ACCEPTED ON SURVEY NO.'S 7-38-63 & 7-38-64
- ⊙ FOUND 1" GALV. IRON PIPE WITH ATTACHED 2 1/2" BRASS CAP FROM SURVEY NO. 7-38-63
- FOUND 5/8" IRON PIN WITH NO CAP FROM SURVEY NO. 7-38-12
- ⊙ SET 5/8"x30" IRON PIN WITH ATTACHED 2 1/2" ALUMINUM CAP MARKED AS SHOWN
- SET 5/8"x30" IRON PIN WITH ATTACHED 2" ALUMINUM CAP MARKED AS SHOWN
- G() G.L.O. RECORD BEARING AND DISTANCE
- () DEED RECORD BEARING AND DISTANCE
- [] RECORD BEARING AND DISTANCE FROM SURVEY NO. 7-38-12
- 1[] RECORD BEARING AND DISTANCE FROM SURVEY NO.'S 7-38-63 AND 7-38-64
- 2[] RECORD BEARING AND DISTANCE FROM SURVEY NO. 7-38-121
- x-x FENCE LINE
- SFNF MONUMENT SEARCHED FOR NOT FOUND
- === EXISTING 2-TRACK ROAD

NARRATIVE

THIS SURVEY WAS PERFORMED AT THE REQUEST OF CHARLES GETCHELL, TRUSTEE OF THE CHARLES R. AND DIANE R. GETCHELL JOINT LIVING TRUST. SAID TRUST IS THE OWNER OF THE SE1/4SE1/4 SECTION 21, T.7S., R.38E., W.M., AS EVIDENCED BY BAKER COUNTY DEED NO. B08520429. THE PURPOSE OF THIS SURVEY WAS TO ENSURE PROPER MONUMENTATION OF ALL CORNERS, AND TO POST THE NORTH, EAST AND SOUTH PROPERTY LINES.

A SEARCH WAS MADE OF THE AVAILABLE RECORDS PERTAINING TO THIS SURVEY. THE EAST LINE OF SECTION 21 IN TOWNSHIP 7 SOUTH RANGE 38 EAST WAS ORIGINALLY SURVEYED BY DAVID THOMPSON AND DANIEL CHAPLIN, U.S. DEPUTY SURVEYORS UNDER CONTRACT NO. 104 DATED APRIL 16, 1864. SECTION 21 WAS SUBDIVIDED IN NOVEMBER OF 1978 BY WILLIAM HANLEY, PLS, RECORDED AS BAKER COUNTY SURVEY NO. 7-38-12. I ALSO UTILIZED BAKER COUNTY SURVEY NO.'S 7-38-28, 7-38-63, 7-38-64 AND 7-38-121.

FIELD MEASUREMENTS WERE MADE TO LOCATE RECORD MONUMENTS SHOWN ON THE AFOREMENTIONED SURVEYS, WHICH WERE ALL FOUND AND ACCEPTED. IN SURVEY NO. 7-38-12, MR. HANLEY ACCEPTED A FENCE INTERSECTION AT THE NORTHEAST CORNER OF SECTION 21, BUT NO MONUMENT WAS SET AT THAT TIME. I SEARCHED THIS LOCATION AND FOUND THE NORTH-SOUTH FENCE TO HAVE BEEN REBUILT IN RECENT YEARS. THERE IS A CROSS FENCE COMING IN FROM THE EAST THAT DOESN'T ACTUALLY INTERSECT THE NORTH-SOUTH FENCE. EVIDENCE OF AN OLD FENCE CORNER WAS PRESENT IN THE FORM OF AGED DOWN WOOD POSTS, BUT A POSITIVE FENCE INTERSECTION POINT COULD NOT BE DETERMINED BY THE FENCES ALONE. THEREFORE, I REESTABLISHED THE SECTION CORNER MEASURING RECORD BEARING AND DISTANCE FROM THE SOUTHEAST CORNER OF SECTION 21, UTILIZING RECORD DATA FROM SURVEY NO. 7-38-12. THE EAST QUARTER CORNER OF SECTION 21 HAD PREVIOUSLY BEEN DETERMINED BY PROPORTIONATE MEASUREMENT ON SURVEY NO. 7-38-12, BUT NOT MONUMENTED. THE QUARTER CORNER FALLS IN A PASTURE, WHERE NO EVIDENCE OF THE ORIGINAL G.L.O. MONUMENT REMAINS. I ALSO DETERMINED SAID CORNER BY SINGLE PROPORTIONATE MEASUREMENT, BUT DID NOT MONUMENT ITS POSITION DURING THIS SURVEY. SEE CORNER MONUMENTATION SHEETS FILED SEPARATELY FOR DETAILS REGARDING MONUMENTS SET AND ACCESSORIES ESTABLISHED AT THE NE CORNER AND 1/16 CORNER OF SECTION 21.

I POSTED THE NORTH, EAST AND SOUTH LINES OF THE GETCHELL PROPERTY WITH STEEL U POSTS AND FLAGGING.

REFERENCES

RECORD MAP OF SURVEY NO.'S 7-38-10, 7-38-12, 7-38-28, 7-38-63, 7-38-64 AND 7-38-121
DEED RECORD INSTRUMENT NO.'S B08520429, B13320011, B13350120 AND B14040048
PARTITION PLAT NO. P1999-014
G.L.O. FIELD NOTES

REGISTERED
PROFESSIONAL
LAND SURVEYOR

Jason L. Hatfield

OREGON
NOVEMBER 30, 2007
JASON L. HATFIELD
#69454
EXPIRES: 6/30/2019

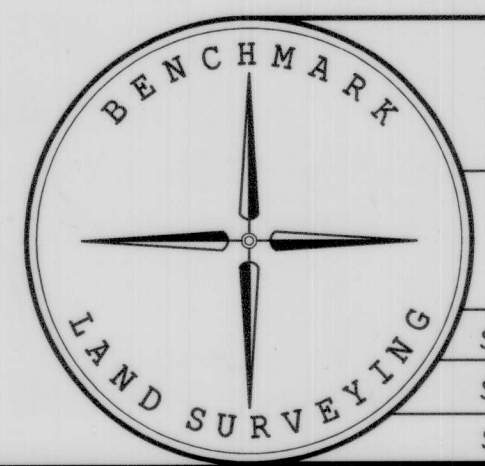

BENCHMARK LAND SURVEYING
217 N. CANYON BLVD. JOHN DAY, OREGON
1207 DEWEY AVE. BAKER CITY, OREGON
541-575-1251 ~ 541-523-5852

MAP OF SURVEY DEPENDENT RESURVEY AND SUBDIVISION OF THE SE1/4 SECTION 21, T.7S., R.38E., W.M., BAKER COUNTY, OREGON		
SURVEYED FOR	CHARLES GETCHELL	
SURVEYED BY	JLH	9/21/2017
SCALE: 1"=300'	DRAWN BY: JLH	

FILED October 3, 2017
BAKER COUNTY SURVEYOR
SURVEY NO. 7-38-131