

# RECORD OF LAND CORNER MONUMENTATION

**CORNER:** N1/16 COR. SECTION 34, TWP. 7 S., RANGE 38 E., W.M.

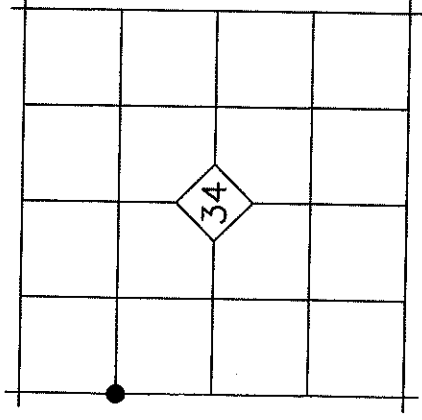

**ORIGINAL DESCRIPTION:** N/A

**EVIDENCE FOUND:** N/A

## **DESCRIPTION OF MONUMENTS AND ACCESSORIES SET AND METHODS USED:**

At the corner point, as determined by survey, I set a 5/8"x30" iron pin with attached 2" aluminum cap 28" in the ground, and surrounded monument with a small mound of stones. Cap is marked as shown below.

From which, I SET THE FOLLOWING REFERENCE POINTS:

- ▶ A 5/8"x30" iron pin bears S.37°58'E., 33.42 ft. with attached yellow plastic cap marked BENCHMARK SURVEYING
- ▶ A 5/8"x30" iron pin bears S.39°29'W., 46.56 ft. with attached yellow plastic cap marked BENCHMARK SURVEYING

Also attached a BT tag to a 3" diameter by 5 ft. tall Douglas fir stump which bears N.20°E., 4.5 feet.

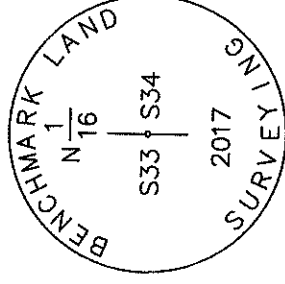

Used a total station to measure the reference points. Bearings are based on Baker County Survey No. 7-38-122. Set a steel U post alongside.

## **RESTORATION BY, STAMP AND DATE:**

Work Performed September 14, 2017 by:

Jason L. Hatfield, PLS

BENCHMARK LAND SURVEYING, INC.  
1207 Dewey Avenue  
Baker City, OR 97814  
(541)523-5852  
www.benchmarkis.com



*Jason L. Hatfield*  
OREGON  
NOVEMBER 30, 2007  
JASON L. HATFIELD  
#69454

EXPIRES: 6/30/2019

FILED October 3, 2017

BAKER COUNTY SURVEYOR

SURVEY NO. 7-38-129