

RECORD OF LAND CORNER MONUMENTATION

CORNER: CN 1/16 COR. SECTION 34, TWP. 7 S., RANGE 38 E., W.M.

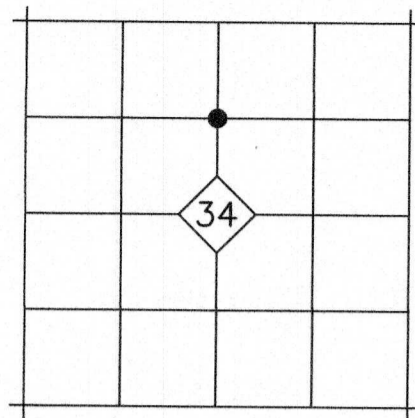

ORIGINAL DESCRIPTION: N/A

EVIDENCE FOUND: N/A

DESCRIPTION OF MONUMENTS AND ACCESSORIES SET AND METHODS USED:

At the corner point, as determined by survey, I set a 5/8"x30" iron pin 30" in the ground with attached 2" aluminum cap. Cap is marked as shown below. This corner falls on the west bank of an irrigation ditch

From which, I SET THE FOLLOWING REFERENCE POINTS:

- ▶ A 5/8"x30" iron pin bears S.89°20'W., 5.00 ft. with attached yellow plastic cap marked BENCHMARK SURVEYING
- ▶ A 5/8"x30" iron pin bears N.75°31'W., 31.12 ft. with attached yellow plastic cap marked BENCHMARK SURVEYING, set at the southwest corner of the concrete base of a cattleguard.



See Record Survey No. 7-38-122 for subdivision of Section 34

Used RTK GPS to measure the reference points.

RESTORATION BY, STAMP AND DATE:

Work Performed July 20, 2017 by:

Jason L. Hatfield, PLS

BENCHMARK LAND SURVEYING, INC.

1207 Dewey Avenue

Baker City, OR 97814

(541)523-5852

www.benchmarkls.com

FILED August 16, 2017
BAKER COUNTY SURVEYOR
SURVEY NO. 7-38-124

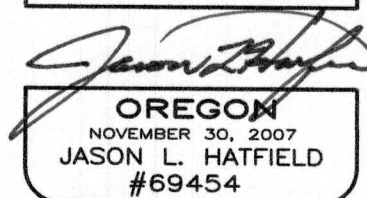
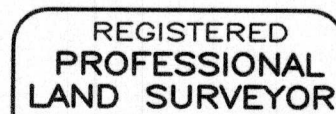

EXPIRES: 6/30/2019