

CERTIFIED RECORD OF LAND CORNER MONUMENTATION

History of original corner establishment:

Original corner set by William B. Barr, under GLO Contract No. 388, approved December 31, 1881.

Record states: Set stake 5 ft. long 5 in diam 24 in ground for corner to T6,7S R37,38E from which:
Tamarack, 12 in. diam., bears S 78° E, 16 lks. dist.
Tamarack, 22 in. diam., bears S 67° W, 30 lks. dist.
Tamarack, 24 in. diam., bears N 67° W, 20 lks. dist.
Tamarack, 8 in. diam., bears N 29° E, 53 lks. dist.

Subsequent Monumentation:

Corner remonumented by Lester E. Fischer and James J. Carlson, under BLM Group No. 350, approved June 13, 1977.

Record states: The cor. of T. 7 S., Rs. 37 and 38 E., determined at record bearing and distance from the remains of the original bearing trees:

- A western larch stump, 18 ins. diam., bears N. 29° E., 53 lks. dist., with healed blaze. (Record, 23 lks.)
- A western larch, 17 ins. diam., bears S. 78° E., 16 lks. dist., with scribe marks T7SR38E S visible on partially healed double blaze.
- A root hole, bears S. 67° W., 30 lks. dist.
- A western larch, 30 ins. diam., bears N. 67° W., 20 lks. dist., with scribe marks S R37E S36 visible on partially healed double blaze.

At the corner point: Set an iron post, 28 ins. long 2 1/2 ins. diam., 24 ins. in the ground, with brass cap mkd (as shown below), from which new bearing trees:

- A white fir, 10 ins. diam, bears N. 43° E., 228 lks. dist., mkd T6S R38E S31 BT.
- A fir, 8 ins. diam., bears N. 59° W., 27 lks. dist., mkd. T6S R37E S36 BT.

From this corner, a fence corner bears S. 75° E., 4 lks. dist., fences extend N. and E.

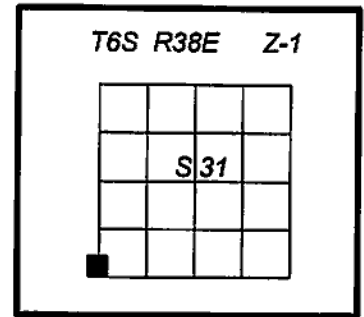

Description of corner evidence found:

Found 2 1/2 ins. diam. iron pipe, projecting 1 ins. above ground, with a standard BLM 3 1/4 ins. diam. brass cap, marked as shown:

From the recovered monument I find the original bearing trees and remains:

- A western larch stump of indeterminate size, bears N. 29° E., 53 lks dist. to face of blaze, no scribing visible.
- A western larch, 20 ins. diam., bears S. 78° E., 16 lks dist. to face, scribe marks visible on S'y side of open cat face, alive and healthy, with partially open blaze.
- Root depression, bears S. 67° W., 30 lks dist.
- A western larch, 30 ins. diam., bears N. 67° W., 20 lks dist. to face, alive and healthy, with scribe marks visible on partially open double blaze.

And accessories mkd. by Fischer:

- A 7' high fir cut stump, 10 ins. diam., bears N. 43° E., 228 lks dist., with healed blaze.
- A Douglas fir, 10 ins. diam., bears N. 59° W., 27 lks dist. to face, alive with healed blaze.

Found guard posts ±5 ft. N'ly with Property Boundary (54-2) and Attention (54-4) signs attached, and ±5 ft. E'ly with a Property Boundary (54-2) sign attached.

Ancient fence remains E and N of monument, no evidence of fence corner noted by BLM.

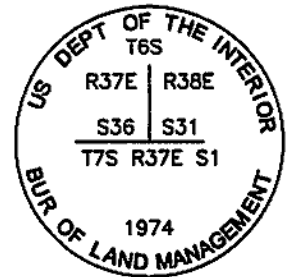

Description of monument and accessories I established to perpetuate original location of this corner:

New bearing tree:

A lodgepole pine, 6 ins. diam., bears N. 28° E., 18.3 ft. dist., mkd. X BT on double blaze.

New bearing tree marked on a single blaze unless noted otherwise and has a nail with a brass washer stamped "LS 2648" right side center for distance measurements.

Painted 6 ins. red bands and added Bearing Tree (54-3) and Land Survey Monument (54-9) signs as needed to all bearing trees.

Auto C/A geographic position:

Lat. 44°59'30.4" N
Long. 118°06'57.0" W

I hereby certify that the corner is monumented and accessories taken as described, using a Warren Knight staff compass, set with 15° East declination, and steel tape on September 11, 2014.

Witnesses: Brenda Johnson and Justin Seal

REGISTERED
PROFESSIONAL
LAND SURVEYOR

Deceased

OREGON
JANUARY 18, 1994
RON C. WALTER
2648

Renewal Date: June 30, 2016

REGISTERED
PROFESSIONAL
LAND SURVEYOR

William R. Wells

OREGON
July 22, 1977
WILLIAM R. WELLS
1106

Renewal Date: June 30, 2016

FILED Feb. 25, 2015

BAKER COUNTY SURVEYOR

SURVEY NO. 6-37-7

7-37-7

6-38-34

7-38-116

NOTE: See "Explanation for Successor Certifying Surveyor" statement in Narrative of Record of Survey, CS 6-38-28, filed concurrently with this Land Corner Record.

CERTIFIED RECORD OF LAND CORNER MONUMENTATION

History of original corner establishment:

Original corner set by Eugene P. McCormack, under GLO Contract No. 398, approved March 25, 1881.
Record states: Set post 4 ft long 4 ins. square 24 ins in the ground for cor. to secs. 7,12,13 and 18 marked: T7S S7 on NE, R38E S18 on SE, R37E S13 on SW, and S12 on NW faces with 2 notches on the N and 4 notches on the S edges. From which:
A fir, 20 ins. diam., bears N 35° E, 40 lks. dist., marked: T7S R38E S7 BT.
A pine, 8 ins. diam., bears S 50° E, 20 lks. dist., marked: T7S R38E S18 BT.
A fir, 7 ins. diam., bears S 55° W, 20 lks. dist., marked: T7S R37E S13 BT.
A fir, 30 ins. diam., bears N 55° W, 19 lks. dist., marked: T7S R37E S12 BT.

Subsequent Monumentation

Corner was rehabilitated by William R. Gradon, under GLO Contract No. 445, approved December 5, 1882.
Record states: A post 4 ins. square marked: T7S S7 on NE, R38E S18 on SE, R37E S13 on SW, and S12 on NW faces with 4 notches on the S and 2 notches on N edges. From which:
A fir, 20 ins. diam., bears N 35° E, 40 lks. dist., marked: T7S R38E S7 BT.
A pine, 8 ins. diam., bears S 50° E, 20 lks. dist., marked: T7S R38E S18 BT.
A fir, 7 ins. diam., bears S 55° W, 20 lks. dist., marked: T7S R37E S13 BT.
A fir, 30 ins. diam., bears N 55° W, 19 lks. dist., marked: T7S R37E S12BT.

Corner was remonumented by Lester E. Fischer and James J. Carlson, under BLM Group No. 350, approved June 13, 1977.
Record states: The cor. of secs. 7 and 18 only, on the W. bdy, of the Tp., determined at record distance from the remains of the original bearing trees:
A sawed fir stump, 25 ins. diam., bears N. 35° E., 40 lks. dist., no marks visible.
A fir, 15 ins. diam., bears S. 47½° W., 20 lks. dist., with healed double blaze. (Record, S. 55° W.)
A fir snag, 26 ins. diam., bears N. 59¼° W., 19 lks. dist., with scribe marks S R37 visible on partially healed blaze. (Record, N. 55° W.)
At the corner point: Set an iron post, 28 ins. long 2½ ins. diam., 24 ins. in the ground, with brass cap mkd (as shown below), from which new bearing trees:
A lodgepole pine, 6 ins. diam., bears N. 19¼° E., 25 lks. dist., mkd T7S R38E S7 BT.
A fir, 12 ins. diam., bears S. 27° E., 41 lks. dist., mkd. T7S R38E S18 BT.

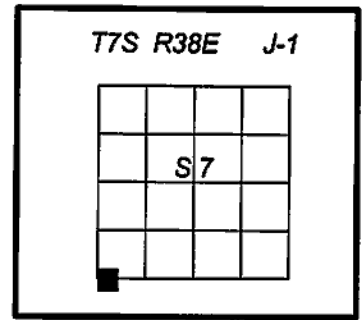

Corner was rehabilitated by J. David Brinton, LS 2065, as described by Survey No. 7-38-45, filed on February 15, 1985, in the records of the Baker County Surveyor.
Record states: Found 3" brass cap stamped (as shown below), on 2½" iron pipe with 4" above the ground.
Found original bearing trees as follows:
A sawed fir stump, 25 ins. diam., bears N35E., 40lks., dist., no marks.
A fir, 15 ins. diam., bears S47-3/4°W., 20 lks. dist., with healed double blaze. (Record S55W)
A fir snag, 26 ins. diam., bears N69-1/4W, 19 lks. dist., scribing reads S R37, on partially healed blaze. (Record N55W) this tree is down.
Found trees taken in 1975 by BLM as follows:
A lodgepole pine, 6" dia. live in good condition, bears N19-1/4E., 25 lks. scribed T7SR38ES7BT
A fir, 12" dia., live in good condition, bears S27E., 41 lks dist.scribed T7S R38E S18 BT

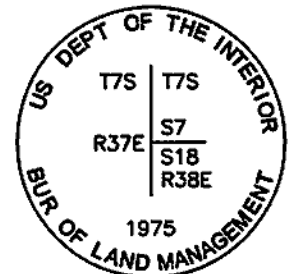

Description of corner evidence found:

Found 2½ ins. diam. iron pipe, projecting 1 in. above ground, with rock collar, and 3¼ ins. diam. standard BLM brass cap, marked as shown:
From the recovered monument I find the original bearing tree remains:
Stump remains, bear N. 35° E., 40 lks dist., no scribing visible.
A fir snag, 16 ins. diam., bears S. 47½° W., 20 lks dist., with healed double blaze
Fir remains, bear N. 69¼° W., 19 lks dist., dead and down, with visible scribe marks.
And accessories mkd. by Fischer:
A lodgepole pine, 6 ins. diam., bears N. 19¼° E., 25 lks dist., alive with full scribe visible on open blaze.
A stump hole with burned remains alongside, bears S. 27° E., 41 lks dist.
Other accessories of unknown origin:
1¼ ins. O. D. pipe, up 16 ins., 1.6 ft. Southerly

Found guard posts ±4 ft. S'ly with Property Boundary (54-2) and Attention (54-4) signs, and ±3 ft. N'ly with Property Boundary (54-2) sign attached.

REGISTERED
PROFESSIONAL
LAND SURVEYOR

Deceased

OREGON
JANUARY 18, 1994
RON C. WALTER
2648
Renewal Date: June 30, 2016

Description of monument and accessories I established to perpetuate original location of this corner:

New bearing trees:
A tamarack, 9 ins. diam., bears N. 72¼° E., 26.7 ft. dist., mkd. XBT.
A tamarack, 8 ins. diam., bears S. 66¼° E., 87.8 ft. dist., mkd. X BT on double blaze.
A Douglas fir, 15 ins. diam., bears S. 45¼° E., 86.8 ft. dist., mkd. T7S R38E S18 BT.

All new bearing trees are marked on a single blaze unless noted otherwise and have a nail with a brass washer stamped "LS 2648" right side center for distance measurements.

Painted 6 ins. red bands and added Bearing Tree (54-3) and Land Survey Monument (54-9) signs as needed to all bearing trees.

Auto C/A geographic position:
Lat. 44°57'46.0" N
Long. 118°06'58.5" W

REGISTERED
PROFESSIONAL
LAND SURVEYOR

William R. Wells

OREGON
July 22, 1977
WILLIAM R. WELLS
1106
Renewal Date: June 30, 2016

I hereby certify that the corner is monumented and accessories taken as described, using a Warren Knight staff compass, set with 15° East declination, and steel tape on September 5, 2014.

Witnesses: Kristina Powell, Brenda Johnson and Justin Seal

FILED Feb. 25, 2015
BAKER COUNTY SURVEYOR
SURVEY NO. 7-37-6
7-38-115

NOTE: See "Explanation for Successor Certifying Surveyor" statement in Narrative of Record of Survey, CS 7-38-107, filed concurrently with this Land Corner Record.

CERTIFIED RECORD OF LAND CORNER MONUMENTATION

History of original corner establishment:

Original corner set by Eugene P. McCormack, under GLO Contract No. 398, approved March 25, 1881.
 Record states: Set basalt stone 24x14x9 ins. 18 ins. in the ground for 1/4 sec cor. marked 1/4S on W face. From which:
 A pine, 12 ins. diam., bears N 55° E, 29 lks. dist., marked: 1/4S BT.
 A pine, 4 ins. diam., bears N 40° W, 20 lks. dist., marked: 1/4S BT.

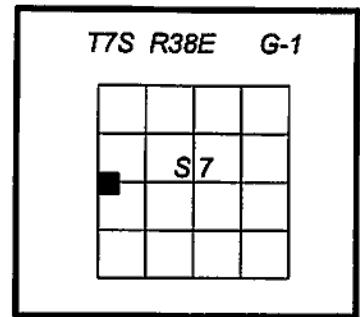

Subsequent Monumentation

Corner was remonumented by Lester E. Fischer and James J. Carlson, under BLM Group No. 350, approved June 13, 1977.
 Record states: The 1/4 sec. cor. of sec. 7 only, on the W. bdy. of the Tp., determined at record distance from the remains of the original bearing trees:
 A ponderosa pine, 22 ins. diam., bears N. 64 1/4° E., 29 lks. dist., with healed double blaze. (Record, N. 55°E.)
 A ponderosa pine snag, 13 ins. diam., bears N. 40° W., 20 lks. dist., with scribe marks 1/4 S BT visible on open blaze.
 At the corner point: Set an iron post, 28 ins. long 2 1/2 ins. diam., 24 ins. in the ground, with brass cap mkd (as shown below), from which a new bearing tree:
 A ponderosa pine, 11 ins. diam., bears S. 68° E., 26 1/2 lks. dist., mkd 1/4 S7 BT.

Corner was perpetuated by J. David Brinton, LS 2065, as described by Survey No. 7-38-43, filed February 15, 1985, in the records of the Baker County Surveyor.
 Record states: Found 3" brass cap monument, on 2 1/2" iron pipe. stamped (as shown below), set with 4" above the ground. Found original bearing trees as follows:
 A ponderosa pine, 22 ins. diam., bears N64-1/2E., 29lks., dist., with healed double blaze. (Record N55E), is live in good condition.
 A ponderosa pine, snag, 13 ins. diam., bears N40W., 20 lks. dist., with scribe marks 1/4 S BT. Found the bearing tree taken in 1975, A ponderosa pine, 11 ins. diam., dead and standing bears N55E., 27.12 lks, (Record S68E 26.5 lks.), scribing reads 1/4 S7 BT.
 Re scribed original bearing tree, a ponderosa pine 24" dia. bears. N 64-1/2E, 19.1 ft., scribed 1/4 S7 BT. nailed brass washer stamped PLS 2065 to blaze above BT scribe.
 Scribed a new bearing tree, a fir 6" dia. bears East 18.8 ft. scribed 1/4 S7 BT, painted a 6" red band around tree, nailed a brass washer above BT Scribe and nailed bearing tree and warning sign to back of tree taken in 1975..

Description of corner evidence found:

Found 2 1/2 ins. diam. iron pipe, flush with ground, with rock collar, and 3 1/4 ins. diam. standard BLM brass cap, marked as shown:
 From the recovered monument I find the original bearing trees:
 A ponderosa pine, 27 ins. diam., bears N. 55° E., 18.3 ft. dist., alive and healthy, with healed double blaze. (BLM record: N. 64 1/4° E., 29 lks. bearing matches GLO record, hold new distance)
 A rotting pine snag, bears N. 40° W., 16.3 ft. dist., with 1/4 S BT visible on open double blaze. (Record 20 lks)
 And accessories mkd. by Fischer:
 A rotting cut pine stump, bears S. 58° E., 20.5 ft. dist., no scribe marks legible on blaze. (BLM Record: S. 68° E. 26 1/2 lks; Brinton Record: N. 55° E., 27.12 lks.)
 And accessories mkd. by Brinton:
 A white fir, 13 ins. diam., bears N. 88° E., 18.8 ft. dist., alive and healthy, with healed blaze. (Record: East)

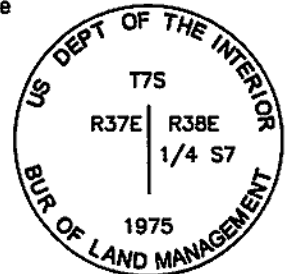

Found guard posts ±1.5 ft. S'ly with Property Boundary (54-2) and Attention (54-4) signs, and ±3 ft. N'ly with Attention (54-4) and Property Boundary (54-2) signs attached.

Description of monument and accessories I established to perpetuate original location of this corner:

New bearing trees:
 A tamarack, 9 ins. diam., bears N. 22° E, 26.1 ft. dist., mkd. 1/4 S7 BT.
 A tamarack, 12 ins. diam., bears S. 38 1/2° E, 50.2 ft. dist., mkd. 1/4 S7 BT.
 All new bearing trees are marked on a single blaze and have a nail with a brass washer stamped "LS 2648" right side center for distance measurements.
 Corner falls in 10 ft. wide logging road bearing N-S.
 Painted 6 ins. red bands and added Bearing Tree (54-3) and Land Survey Monument (54-9) signs as needed to all bearing trees. Did not alter existing bearing tree tags to reflect record changes.
 Auto C/A geographic position:
 Lat. 44°58'12.1" N
 Long. 118°06'57.1" W
 I hereby certify that the corner is monumented and accessories taken as described, using a Warren Knight staff compass, set with 15° East declination, and steel tape on September 5, 2014.
 Witnesses: Brenda Johnson

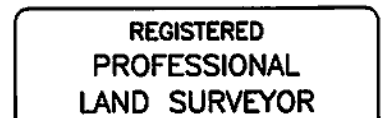

Deceased

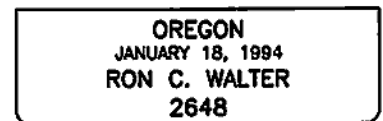

Renewal Date: June 30, 2016

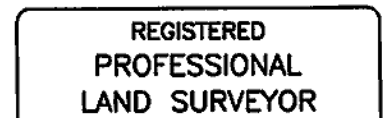

With R. Wells

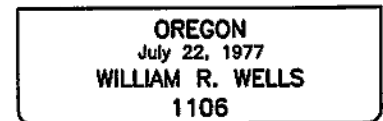

Renewal Date: June 30, 2016

FILED Feb. 25, 2015
 BAKER COUNTY SURVEYOR
 SURVEY NO. 7-37-5
7-38-114

NOTE: See "Explanation for Successor Certifying Surveyor" statement in Narrative of Record of Survey, CS 7-38-107, filed concurrently with this Land Corner Record.

CERTIFIED RECORD OF LAND CORNER MONUMENTATION

History of original corner establishment:

Original corner set by Eugene P. McCormack, under GLO Contract No. 398, approved March 25, 1881.

Record states: Set post 4 ft long 4 ins. square 24 ins in the ground for cor. to secs. 1, 6, 7, and 12. marked: T7S S6 on NE, R38E S7 on SE, R37E S12 on SW, and S1 on NW faces with 1 notch on the N and 5 notches on the S edges. From which:

- A fir, 14 ins. diam., bears N 80° E, 31 lks. dist., marked: T7S R38E S6 BT.
- A fir, 36 ins. diam., bears S 15° E, 18 lks. dist., marked: T7S R38E S7 BT.
- A hemlock, 18 ins. diam., bears S 65° W, 23 lks. dist., marked: T7S R37E S12 BT.
- A hemlock, 8 ins. diam., bears N 55° W, 15 lks. dist., marked: T7S R37E S1 BT.

Subsequent Monumentation

Corner was rehabilitated by William R. Gradon, under GLO Contract No. 445, approved December 5, 1882.

Record states: A post 4 ins. square marked: T7S S6 on NE, R38E S7 on SE, R37E S12 on SW, and S1 on NW faces with 5 notches on the S and 1 notch on N edges. From which:

- A fir, 14 ins. diam., bears N 80° E, 31 lks. dist., marked: T7S R38E S6 BT.
- A fir, 36 ins. diam., bears S 15° E, 18 lks. dist., marked: T7S R38E S7 BT.
- A hemlock, 18 ins. diam., bears S 65° W, 23 lks. dist., marked: T7S R37E S12 BT.
- A hemlock, 8 ins. diam., bears N 55° W, 15 lks. dist., marked: T7S R37E S1 BT.

Corner was remonumented by Lester E. Fischer and James J. Carlson, under BLM Group No. 350, approved June 13, 1977.

Record states: The cor. of secs. 6 and 7 only, on the W. bdy, of the Tp., determined at record bearing and distance from the remains of the original bearing trees:

- A fir stump, 34 ins. diam., bears N. 80° E., 31 lks. dist., with healed blaze.
- A decayed fir stump, 36 ins. diam., bears S. 15° E., 18 lks. dist., no marks visible.
- An Engelmann spruce snag, 30 ins. diam., bears S. 65° W., 23 lks. dist., with scribe marks 7S R37 S12 visible on partially healed double blaze. (Record, hemlock)
- A root hole, bears N. 55° W. 15 lks. dist., with a down Englemann spruce alongside, 17 ins. diam., with scribe marks T7S R37E S1 BT visible on partially healed double blaze. (Record, hemlock)

At the corner point: Set an iron post, 28 ins. long 2½ ins. diam., 16 ins. in the ground to bedrock and in a mound of stone, 4 ft. base, to top, with brass cap mkd (as shown below), from which new bearing trees:

- A western larch, 14 ins. diam, bears N. 64° E., 70 lks. dist., mkd T7S R38E S6 BT.
- A fir, 8 ins. diam., bears S. 50° E., 86 lks. dist., mkd. T7S R38E S7 BT.

Corner was rehabilitated by J. David Brinton, LS 2065, as described by Survey No. 7-38-39, filed February 15, 1985, in the records of the Baker County Surveyor.

Record states: Found 3" brass cap monument stamped (as shown below), set in a mound of stone. Found bearing trees as taken by the BLM, in 1974 as follows.

- A western larch, 14 ins. diam., bears N64E., 70lks., dist., mkd. T7S R38E S6 BT live in good condition.
 - A fir, 8 ins. diam., bears S50°E., 86 lks. dist., mkd T7S R38E S7 BT, live in good condition.
- Found the original bearing trees as described by the BLM in 1974.

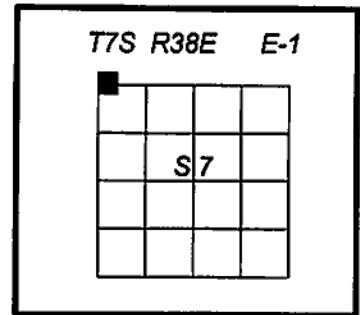

Description of corner evidence found:

Found 2½ ins. diam. iron pipe, leaning SWly, projecting 14 ins. above ground, with 4 ft. diam mound of stone, and standard BLM 3¼ ins. diam. brass cap marked as shown:

From the recovered monument I find the original bearing tree remains:

- Decayed fir stump of indeterminate size, bears N. 80° E., 31 lks dist., no scribing visible.
- A root hole, bears S. 15° E., 18 lks dist.

And accessories mkd. by Fischer:

- A western larch, 14 ins. diam., bears N. 64° E., 70 lks dist., alive and healthy, with healed blaze.
- A fir, 14 ins. diam., bears S. 50° E., 86 lks dist., alive and healthy, with healed blaze.

Found guard posts ±4 ft. S'y with Property Boundary (54-2) sign, and ±12 ft. N'y with Property Boundary (54-2) sign.

Description of monument and accessories I established to perpetuate original location of this corner:

Using distance-distance intersection from found live bearing trees, straightened monument and rebuild rock mound.

New bearing trees:

- An Englemann spruce, 7 ins. diam., bears N. 25½° E, 15.6 ft. dist., mkd. T7S R38E S6 BT.
- A tamarack, 11 ins. diam., bears S. 29½° E, 14.4 ft. dist., mkd. T7S R38E S7 BT.

All new bearing trees are marked on a single blaze and have a nail with a brass washer stamped "LS 2648" right side center for distance measurements.

Painted 6 ins. red bands and added Bearing Tree (54-3) and Land Survey Monument (54-9) signs as needed to all bearing trees.

Added Land Survey Monument (54-9) sign to S'y guard post.

A 1.5 ft wide by 5 ins. deep creek coursing N. 24° E. is 4 ft N. of monument.

Auto C/A geographic position:

- Lat. 44°58'38.5" N
- Long. 118°06'57.5" W

I hereby certify that the corner is monumented and accessories taken as described, using a Warren Knight staff compass, set with 15° East declination, and steel tape on September 9, 2014.

Witnesses: Brenda Johnson and Justin Seal

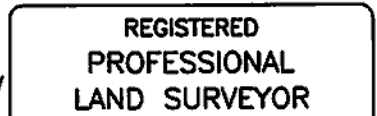

Deceased

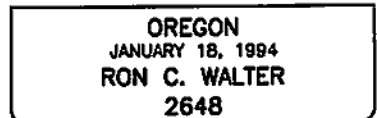

Renewal Date: June 30, 2016

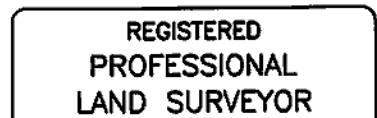

Will. R. Wells

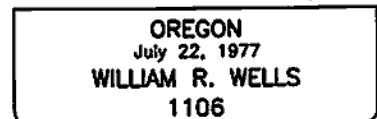

Renewal Date: June 30, 2016

FILED Feb. 25, 2015
 BAKER COUNTY SURVEYOR
 SURVEY NO. 7-37-4
7-38-113

NOTE: See "Explanation for Successor Certifying Surveyor" statement in Narrative of Record of Survey, CS 7-38-107, filed concurrently with this Land Corner Record.

CERTIFIED RECORD OF LAND CORNER MONUMENTATION

History of original corner establishment:

Corner set by J. David Brinton, LS 2065, as described by Survey No. 7-38-37, filed on February 15, 1985, in the records of the Baker County Survey.
Record states: Set 2-1/2" aluminum pipe with 2-1/2" aluminum cap stamped as shown (below), set 16" in the ground and raised a mound of stone and earth around the pipe. From which:
A pine, 20 ins. dia. bears West, 12.7 ft. scribed C1/4 S5 BT
A pine, 14 ins. dia., bears N83E., 63.2 ft. scribed C1/4 S5 BT

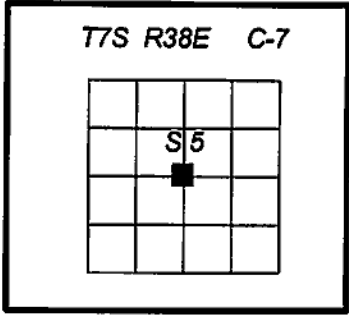

Description of corner evidence found:

Found 2½ ins. diam. alum. pipe, projecting 6 ins. above ground, with rock collar, and 2½ ins. diam. alum. cap, marked as shown:
From the recovered monument I find the Brinton bearing trees:
A ponderosa pine, 24 ins. diam., bears West, 12.7 ft. dist., alive with healed blaze.
A ponderosa pine, 23 ins. diam., bears N. 83° E., 63.2 dist. to face, alive and healthy, with scribing visible on partially open blaze.

Found guard posts ±5 ft. W'ly with Property Boundary (54-2) sign, and ±4 ft. N'ly with Property Boundary (54-2) and Attention (54-4) signs attached.

E-W barbed wire fence ±75 ft. south.

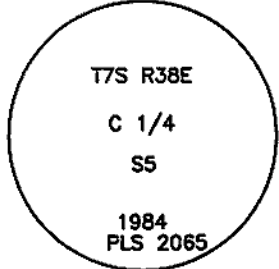

Description of monument and accessories I established to perpetuate original location of this corner:

New bearing trees:
A ponderosa pine, 10 ins. diam., bears S. 68° E., 137.0 ft. dist., mkd. X BT on double blaze for longevity and visibility.
A ponderosa pine, 17 ins. diam., bears S. 32° W., 46.9 ft. dist., mkd. C1/4 S5 BT.

All new bearing trees are marked on a single blaze unless noted otherwise and have a nail with a brass washer stamped "LS 2648" right side center for distance measurements.

Painted 6 ins. red bands and added bearing Tree (54-3) and Land Survey Monument (54-9) signs as needed to all bearing trees.

Auto C/A geographic position:
Lat. 44°59'07.2" N
Long. 118°05'06.7" W

I hereby certify that the corner is monumented and accessories taken as described, using a Warren Knight staff compass, set with 15° East declination, and steel tape on September 4, 2014.

Witnesses: Kristina Powell, Brenda Johnson and Justin Seal

REGISTERED
PROFESSIONAL
LAND SURVEYOR

Deceased

OREGON
JANUARY 18, 1894
RON C. WALTER
2648

Renewal Date: June 30, 2016

REGISTERED
PROFESSIONAL
LAND SURVEYOR

William R. Wells

OREGON
July 22, 1977
WILLIAM R. WELLS
1106

Renewal Date: June 30, 2016

FILED Feb. 25, 2015
BAKER COUNTY SURVEYOR
SURVEY NO. 7-38-112

NOTE: See "Explanation for Successor Certifying Surveyor" statement in Narrative of Record of Survey, CS 7-38-107, filed concurrently with this Land Corner Record.

CERTIFIED RECORD OF LAND CORNER MONUMENTATION

History of original corner establishment:

Corner set by William Hanley, LS 1639, as described by Survey No. 7-38-20, filed November 18, 1981, in the records of the Baker County Surveyor.
Record states: Set 5/8" x 30" rebar.

Subsequent Monumentation

Corner was perpetuated by J. David Brinton, LS 2065, as described by Survey No. 7-38-36, on February 15, 1985, in the records of the Baker County Surveyor.
Record states: Found 5/8" steel pin with plastic cap stamped HANLEY ENG, set on the westerly edge of Anthony Lakes Highway. No accessories originally established.
Accepted the said 5/8" pin with plastic cap as the 1/16 cor. Since it falls in the roadway the pin is not disturbed and is used to mark the true corner position. From which: Set 2-1/2" aluminum pipe with 2-1/2" aluminum cap stamped as shown (below). Set 26" in the ground for reference monument, bears XXX 57° 04'W, 40.0 ft. from the said pin.
A Pine, 16" dia. bears N82 52'W., 46.5 ft from said pin, scribed C-W1/16 S5 BT
A Pine, 8" dia. bears S82 56'W., 78.6 ft. from said pin, scribed C-W1/16 S5 BT

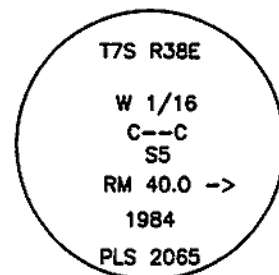
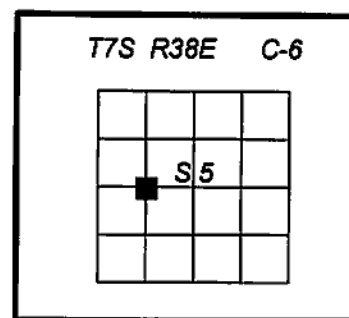

Description of corner evidence found:

Found 5/8 ins. diam. rebar with a yellow plastic cap stamped "Hanley Eng. LS 1817", flush with asphalt in Anthony Lakes Highway.

From the recovered monument I find the Brinton bearing trees:

A ponderosa pine, 15 ins. diam., bears S. 83° W, 78.6 ft. dist., alive and healthy, with visible scribe on partially healed blaze.

A cut pine stump, 23 ins. diam., bears N. 83 W., 46.5 ft. dist., with partially healed blaze.

Highway has been widened, did not find 2 1/2" alum. pipe in 50 ft. radius of pin in highway.

Found guard posts out of ground near cut bearing tree stump with Property Boundary (54-2) and Attention (54-4) signs attached.

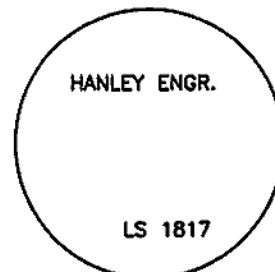

Description of monument and accessories I established to perpetuate original location of this corner:

New accessory:

A 1" BXO chiseled in SW'ly face of rock cliff in cut bank of Anthony Lakes Highway, bears N. 36° E., 59.1 ft. dist.

Painted 6 ins. red bands and added Bearing Tree (54-3) and Land Survey Monument (54-9) signs as needed to all bearing trees.

Set guard posts ±80 ft west at top of cut bank with Property Boundary (54-2) sign and ±100 ft. east at bottom of road shoulder with Property Boundary (54-2) sign attached.

Auto C/A geographic position:

Lat. 44°59'06.9" N
Long. 118°05'25.6" W

I hereby certify that the corner is monumented and accessories taken as described, using a Warren Knight staff compass, set with 15° East declination, and steel tape on September 4, 2014.

Witnesses: Kristina Powell, Brenda Johnson and Justin Seal

REGISTERED
PROFESSIONAL
LAND SURVEYOR

Deceased

OREGON
JANUARY 18, 1994
RON C. WALTER
2648

Renewal Date: June 30, 2016

REGISTERED
PROFESSIONAL
LAND SURVEYOR

William R. Wells

OREGON
July 22, 1977
WILLIAM R. WELLS
1106

Renewal Date: June 30, 2016

FILED Feb. 25, 2015
BAKER COUNTY SURVEYOR
SURVEY NO. 7-38-111

NOTE: See "Explanation for Successor Certifying Surveyor" statement in Narrative of Record of Survey, CS 7-38-107, filed concurrently with this Land Corner Record.

CERTIFIED RECORD OF LAND CORNER MONUMENTATION

History of original corner establishment:

Original corner set by William R. Gradon, under GLO Contract No. 445, approved December 5, 1882.

Record states: Set a basalt stone 18x10x6 ins. 12 ins. in the ground for the 1/4 sec. cor., marked 1/4 on W face, from which:

- A pine, 36 ins. diam., bears S 80° E, 30 lks. dist., marked: 1/4S BT.
- A pine, 36 ins. diam., bears N 87° W, 90 lks. dist., marked: 1/4S BT.

Subsequent Monumentation

Corner was remonumented by Lester E. Fischer and James J. Carlson, under BLM Group No. 350, approved June 13, 1977.

Record states: The 1/4 cor. of secs. 5 and 6, monumented with a mound of stone, 1 1/2 ft. base, 6 ins. high, from which the remains of the original bearing trees:

- A ponderosa pine snag, 38 ins. diam., bears S. 80° E., 30 lks. dist., with scribe marks 1/4 S BT visible on open double blaze.
 - A ponderosa pine stump, 36 ins. diam., bears N. 87° W., 90 lks. dist., no marks visible.
- At the corner point: Set an iron post, 28 ins. long 2 1/2 ins. diam., 20 ins. in the ground, to bedrock, and in a mound of stone, 2 ft. base, to top, with brass cap mkd (as shown below), from which new bearing trees:
- A ponderosa pine, 11 ins. diam, bears N. 34° E., 13 1/2 lks. dist., mkd 1/4 S5 BT.
 - A ponderosa pine, 10 ins. diam., bears S. 67° W., 5 lks. dist., mkd. 1/4 S6 BT.

Corner was rehabilitated by J. David Brinton, LS 2065, as described by Survey No. 7-38-35, filed on February 15, 1985, in the records of the Baker County Surveyor.

Record states: Found 2-1/2" iron pipe with 3" brass cap stamped (as shown below), set with 6" above the ground. Found original bearing trees taken in 1882.

- A ponderosa pine snag, 38 ins. diam., bears S.80E., 30 lks., dist., with scribe marks 1/4S BT visible on open double blaze.
 - A ponderosa pine stump, 36 ins. diam., bears N.87W., 90 lks. dist., no marks visible.
- Found trees taken by the BLM, in 1974.
- A ponderosa pine, 12 ins. diam., bears N.34E, 13-1/2 lks. dist. mkd. 1/4 S5BT
 - A ponderosa pine, 11 ins. diam., bears S.67W., 5 lks. dist. mkd 1/4 S6 BT. Both the trees as taken by the BLM , are live in good condition.

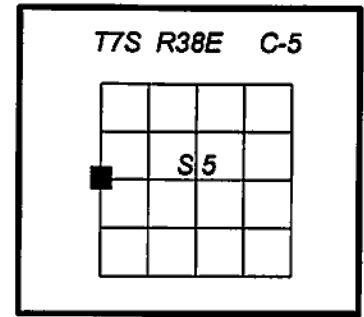

Description of corner evidence found:

Found 2 1/2 ins. diam. iron pipe, projecting 6 ins. above ground, with rock collar, and standard BLM 3 1/4 ins. diam. brass cap, marked as shown:

From the recovered monument I find the original bearing tree remains:

- A ponderosa pine snag, 38 ins. diam., bears S. 80° E., 30 lks dist. to face, with full scribe visible on open blaze.
 - A decayed pine stump, bears N. 87° W., 90 lks dist., no scribing visible.
- And accessories mkd. by Fischer:
- A root hole, bears N. 34° E., 13 1/2 lks. dist., with ponderosa pine remains alongside and full scribe visible on open blaze.
 - A ponderosa pine, 13 ins. diam., bears S. 67° W., 5 lks dist., alive and healthy, with healed blaze.

Found guard posts ±3 ft. E'ly with Property Boundary (54-2) sign, and ±2.5 ft. N'ly with Property Boundary (54-2) and Attention (54-4) signs attached.

Found fence remains in area around monument.

Description of monument and accessories I established to perpetuate original location of this corner:

New bearing trees:

- A ponderosa pine, 10 ins. diam., bears N. 43° E., 78.8 ft. dist., mkd. XBT.
- A ponderosa pine, 12 ins. diam., bears S. 23 1/2° E., 59.3 ft. dist., mkd. 1/4 S5 BT.
- A ponderosa pine, 13 ins. diam., bears N. 34 1/2° W., 65.2 ft. dist., mkd. 1/4 S6 BT.

All new bearing trees are marked on a single blaze and have a nail with a brass washer stamped "LS 2648" right side center for distance measurements.

Painted 6 ins. red bands and added Bearing Tree (54-3) and Land Survey Monument (54-9) signs as needed to all bearing trees.

Auto C/A geographic position:

- Lat. 44°59'06.7" N
- Long. 118°05'44.7" W

I hereby certify that the corner is monumented and accessories taken as described, using a Warren Knight staff compass, set with 15° East declination, and steel tape on September 2, 2014.

Witnesses: Kristina Powell, Brenda Johnson and Justin Seal

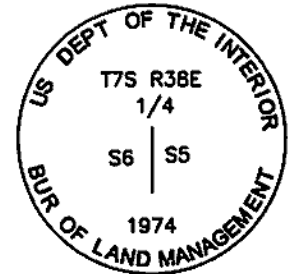

REGISTERED
PROFESSIONAL
LAND SURVEYOR

Deceased

OREGON
JANUARY 18, 1994
RON C. WALTER
2648

Renewal Date: June 30, 2016

REGISTERED
PROFESSIONAL
LAND SURVEYOR

William R. Wells

OREGON
July 22, 1977
WILLIAM R. WELLS
1106

Renewal Date: June 30, 2016

FILED Feb. 25, 2015
BAKER COUNTY SURVEYOR
SURVEY NO. 7-38-110

NOTE: See "Explanation for Successor Certifying Surveyor" statement in Narrative of Record of Survey, CS 7-38-107, filed concurrently with this Land Corner Record.

CERTIFIED RECORD OF LAND CORNER MONUMENTATION

History of original corner establishment:

Original corner set by Eugene P. McCormack, under GLO Contract No. 398, approved March 25, 1881.
Record states: Set post 3 ft long 3 ins square 24 ins in the ground for 1/4 sec cor marked 1/4 S on W face. From which:
A Hemlock, 8 ins. diam., bears N 50° E, 25 lks. dist., marked: 1/4S BT.
A Hemlock, 10 ins. diam., bears N 80° W, 13 lks. dist., marked: 1/4S BT.

Subsequent Monumentation

Corner was remonumented by Lester E. Fischer and James J. Carlson, under BLM Group No. 350, approved June 13, 1977.
Record states: The 1/4 sec. cor. of sec. 6 only, on the W. bdy. of the Tp., determined at record bearing and distance from the remains of the original bearing trees:
A root hole, bears N. 50° E., 25 lks. dist., with a down fir alongside, size indeterminate, with scribe marks 1/4 S visible on open blaze. (Record, hemlock).
At the corner point: Set an iron post, 28 ins. long 2 1/2 ins. diam., 20 ins. in the ground, to bedrock, with brass cap mkd (as shown below), from which a new bearing trees:
A white fir, 6 ins. diam, bears N. 78 1/2° E., 49 lks. dist., mkd X BT.
A white fir, 8 ins. diam, bears S. 46 1/2° E., 25 lks. dist., mkd 1/4 S6 BT.

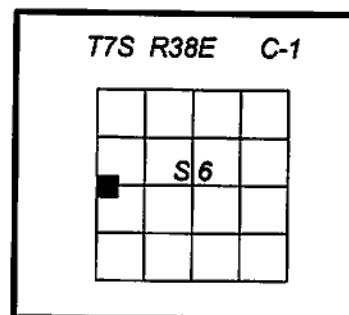

Corner was rehabilitated by J. David Brinton, LS 2065, as described by Survey No. 7-38-34, filed February 15, 1985, in the records of the Baker County Surveyor.
Record states: Found 3" brass cap monument, on 2 1/2" iron pipe set 8" above the ground with cap stamped (as shown below).
Found a white fir, 7" dia., bears N78-1/2E, 32.3 ft. blaze open scribe reads X BT
Found a white fir, 8" dia., bears S46/1/4E [sic], 16.5 ft. dist., blaze open scribe reads 1/4 S6 BT.
Both trees live in good condition. Found remains of original bearing trees as described by the BLM.

Description of corner evidence found:

Found 2 1/2 ins. diam. iron pipe, projecting 8 ins. above ground, no rocks in area for mound, with standard BLM 3 3/4 ins. diam. brass cap, marked as shown:

From the recovered monument I find the Fischer bearing trees:

- A white fir stump, bears N. 78 1/2° E., 32.3 ft. dist. to face, with remains alongside and "1/4 S6 BT" visible on an open blaze.
- A white fir, 15 ins. diam. bears S. 46 1/2° E., 16.5 ft. dist. to face, alive and healthy, with healed blaze.

Found guard posts ±5 ft. S'ly with Property Boundary (54-2) sign and ±5 ft. N'ly with Attention (54-4) and Property Boundary (54-2) signs attached.

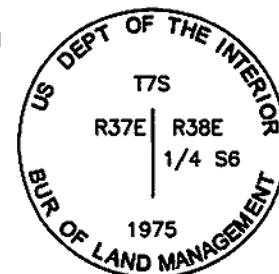

Description of monument and accessories I established to perpetuate original location of this corner:

New bearing trees:

- An Englemann spruce, 7 ins. diam., bears N. 31° E., 40.1 ft. dist., mkd. 1/4 S6 BT.
- An Englemann spruce, 6 ins. diam., bears N. 51° E, 49.6 ft. dist., mkd. X BT on double blaze.
- A white fir, 10 ins. diam., bears S. 81° E., 31.0 ft. dist., mkd. 1/4 S6 BT.

All new bearing trees are marked on a single blaze unless noted otherwise and have a nail with a brass washer stamped "LS 2648" right side center for distance measurements.

Centerline of 2.5 ft. wide 6 ins. deep, Deer Creek courses E'ly ±15ft North of monument.

Painted 6 ins. red bands and added Bearing Tree (54-3) and Land Survey Monument (54-9) signs as needed to all bearing trees.

Auto C/A geographic position:

Lat. 44°59'04.3" N
Long. 118°08'56.7" W

I hereby certify that the corner is monumented and accessories taken as described, using a Warren Knight staff compass, set with 15° East declination, and steel tape on September 10, 2014.

Witnesses: Brenda Johnson and Justin Seal

REGISTERED
PROFESSIONAL
LAND SURVEYOR

Deceased

OREGON
JANUARY 18, 1994
RON C. WALTER
2648

Renewal Date: June 30, 2016

REGISTERED
PROFESSIONAL
LAND SURVEYOR

William R. Wells

OREGON
July 22, 1977
WILLIAM R. WELLS
1106

Renewal Date: June 30, 2016

FILED Feb. 25, 2015

BAKER COUNTY SURVEYOR

SURVEY NO. 7-37-3

7-38-109

NOTE: See "Explanation for Successor Certifying Surveyor" statement in Narrative of Record of Survey, CS 7-38-107, filed concurrently with this Land Corner Record.

CERTIFIED RECORD OF LAND CORNER MONUMENTATION

History of original corner establishment:

Original corner set by William B. Barr under GLO Contract No. 388, approved December 31, 1881.
Record states: Set stake 4 ft. long, 4 in. diam. 18 in ground for 1/4 sec corner from which:
Tamarack, 18 in. diam., bears S 60° W, 8 lks. dist.
Tamarack, 20 in. diam., bears N 65° W, 18 lks. dist.

Subsequent Monumentation

William L. Hanley, LS 1639, stated that he found a 1 in. diam. iron pipe, as described by Survey No. 7-38-20, filed November 18, 1981, in the records of the Baker County Surveyor, and used said pipe to subdivide Section 5.

Corner was ACCEPTED and remonumented by J. David Brinton, LS 2065, as described by Survey No. 7-38-20, filed February 15, 1985, in the records of the Baker County Surveyor.
Record states: Found a 1" iron pin, set approx. 20 ft. west from edge of Anthony Lakes Highway.
No evidence of original stake found, road work and fencing in the area have destroyed all traces. The original bearing trees have been lost to road work and fencing in the area.
Because of a logical acceptance of the 1" iron pin by the previous surveyors it is accepted as the best available evidence of a perpetuation of the original corner position.
Set 2-1/2" aluminum pipe with 2-1/2" aluminum cap stamped as shown (below), set 28" in the ground. Set the 1" iron pin alongside pipe. From which:
A Pine, 18" dia., bears N57E., 26.3 ft. scribed 1/4 S32 BT
A Pine, 12" dia., bears S36W., 18.7 ft. scribed 1/4 S5 BT

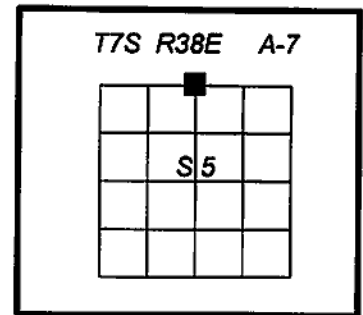

Description of corner evidence found:

Found 2 1/2 ins. diam. alum. pipe, projecting 3 ins. above ground, with 1" iron pin alongside and a 2 1/2 ins. diam. alum. cap, marked as shown:

Found guard posts ±4 ft. S'ly with Property Boundary (54-2) sign, and ±3.5 ft. W'ly with Property Boundary (54-2) and Attention (54-4) signs attached.

Centerline of Anthony Lakes Highway is ±45 ft. S'ly.

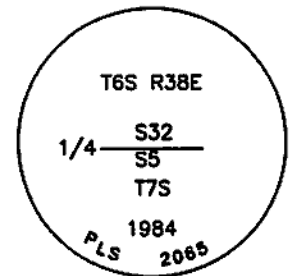

Description of monument and accessories I established to perpetuate original location of this corner:

New bearing trees:

- A ponderosa pine, 11 ins. diam., bears N. 10° E., 54.1 ft. dist., mkd. 1/4 S32 BT.
- A ponderosa pine, 9 ins. diam., bears S. 8 1/2° E., 96.2 ft. dist., mkd. 1/4 S5 BT.
- A Douglas fir, 13 ins. diam., bears S. 66 1/2° W., 129.6 ft. dist., mkd. 1/4 S5 BT.
- A tamarack, 16 ins. diam., bears N. 48° W., 55.4 ft. dist., mkd. 1/4 S32 BT.

All new bearing trees are marked on a single blaze and have a nail with a brass washer stamped "LS 2648" right side center for distance measurements.

Painted 6 ins. red bands and added Bearing Tree (54-3) and Land Survey Monument (54-9) signs as needed to all bearing trees.

Auto C/A geographic position:

Lat. 44°59'31.6 N
Long. 118°05'05.5" W

I hereby certify that the corner is monumented and accessories taken as described, using a Warren Knight staff compass, set with 15° East declination, and steel tape on September 2, 2014.

Witnesses: Kristina Powell, Brenda Johnson and Justin Seal

REGISTERED
PROFESSIONAL
LAND SURVEYOR

Deceased

OREGON
JANUARY 18, 1984
RON C. WALTER
2648

Renewal Date: June 30, 2016

REGISTERED
PROFESSIONAL
LAND SURVEYOR

Will R. Wells

OREGON
July 22, 1977
WILLIAM R. WELLS
1106

Renewal Date: June 30, 2016

FILED Feb. 25, 2015
BAKER COUNTY SURVEYOR
SURVEY NO. 6-38-35
7-38-108

NOTE: See "Explanation for Successor Certifying Surveyor" statement in Narrative of Record of Survey, CS Nos. 6-38-28 and 7-38-107, filed concurrently with this Land Corner Record.

CERTIFIED RECORD OF LAND CORNER MONUMENTATION

History of original corner establishment:

Original corner set by Eugene P. McCormack, under GLO Contract No. 398, approved March 25, 1881.
Record states: Set post 4 1/4 ft long, 4 ins. square, 24 ins in the ground for closing cor. to T7S Rs 37 and 38 East marked: C.C. T7S on S, R38E S6 on E, R37E S1 on W faces with 6 notches on SE and W faces. From which:
A pine, 14 ins. diam., bears N 10° E, 18 lks. dist., marked: T6S R38E S31 BT.
A fir, 12 ins. diam., bears S 35° E, 25 lks. dist., marked: T7S R38E S6 BT.
A fir, 8 ins. diam., bears S 60° W, 48 lks. dist., marked: T7S R37E S1 BT.

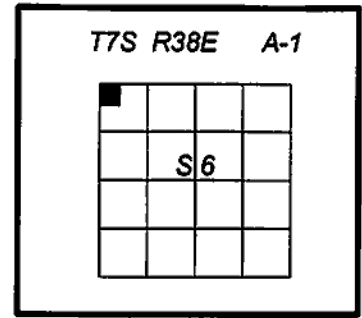

Subsequent Monumentation

Corner was reestablished by J. David Brinton, LS 2065, as described by Survey No. 7-38-29, filed on February 15, 1985, in the records of the Baker County Surveyor.
Record states: Found the remains of the original post from, 1' to 2' below ground level. All traces of the original bearing trees have been lost to fencing and logging activity in the area. Accepted remains of post as the original corner position and set Closing Corner S 3 27' 22"W along the line established between the found post and the W 1/4 cor. of sec. 6, a distance of 3.45 ft. to an intersection with the Twp. line between T6&7S, as established between the Standard Cor. bet. Sec. 36/31, T6S, R37&38E and the Corner to Secs. 31/32/5/6, T6&7S R38E. Set 2-1/2" aluminum pipe with 2-1/2" aluminum cap stamped as shown (below), set 28" in the ground. From which:
A pine, 6" dia. bears N 47E., 34.5 ft. scribed T6S R38E S31 CC BT.
A tamarack 8" dia. bears S81E., 19.4 ft. scribed T7S R38E S6 CC BT.

Description of corner evidence found:

Found 2 1/2 ins. diam. alum. pipe, projecting 1 in. above ground, with 2 1/2 ins. diam. alum. cap marked as shown:
From the recovered monument I find the Brinton bearing trees:
Root hole, bears N. 47° E., 34.5 ft. dist., found pine remains out of position with full scribe.
A tamarack, bears S. 81° E., 19.4 ft. dist., alive and healthy, with healed blaze.
Found guard posts ±3 ft. S'ly with Property Boundary (54-2) and Attention (54-4) signs, and ±2 ft. W'ly with Property Boundary (54-2) sign attached.

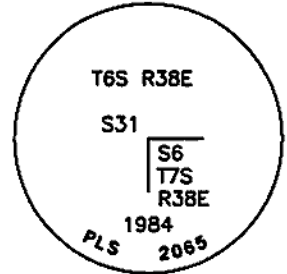

Description of monument and accessories I established to perpetuate original location of this corner:

New bearing trees:
A white fir, 13 ins. diam., bears S. 16° E, 47.1 ft. dist., mkd. CC XBT.
A tamarack, 10 ins. diam., bears S. 37 1/2° W, 37.2 ft. dist., mkd. XBT.
A white fir, 7 ins. diam., bears S. 57 1/2° W., 8.0 ft. dist., mkd. X BT on double blaze.
Two new bearing trees are in the unsurveyed township to provide good geometry to the monument.
All new bearing trees are marked on a single blaze unless noted otherwise and have a nail with a brass washer stamped "LS 2648" right side center for distance measurements.
Painted 6 ins. red bands and added Bearing Tree (54-3) and Land Survey Monument (54-9) signs as needed to all bearing trees.
A 10 ft. wide E-W logging road is ±10 ft. North and a 15 ft. wide overhead utility access road is ±40 ft. North.
Auto C/A geographic position:
Lat. 44°59'30.6" N
Long. 118°06'54.4" W

I hereby certify that the corner is monumented and accessories taken as described, using a Warren Knight staff compass, set with 15° East declination, and steel tape on September 11, 2014.

Witnesses: Brenda Johnson

REGISTERED
PROFESSIONAL
LAND SURVEYOR

Deceased

OREGON
JANUARY 18, 1994
RON C. WALTER
2648

Renewal Date: June 30, 2016

REGISTERED
PROFESSIONAL
LAND SURVEYOR

William R. Wells

OREGON
July 22, 1977
WILLIAM R. WELLS
1106

Renewal Date: June 30, 2016

FILED Feb. 25, 2015
BAKER COUNTY SURVEYOR
SURVEY NO. 7-37-2
7-38-107

NOTE: See "Explanation for Successor Certifying Surveyor" statement in Narrative of Record of Survey, CS 7-38-107, filed concurrently with this Land Corner Record.