

# CORNER RESTORATION

**CORNER:** SE COR. SEC. 24, TWP. 7 S., RANGE 38 E., W.M.

**ORIGINAL SURVEY BY:** Timothy W. Davenport, U.S. Deputy Surveyor

**CONTRACT NUMBER:** 102

**CONTRACT DATE:** July 20, 1863

**SUBSEQUENT SURVEYS:** Record Map of Survey No. 7-38-99 by Tom Hanley, PLS, filed Dec. 1, 2012 in the Baker County Surveyor's Office

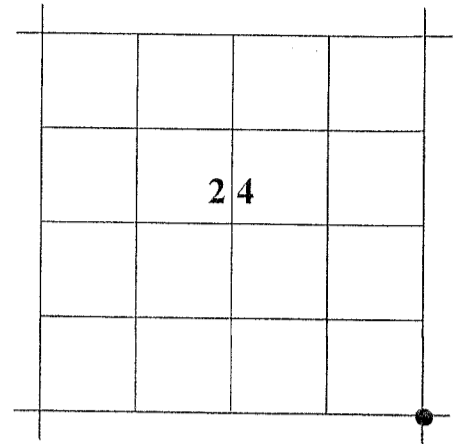

**ORIGINAL DESCRIPTION:** Set post corner to Secs 19, 30, 24 & 25 made mound of earth and drove charred stake as per inst.

Record Map of Survey No. 7-38-99: For the subdivision of Section 24, Mr. Hanley accepted the intersection of fences that run South and East for the section corner but did not monument the position.

**EVIDENCE FOUND:** I found no remaining evidence of the post or earth mound. At the intersection of fences extending South and East, I found a bridge spike driven into the ground. I also found a similar bridge spike at the fence intersection at the NE Corner Section 24. It soon became apparent that these were set during Record Survey No. 7-38-99, as the bearing and distance between the found spikes conformed to Mr. Hanley's record. I spoke with Mr. Hanley who confirmed this as fact. Therefore, I accept the bridge spike and fence intersection as the best available evidence of the Section Corner.

## DESCRIPTION OF MONUMENTS AND ACCESSORIES SET AND METHODS USED:

At the corner point, I removed the bridge spike and in its place I set a 5/8"x30" iron pin with attached 2" Aluminum cap 29" in the ground. Aluminum cap marked as shown:

## From which, I SET THE FOLLOWING REFERENCE POINTS:

- ▶ A 5/8"x30" iron pin bears N.00°35'E., 24.70 ft. with attached yellow plastic cap marked BENCHMARK SURVEYING.
- ▶ A 5/8"x30" iron pin bears N.87°24'E., 17.26 ft. with attached yellow plastic cap marked BENCHMARK SURVEYING.
- ▶ A 5/8"x30" iron pin bears S.00°35'E., 18.32 ft. with attached yellow plastic cap marked BENCHMARK SURVEYING.
- ▶ A 5/8"x30" iron pin bears S.89°47'W., 30.50 ft. with attached yellow plastic cap marked BENCHMARK SURVEYING.

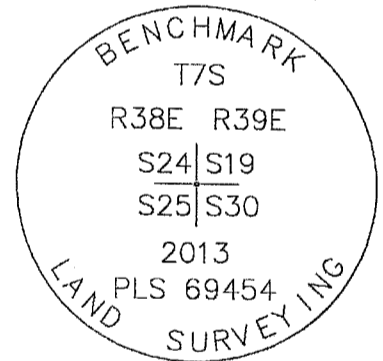

Used RTK GPS to measure the reference points. Bearings are based on Record Map of Survey No. 7-38-104.

## RESTORATION BY, STAMP AND DATE:

Work performed November 6, 2013 by Jason L. Hatfield, PLS

Benchmark Land Surveying, Inc.  
2101 Main Street  
Baker City, OR 97814  
(800) 699-0516

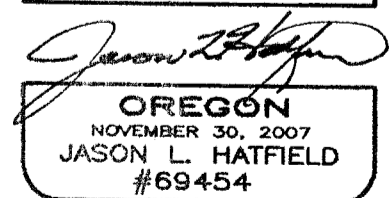
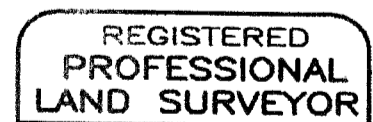

EXPIRES: 6/30/2015

FILED Nov. 13, 2013

BAKER COUNTY SURVEYOR

SURVEY NO. 7-38-106 / 7-39-69 (R-1)