

RECORD OF LAND CORNER MONUMENTATION

NORTHEAST 1/16 CORNER SECTION 27, T. 6 S., R. 45 E., W.M.

ORIGINALLY ESTABLISHED BY: Duane I. Griffith, PLS 644 in 1982. See Map of Survey filed September 16, 1983 in the Baker County Surveyor's office as Survey No. 6-45-32, and corner monumentation record filed September 16, 1983 as Survey No. 6-45-125

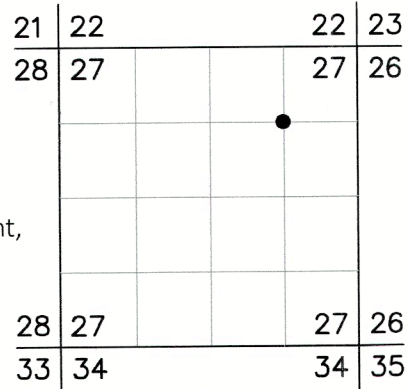

SUBSEQUENT SURVEYS:

- ▶ Survey by Philip G. Griffin, Cadastral Surveyor for the Bureau of Land Management, completed August 30, 1994, approved July 7, 1997 under Group No. 1650

GRIFFITH'S DESCRIPTION: At corner position I set a 2½"x30" aluminum pipe with aluminum cap marked as shown 27 inches in the ground from which:

NEW BTs

- A 16 in diam white fir bears S59°E 22.1 feet marked NE1/16 S27 BT
- A 16 in diam white fir bears S14°E 27.8 feet marked X BT

B.L.M. DESCRIPTION: The NE 1/16 sec. cor. of sec. 27, established by Duane I. Griffith, Registered Land Surveyor No. 644, in 1982, and filed with the Baker County Surveyor under survey No. 6-45-31, and is accepted as the corner; monumented with an aluminum post, 2½ ins. diam., firmly set, projecting 2 ins. above ground, and in a mound of stone, 2 ½ ft. base to top, with aluminum cap mkd. (diagram shown) from which bearing trees mkd. by Griffith

- A fir, 26 ins. diam., bears S. 61½° E., 33 lks. dist., with fragmentary scribe marks on partially healed blaze.
- A fir, 25 ins. diam., bears S. 16 ½° E., 42 lks. dist., with healed double blaze.

EVIDENCE FOUND: Found a 2½" aluminum pipe with 2½" aluminum cap attached (marked as shown below), projecting 2" above ground in a 2.5 ft. mound of stone.

CORNER MONUMENT MARKED:

From which, **THE BEARING TREES BY GRIFFITH:**

- ▶ A white fir snag, 26" dbh bears S.61°30'E., 21.8 ft., with healed double blaze
- ▶ A white fir, 29" dbh bears S.16°30'E., 27.7 ft., with healed double blaze

Also from which, **I SET A NEW REFERENCE POINT:**

- ▶ A 1½" magnetic nail driven in a fissure in a boulder, bears N.15°25'W., 15.39 ft., with attached 1½" aluminum washer marked *PLS 69454*

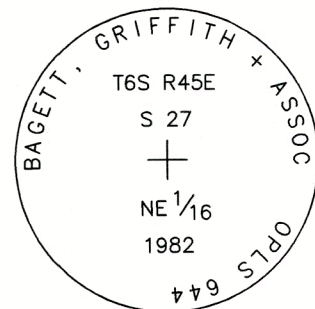

Painted a 6 inch red band around the bearing trees, and also painted blazes red. Record bearings and distances to BT's were confirmed using a magnetic compass with 14° East declination and a handheld EDM device. Used RTK GPS to measure the RP. Bearings are geodetic, derived by GPS observation at the corner. Also set an aluminum guard post N.85°W., 4.3 ft. from the monument, with USFS 54-2 and 54-9 signs attached, and the existing steel T-post was re-set South, 6.10 ft. with USFS 54-2 sign attached.

RESTORATION BY, STAMP AND DATE:

Work Performed October 3, 2022 by:

Jason L. Hatfield, PLS
Doug H. Crawford

USDA FOREST SERVICE
NORTHEAST OREGON LAND ZONE
1550 Dewey Avenue, Suite A
Baker City, OR 97814
(541) 523-1283

FILED December 14, 2022
BAKER COUNTY SURVEYOR
SURVEY NO. 6-45-174

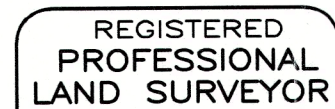

Jason L. Hatfield



EXPIRES: 6/30/2023