



Land Surveying & Boundary Consulting

32610 Mountain Lakes Drive
Klamath Falls, OR 97601
(541) 356-2381

**CERTIFIED RECORD OF LAND
CORNER MONUMENTATION**

45° 03' 05.861" N
117° 11' 00.875" W
+/- 5 Meters.
NAD 83

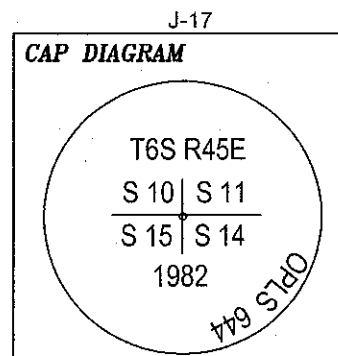

Description of corner evidence found:

Monument Found:

A 2 1/2 in. aluminum pipe with a 2 1/2 in. aluminum cap showing 6 ins. above the ground and firmly set. A rock mound 30 ins. base to top surrounds the cap.

Accessories Found:

A subalpine fir, 29 ins. diam., bears N 11° E 80.5 ft. with a mostly healed single blaze. A small amount of scribing is visible. The tree is alive and healthy. (Griffith)

A dead subalpine fir, 29 ins. diam., bears S 48° E 89.8 ft. with a chopped open double blaze and scribing visible. (Record S 45° E) (Original)

A dead subalpine fir, 21 ins. diam., bears S 49° E 78.9 ft. with a partially healed double blaze. (Griffith) (Record S 44° E 79.5 ft.)

A subalpine fir, 20 ins. diam., bears S 33° W 65.9 ft. with a partially healed double blaze and some scribing visible. (Griffith) (Record 66.3 ft.) This tree is alive and healthy.

A subalpine fir, 26 ins. diam., bears N 29° W 121.5 ft. with a partially healed double blaze. This tree is alive and healthy. (Griffith)

Description of monument and accessories established to perpetuate corner:

Monument Set:

None

Accessories Set:

A 5/8 x 30 in. rebar with 2 in. aluminum cap set 23 ins. in the ground bears N 47° E 6.6 ft.

A 5/8 x 30 in. rebar with 2 in. aluminum cap set 24 ins. in the ground bears S 38° E 6.75 ft.

A 5/8 x 30 in. rebar with 2 in. aluminum cap set 24 ins. in the ground bears S 51° W 7.0 ft.

A 5/8 x 30 in. rebar with 2 in. aluminum cap set 25 ins. in the ground bears N 35° W 6.5 ft.

An aluminum post with land survey monument sign bears N 11° E 5.0 ft.

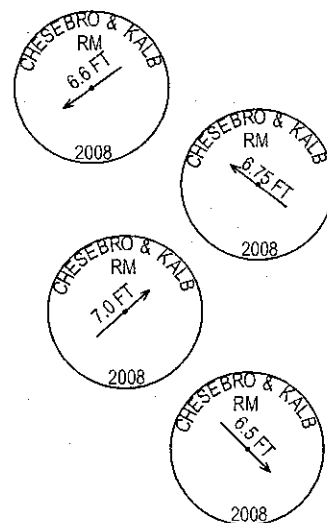

Equipment: Warren Knight staff compass with tripod, Var. 15 1/2° E, Keson tape, clinometer, loggers tape

Crew: Richard Chesebro & Ron Grace

Date: August 11, 2008

Office of.....County...Surveyor..... County of.....Baker.....
 State of.....Oregon....., I hereby certify that the within was filed
 in this office for record on the..... day of....., 20.....
 by
 (COUNTY OFFICIAL) (DEPUTY)

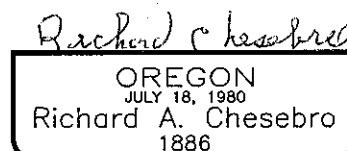
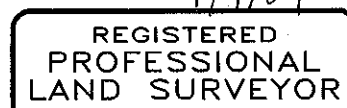

Renews: 12-31-2009

FILED Jan. 14, 2009
 BAKER COUNTY SURVEYOR
 SURVEY NO. 6-45-152