

CERTIFIED RECORD OF LAND CORNER MONUMENTATION

History of original corner establishment:  
Corner not previously established

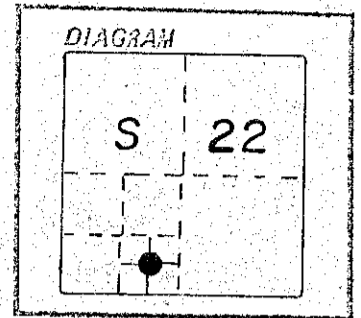

Description of corner evidence found:

NONE

Description of monument and accessories I established to perpetuate the original location of this corner:

At corner position I set a 2 1/2"x30" aluminum pipe with aluminum cap marked as shown 26 inches in the ground from which:

- NBW BTs
- A 4x4x4 ft. boulder marked + 80 on top bears S47°E, 28.2 feet
- A 36 in diam red fir bears N38°W 159.5 feet marked SESW 1/64 S22 BT

Raised mound of stone around monument

Set steel fence post approximately 5 feet Southerly with 54-2 sign and approximately 5 feet Easterly with 54-2 and 54-9 sign  
Corner set October 6, 1982  
Witness: Rick Robinson

See survey dated December, 1982

I hereby certify this corner was re-established as hereon described on the data written above

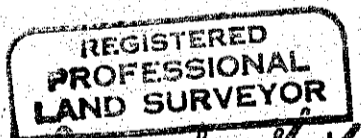
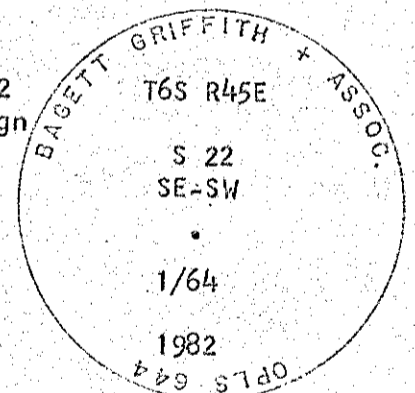

*Duane I. Griffith*

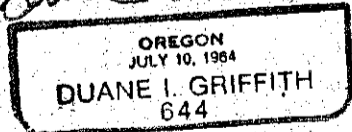

I used a steel tape and magnetic compass in the establishment of accessories. I used 20° East magnetic declination, and distances to the new BTs are to the center of the tree. I placed a brass washer marked OPLS 644 by the BT blaze of new BTs.

Office of..... County of.....  
State of....., I hereby certify that the within instrument was filed in this office for record on the..... day of....., 19.....  
..... by .....  
(COUNTY OFFICIAL) (DEPUTY)