

CERTIFIED RECORD OF LAND CORNER MONUMENTATION

History of original corner establishment:

NONE-corner established this survey.

W-10

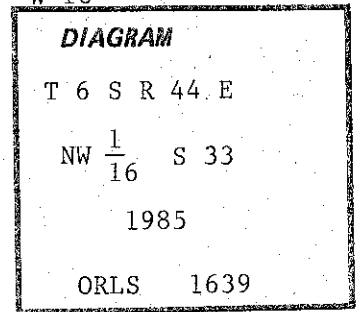

Description of corner evidence found:

None.

Description of monument and accessories established to perpetuate the original location of this corner:

Set 2½" aluminum cap on 2" aluminum pipe 30" long 25" in ground with 5" proj out of ground with surrounding rock mound and 6' steel fence post alongside with sign 54-9 attached.

Aluminum cap marked as shown in corner diagram.

New bearing trees established:

A fir 14 ins dia brs N66°E, 135.1 ft dist mkd NW1/16S33 BT.

A fir 8 ins dia brs S45°E, 39.9 ft dist mkd NW1/16S33 BT.

Each new bearing tree has signs 54-3 and 54-9 attached below a 6" band of red paint and a brass washer marked PLS 1639 nailed flush with BT blaze.

I hereby certify that the above corner monument was properly maintained to U.S.F.S. standards under my supervision and witnessed by Jim DeMastus and Daryl Schuchardt on July 15, 1985.

Witnessed : Jim DeMastus

**REGISTERED  
PROFESSIONAL  
LAND SURVEYOR**

*William L. Hanley*

**OREGON  
JULY 14, 1978  
WILLIAM L. HANLEY  
1639**

Office of County Surveyor..... County of Baker  
State of Oregon....., I hereby certify that the within instrument was filed in this office  
for record on the..... day of....., 19.....

..... by .....  
(COUNTY OFFICIAL) (DEPUTY)

FILED 4-28-86  
BAKER COUNTY SURVEYOR  
SURVEY NO. 6-44-52