

CERTIFIED RECORD OF LAND CORNER MONUMENTATION

T-10

History of original corner establishment:

None, corner established this survey.

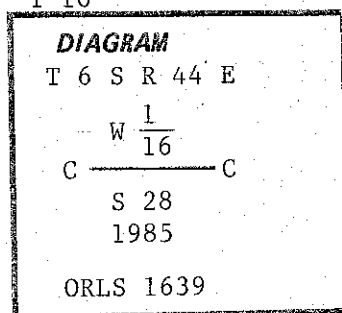

Description of corner evidence found:

None.

Description of monument and accessories established to perpetuate the original location of this corner:

Set a 2½" aluminum cap on 2" aluminum pipe 31" long buried 27" in ground with 4" proj. from ground with surrounding rock mound and 6' steel fence post alongside with sign 54-9 attached.

Aluminum cap marked as shown in corner diagram.

New bearing trees established:

A pine 7 ins dia bears N07½° E, 122.1 ft dist marked CW1/16S28 BT.

A pine 9 ins dia bears N34° E, 114.5 ft dist marked CW1/16S28 BT.

Each new bearing tree has a brass washer marked PLS 1639 nailed flush with BT blaze and has signs 54-3 and 54-9 attached below a 6 inch band of red paint.

I hereby certify that the above corner monument was properly established by me to U.S.F.S. standards on July 26, 1985.

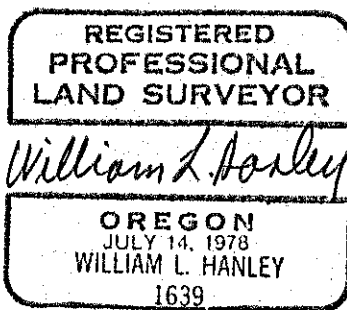

Office of.....County Surveyor..... County of..... Baker
State of..... Oregon....., I hereby certify that the within instrument was filed in this office
for record on the..... day of....., 19.....

..... by
(COUNTY OFFICIAL) (DEPUTY)

FILED 4-28-86
BAKER COUNTY SURVEYOR
SURVEY NO. 6-44-39