

CERTIFIED RECORD OF LAND CORNER MONUMENTATION

N-3

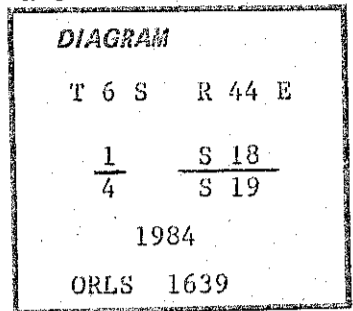

History of original corner establishment:

Corner established by W.B. Barr under GLO contract No. 503 dated May 23, 1884.

Surveyor General records state:

Set a basalt rock 16 x 10 x 8, 11 ins in ground for $\frac{1}{4}$ sec cor marked $\frac{1}{4}$ on the N side from which

A fir 15 ins dia bears N62°W, 100 lks dist marked $\frac{1}{4}$ S BT.

A fir 15 ins dia bears S12°W, 127 lks dist marked $\frac{1}{4}$ S BT.

Description of corner evidence found:

No trace of corner stone.

A down alpine fir log 20 ins dia for section 18 bearing tree at 100 lks, bears N62°W.

A live alpine fir 22 ins dia for section 19 bearing tree at 127 lks, bears S12°W.

Description of monument and accessories established to perpetuate the original location of this corner:

Set a 2½" aluminum cap on 2" aluminum pipe 30" long 25" in ground with 5" proj. out of ground with surrounding rock mound and 6' steel fence post alongside with sign 54-9 attached.

Aluminum cap marked as shown in corner diagram.

New bearing tree established:

A fir 8 ins dia bears N13°E, 121.3 ft dist marked $\frac{1}{4}$ S18 BT.

Each original bearing tree and each new bearing tree has signs 54-3 and 54-9 attached below a 6 in band of red paint, additionally each new bearing tree has a brass washer marked PLS 1639 nailed flush with BT blaze.

I hereby certify that the above described corner monument was properly established by me and witnessed by Jim DeMastus and Daryl Schuchardt on Sept. 24, 1984.

Witnessed: Jim DeMastus

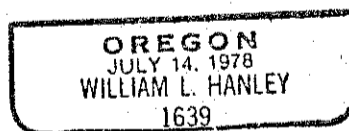
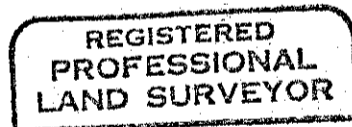

Office of..... County Surveyor..... County of..... Baker
Oregon
State of....., I hereby certify that the within instrument was filed in this office
for record on the..... day of....., 19.....
..... by
(COUNTY OFFICIAL) (DEPUTY)

FILED 4-28-86
BAKER COUNTY SURVEYOR
SURVEY NO. 6-44-16